

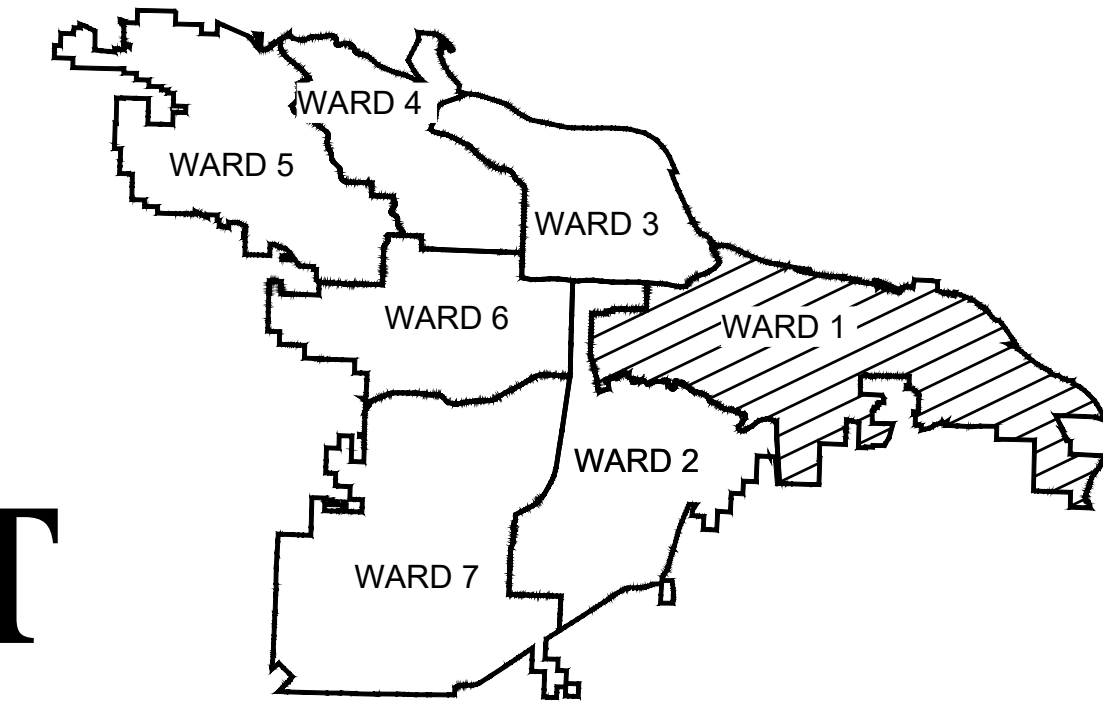

054616.003

ROCK STREET & 6TH STREET, ROCK STREET & CAPITOL STREET INTERSECTION IMPROVEMENTS

60% SUBMITTAL



PROJECT LOCATION - WARD 1



N.T.S.

Sheet List Table	
Sheet Number	Sheet Title
C1	COVER SHEET
C2	GENERAL NOTES
C3	ROCK ST. & 6TH ST. SITE PLAN
C4	ROCK ST. & 6TH ST. GRADING PLAN
C5	ROCK ST. & E. CAPITOL AVE. SITE PLAN
C6	ROCK ST. & E. CAPITOL AVE. GRADING PLAN

REVISIONS	DATE

CITY OF LITTLE ROCK, ARKANSAS
 ROCK, 6TH ST & CAPITOL INTERSECTION IMPROVEMENTS
 COVER SHEET

DEPARTMENT OF PUBLIC WORKS
 CIVIL ENGINEERING
 701 W. MARKHAM
 LITTLE ROCK, ARKANSAS 72201

PRELIMINARY
 FOR INTERIM REVIEW ONLY
THESE DOCUMENTS ARE FOR INTERIM REVIEW AND NOT INTENDED FOR REGULATORY APPROVAL, PERMIT, BIDDING OR CONSTRUCTION PURPOSES. THEY WERE PREPARED BY OR UNDER THE SUPERVISION OF:
 BRIAN L. VINES 0418
NAME PE LICENSE NO.
 12/17/2024
DATE
 1470 AR
FORM / BUSINESS NO. STATE

DEPARTMENT OF PUBLIC WORKS
 CIVIL ENGINEERING
 701 WEST MARKHAM STREET
 LITTLE ROCK, ARKANSAS 72201

 10800 Financial Centre Pkwy, Suite 500
 Little Rock, Arkansas 72211
 Main (501) 801-2679

DRAWN BY
 DR
DESIGNED
 JM
CHECKED
 JM
DATE
 NOVEMBER 2024
SCALE
 NO SCALE
PROJECT NO.
 054616.003
SHEET NO.
C1



REVISIONS	DATE

CITY OF LITTLE ROCK, ARKANSAS
ROCK, 6TH ST & CAPITOL INTERSECTION IMPROVEMENTS
GENERAL NOTES

DEPARTMENT OF PUBLIC WORKS
CIVIL ENGINEERING
701 W. MARKHAM
LITTLE ROCK, ARKANSAS 72201

PRELIMINARY
 FOR INTERIM REVIEW ONLY
THESE DOCUMENTS ARE FOR INTERIM REVIEW AND NOT INTENDED FOR REGULATORY APPROVAL. PERMIT, BIDDING OR CONSTRUCTION PURPOSES. THEY WERE PREPARED BY OR UNDER THE SUPERVISION OF:
 BRIAN L. WINES 0418
NAME PE LICENSE NO.
 12/17/2024
DATE
 1470 AR
FIRM / BUSINESS NO. STATE

DRAWN BY
DR
DESIGNED
JM
CHECKED
JM
DATE
NOVEMBER 2024
SCALE
NO SCALE
PROJECT NO.
054616.003
SHEET NO.
C2

EXISTING LEGEND PROPOSED

IRON ROD	○ IR	PROPOSED CONTOUR	
PK NAIL	○ PK	PROPOSED SPOT ELEVATION	
R.R. SPIKE	○ RR(Sp)	PROPOSED SPOT CURB ELEVATION	
CONC. MONUMENT	□ CM	STORM SEWER - PIPE	
WATER VALVE	⊗ WV	STORM SEWER - MITERED END SECTION	
WATER METER	□ WM	STORM SEWER - GRATE INLET	
FIRE HYDRANT	⊕ FH	STORM SEWER - JUNCTION BOX	
GAS METER	⊕ GM	STORM SEWER - FLARED END SECTION	
GAS VALVE	⊕ GV	STORM SEWER - HEADWALL	
CLEAN-OUT	○ CO	STORM SEWER - SINGLE WING	
GUARD POST (BOLLARD)	● GP	STORM SEWER - DOUBLE WING	
SIGN POST	⊕	STORM SEWER - AREA INLET	
BENCHMARK	⊕	GRADE BREAK LINE	
STORM SEWER MANHOLE	⊕	HIGH POINT	
SANITARY SEWER MANHOLE	⊕	LOW POINT	
TELEPHONE MANHOLE	⊕	CUT LINE	
ELECTRIC MANHOLE	⊕	FILL LINE	
TELEPHONE BOX	⊕	SANITARY SEWER PIPE	
ELECTRIC BOX	⊕	SANITARY SEWER MANHOLE	
CABLE BOX	⊕	PROPOSED CURB	
UTILITY POLE	⊕	PROPOSED CONCRETE	
GUY WIRE	⊕	CONSTRUCTION - ENTRANCE/EXIT	
LIGHT POLE	⊕	CHECK DAM	
POST OR POLE (TYPE AS NOTED)	⊕	DIVERSION BERM	
MAILBOX	⊕	DOWNDRAIN STRUCTURE - TEMPORARY	
DECIDUOUS TREE		ROCK DAM	
EVERGREEN/CONIFEROUS TREE		SEDIMENT BARRIER - SILT FENCE	
BUSH		SEDIMENT BARRIER - GRAVEL RING	
PROPERTY LINE	— — — — —	SEDIMENT BARRIER - BLOCK & GRAVEL	
SETBACK LINE	— — — — —	SEDIMENT BARRIER - BLOCK	
EASEMENT LINE	— — — — —	TEMPORARY SEDIMENT BASIN	
CURB	— — — — —	SILT FENCE - TYPE A	
FENCE	— X — X — X —	SILT FENCE - TYPE B	
OVERHEAD ELECTRIC	— OE — OE —	SILT FENCE - TYPE C	
OVERHEAD TELEPHONE	— OT — OT —	STORM DRAIN OUTLET PROTECTION	
OVERHEAD CABLE	— OC — OC —	SURFACE ROUGHENING	
UNDERGROUND TELEPHONE	— UOT —	DISTURBED AREA STABILIZATION - TEMPORARY STABILIZATION	
UNDERGROUND ELECTRIC	— UGE —	DISTURBED AREA STABILIZATION - TEMPORARY GRASSING	
UNDERGROUND CABLE	— UGC —	DISTURBED AREA STABILIZATION - PERMANENT GRASSING	
WATER LINE	— 8"W —	MATTING/BLANKETS	
SEWER LINE	— 8"SS —		
GAS LINE	— 4"G —		
STORM SEWER/CULVERT			
EDGE OF WOODS			
CONTOUR LINE			

QUANTITIES

Item #	Description	Unit	Quan.
2.01	SITE PREPARATION	LS	1
3.01	UNCLASSIFIED EXCAVATION	CY	196
3.40	TOPSOIL WITH SOD	SY	28
4.01	AGGREGATE BASE COURSE	TON	117
5.01	TACK COAT	GAL	1
5.02	PRIME COAT	GAL	3
6.01	ACHM SURFACE COURSE(2")	TON	7
8.03	CONCRETE CURB AND GUTTER (CLASS 3)	LF	536
9.00	TRENCH AND GRATE	LF	93
9.04	CONCRETE SIDEWALK (4")	SF	1165
10.04	CURB INLET - 4' BOX	EA	1
10.80	REBUILD JUNCTION BOX TOP	EA	1
13.61	TIE INTO EXISTING JUNCTION BOX	EA	1
13.62	TIE INTO EXISTING CONCRETE PIPE	EA	1
16.01	MAINTENANCE OF TRAFFIC	LS	1
18.50	ACCESS RAMP	SF	656
19.01	FINAL CLEANUP	LS	1
24.00	RAIN GARDEN	SY	32
24.23	EROSION CONTROL	LS	1
28.00	K71 BOLLARD	EA	12
30.02	RELOCATE EXISTING SIGN (PART OF SITE PREP)	EA	3
719.12W	THERMOPLASTIC PAVEMENT MARKING WHITE(12")	LF	368

REVISIONS	DATE

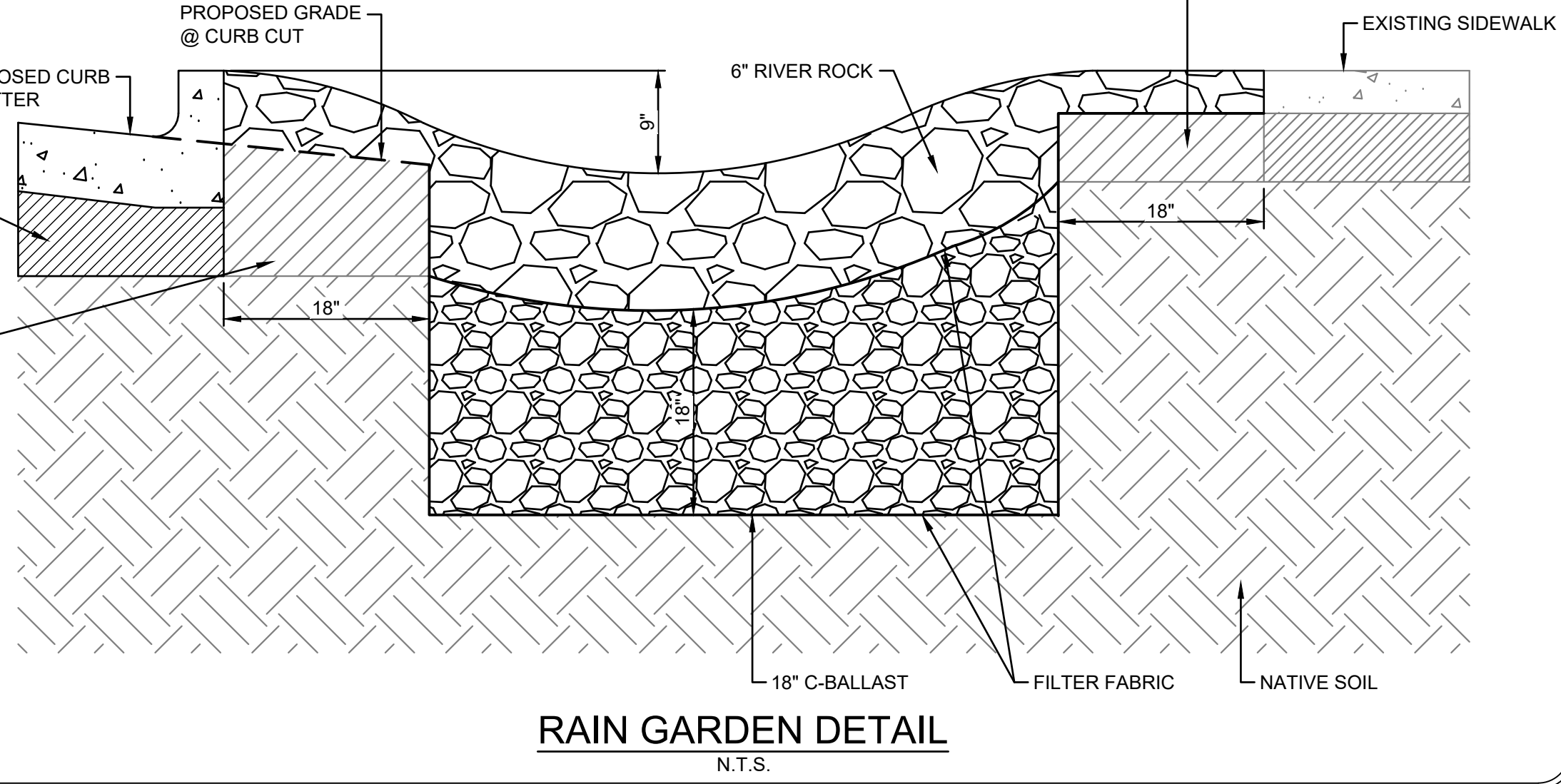
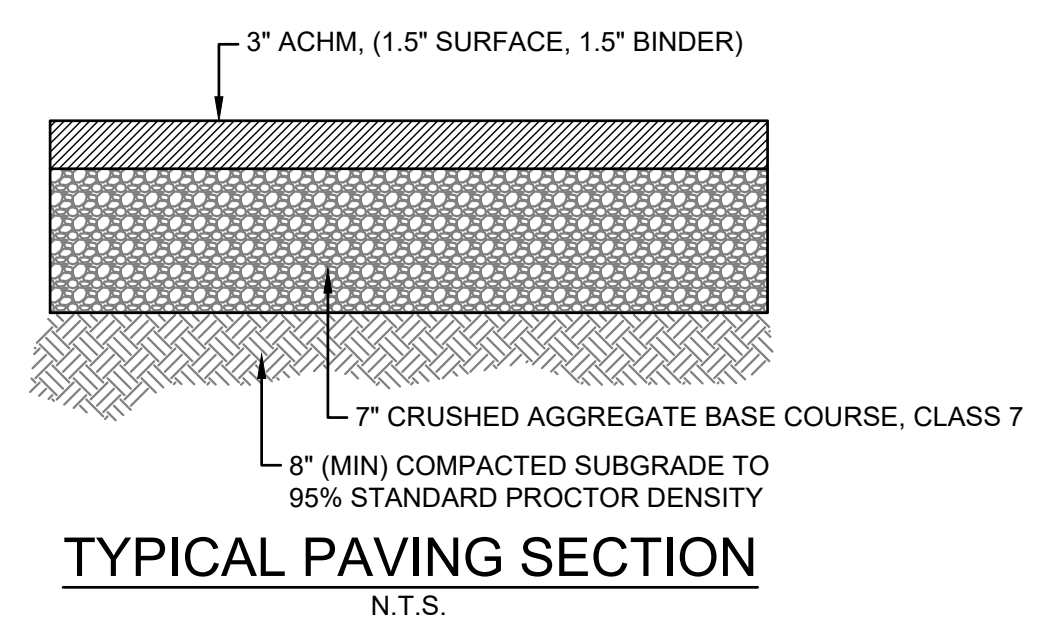
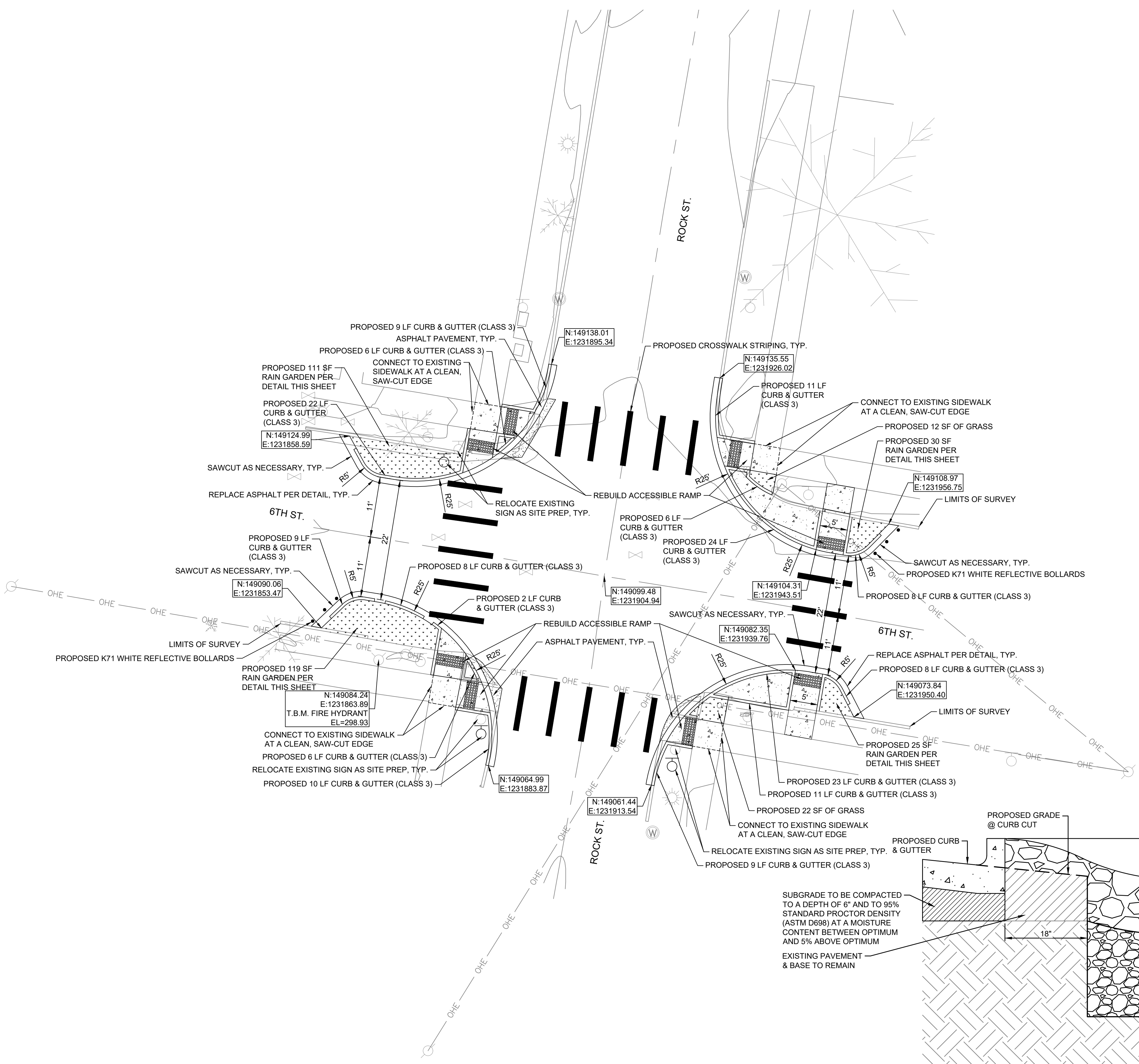
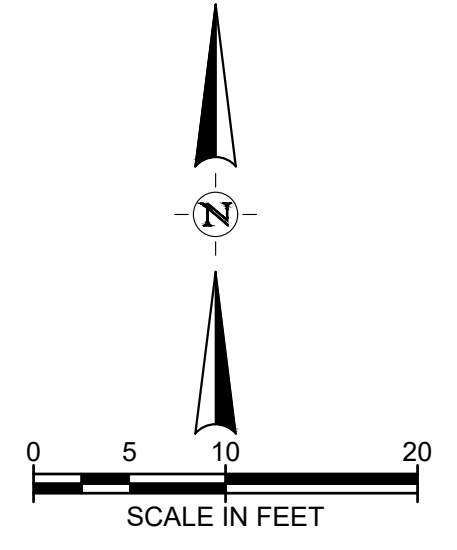

CITY OF LITTLE ROCK, ARKANSAS
ROCK, 6TH ST & CAPITOL INTERSECTION IMPROVEMENTS

DEPARTMENT OF PUBLIC WORKS
 CIVIL ENGINEERING
 701 W. MARKHAM
 LITTLE ROCK, ARKANSAS 72201

PRELIMINARY
 FOR INTERIM REVIEW ONLY
 THESE DOCUMENTS ARE FOR INTERIM REVIEW AND NOT INTENDED FOR REGULATORY APPROVAL. PERMIT BIDDING OR CONSTRUCTION PURPOSES. THEY WERE PREPARED BY OR UNDER THE SUPERVISION OF:
 BRIAN L. VINES 0418
 NAME: PE LICENSE NO.
 12/12/2024
 DATE
 1470 AR
 FIRM / BUSINESS NO. STATE

DRAWN BY
 DR
DESIGNED
 JM
CHECKED
 JM
DATE
 NOVEMBER 2024
SCALE
 1"=10'
PROJECT NO.
 054616.003
SHEET NO.
 C3

ROCK ST. & 6TH ST.
 SITE PLAN

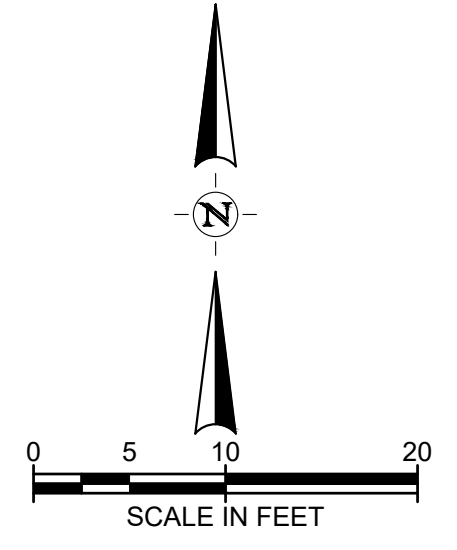

REVISIONS	DATE

CITY OF LITTLE ROCK, ARKANSAS
ROCK, 6TH ST & CAPITOL INTERSECTION IMPROVEMENTS

ROCK ST. & 6TH ST.
 GRADING PLAN

DEPARTMENT OF PUBLIC WORKS
 CIVIL ENGINEERING
 701 W. MARKHAM
 LITTLE ROCK, ARKANSAS 72201

PRELIMINARY
 FOR INTERIM REVIEW ONLY
 THESE DOCUMENTS ARE FOR INTERIM REVIEW AND NOT INTENDED FOR REGULATORY APPROVAL, PERMIT, BIDDING OR CONSTRUCTION PURPOSES. THEY WERE PREPARED BY OR UNDER THE SUPERVISION OF:

BRIAN L. VINES 8418
 NAME PE LICENSE NO.
 12/17/2024
 DATE
 1470 AR
 FIRM / BUSINESS NO. STATE

DRAWN BY
 DR
DESIGNED
 JM
CHECKED
 JM
DATE
 NOVEMBER 2024
SCALE
 1"=10'
PROJECT NO.
 054616.003
SHEET NO.
 C4

REVISIONS	DATE

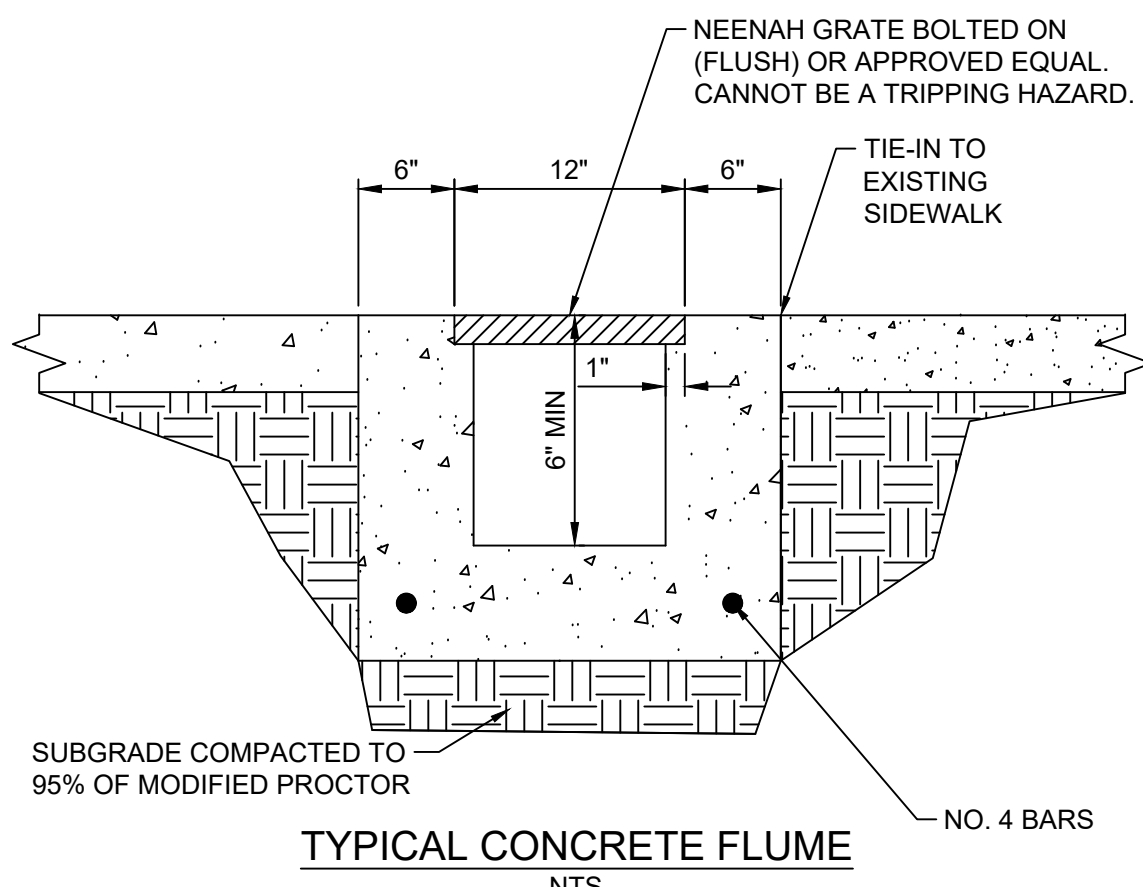
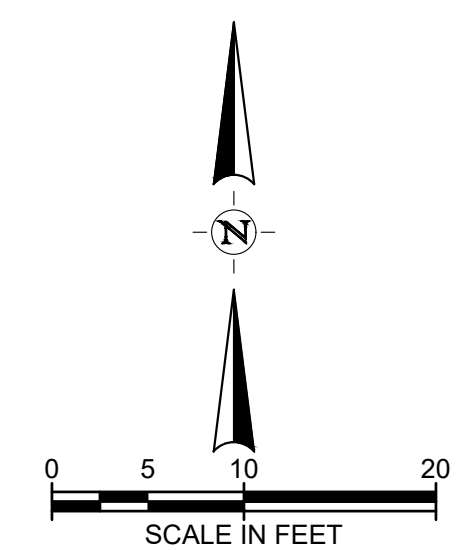
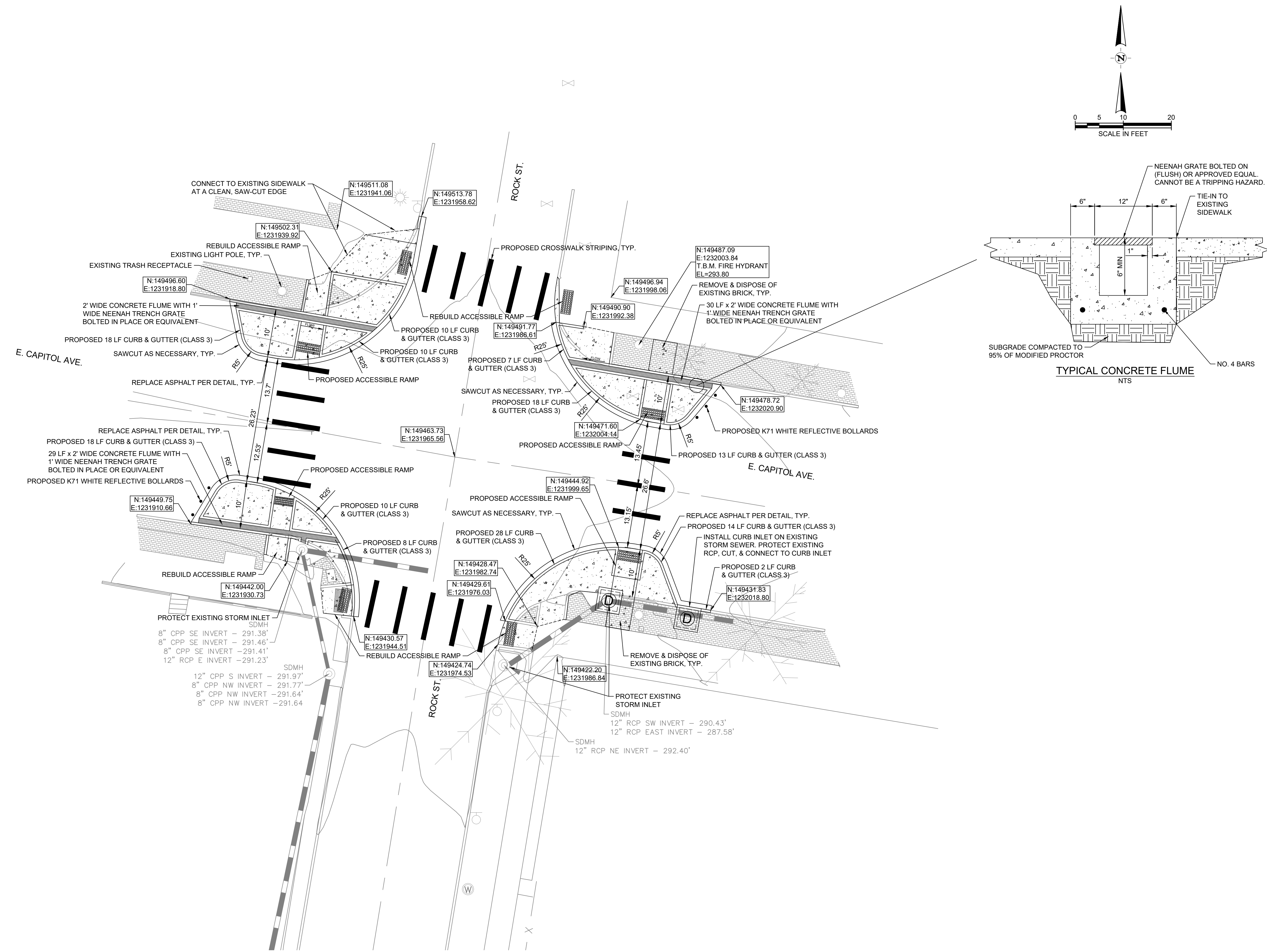

CITY OF LITTLE ROCK, ARKANSAS
ROCK, 6TH ST & CAPITOL INTERSECTION IMPROVEMENTS
 ROCK ST. & E. CAPITOL AVE. SITE PLAN

DEPARTMENT OF PUBLIC WORKS
CIVIL ENGINEERING
 701 W. MARKHAM
 LITTLE ROCK, ARKANSAS 72201

PRELIMINARY
 FOR INTERIM REVIEW ONLY
 THESE DOCUMENTS ARE FOR INTERIM REVIEW AND NOT INTENDED FOR REGULATORY APPROVAL, PERMIT, BIDDING OR CONSTRUCTION PURPOSES. THEY WERE PREPARED BY OR UNDER THE SUPERVISION OF:
 BRIAN L. VINES 0418 PE LICENSE NO.
 12/17/2024
 DATE
 1470 AR
 FIRM / BUSINESS NO. STATE

DRAWN BY
 DR
DESIGNED
 JM
CHECKED
 JM
DATE
 NOVEMBER 2024
SCALE
 1"=10'
PROJECT NO.
 054616.003
SHEET NO.
C5

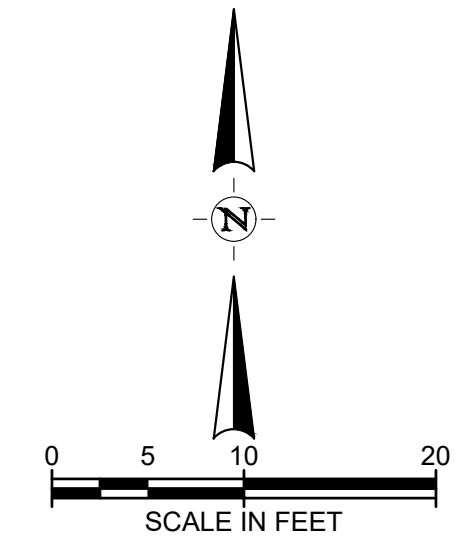
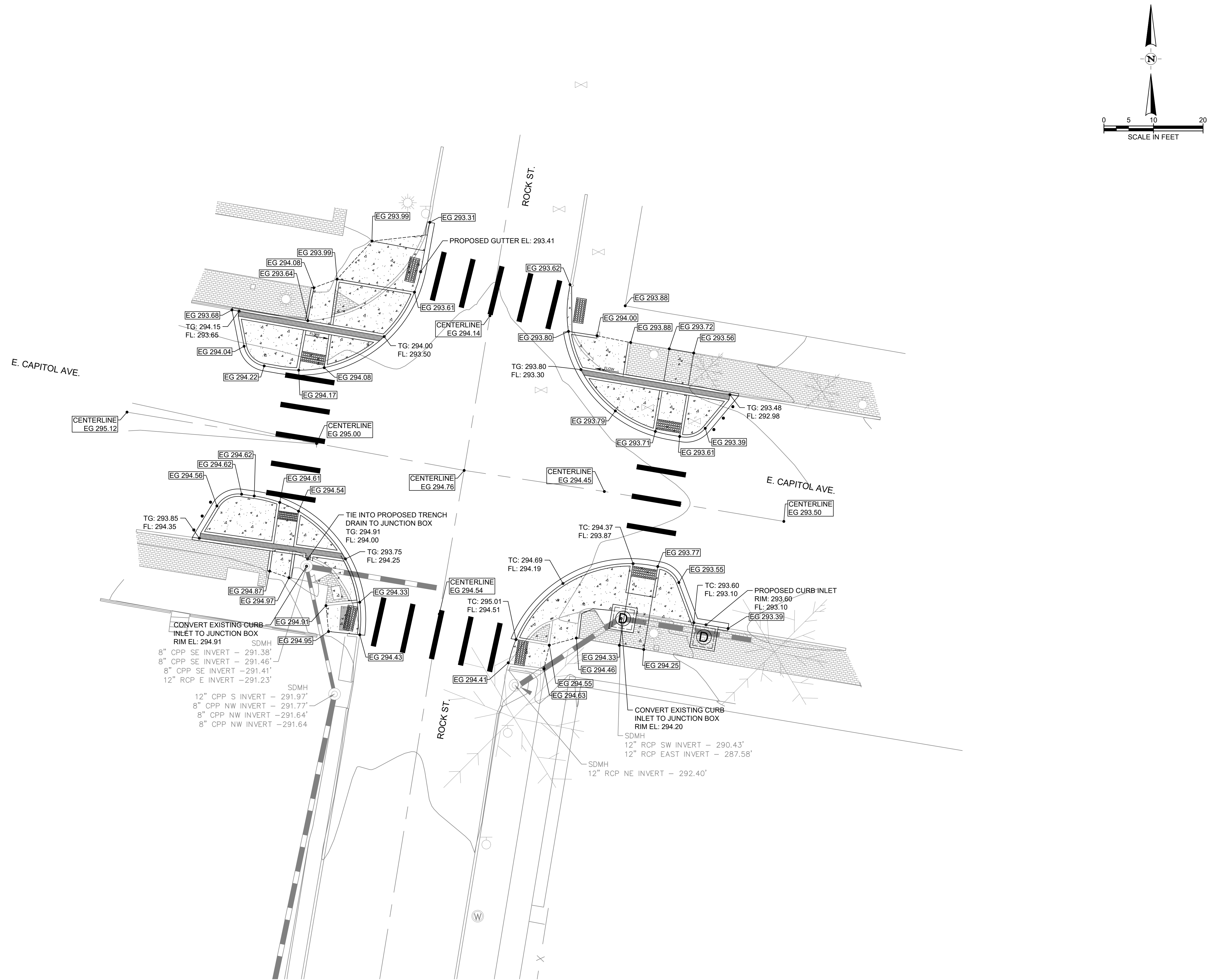

REVISIONS	DATE

CITY OF LITTLE ROCK, ARKANSAS
ROCK, 6TH ST & CAPITOL INTERSECTION IMPROVEMENTS
 ROCK ST. & E. CAPITOL AVE. GRADING PLAN

DEPARTMENT OF PUBLIC WORKS
CIVIL ENGINEERING
 701 W. MARKHAM
 LITTLE ROCK, ARKANSAS 72201

PRELIMINARY
 FOR INTERIM REVIEW ONLY
 THESE DOCUMENTS ARE FOR INTERIM REVIEW AND NOT INTENDED FOR REGULATORY APPROVAL, PERMIT, BIDDING OR CONSTRUCTION PURPOSES. THEY WERE PREPARED BY OR UNDER THE SUPERVISION OF:
 BRIAN L. VINES 0418
 NAME PE LICENSE NO.
 12/17/2024
 DATE
 1470 AR
 FIRM / BUSINESS NO. STATE

DRAWN BY
DR
DESIGNED
JM
CHECKED
JM
DATE
NOVEMBER 2024
SCALE
1"=10'
PROJECT NO.
054616.003
SHEET NO.
C6