

CLR PROJECT # 05-22-DR-36 TAYLOR LOOP CREEK DRAINAGE

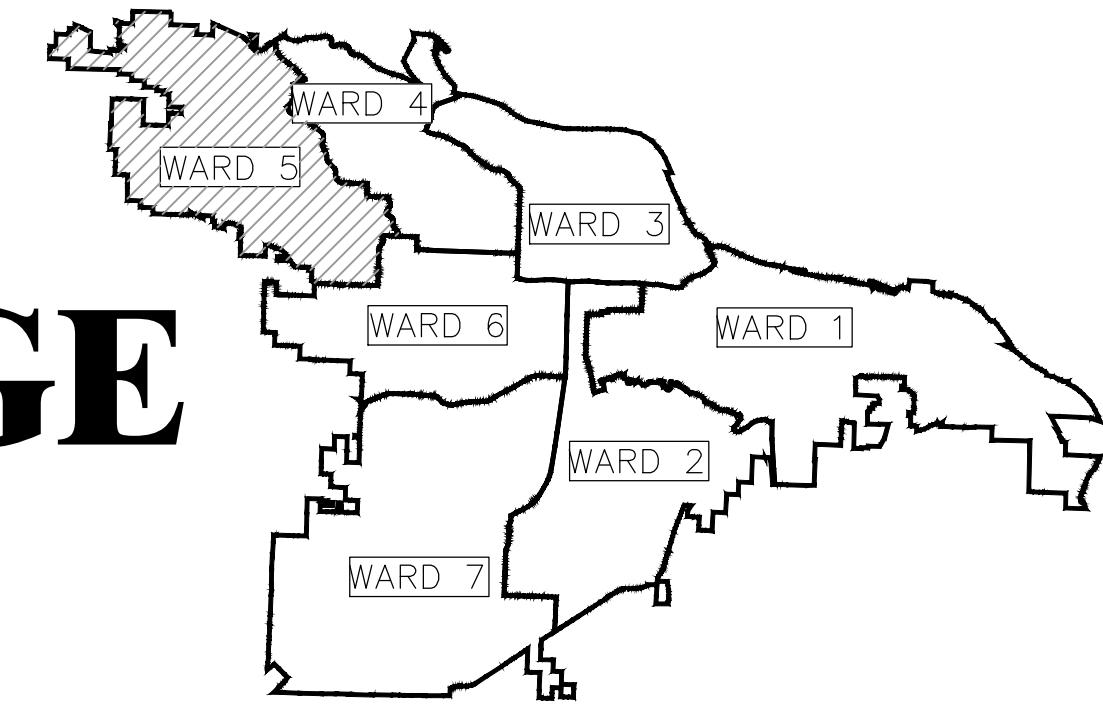

PROJECT LOCATION - WARD 5

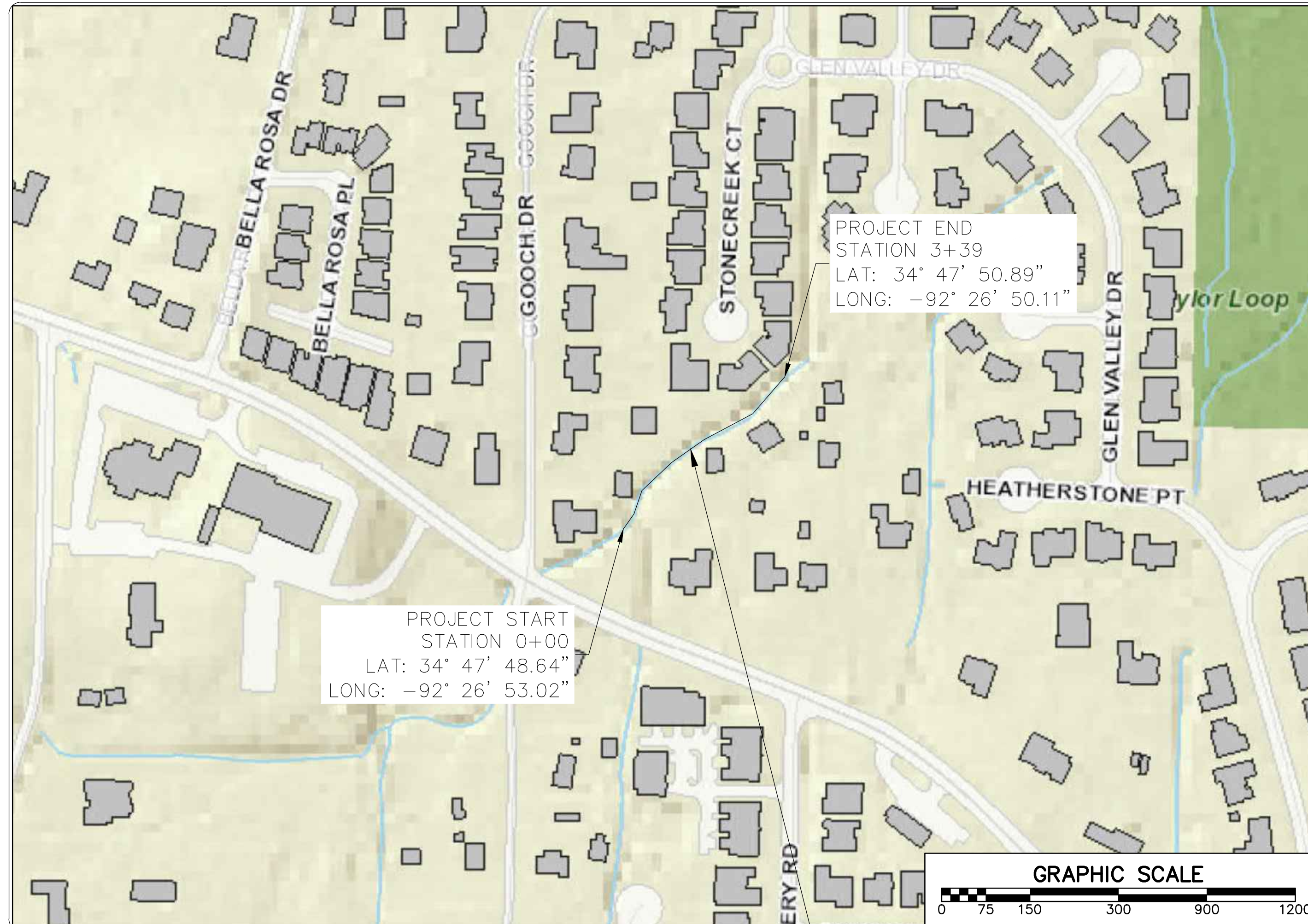
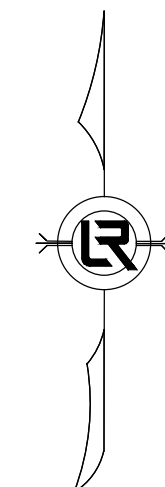

PROJECT LOCATION

SHEET #	INDEX OF DRAWINGS
C1	COVER SHEET
C2	GENERAL NOTES AND QUANTITIES
C3	EXISTING SITE OVERVIEW
C4	EROSION CONTROL PLAN
C5	PROJECT SITE OVERVIEW
C6	PLAN AND PROFILE SHEET
C7	CROSS-SECTION PROFILE SHEET
C8	CONCRETE CHANNEL SECTIONS
C9	PROJECT DETAILS I
C10	PROJECT DETAILS II

100% DESIGN SUBMITTAL



BOND PROGRAM

DEPARTMENT OF PUBLIC WORKS
CIVIL ENGINEERING
701 WEST MARKHAM STREET
LITTLE ROCK, ARKANSAS 72201

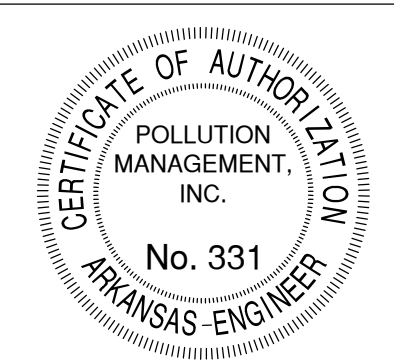

3512 S. SHACKLEFORD RD.
LITTLE ROCK, AR 72205

REVISIONS	DATE

CITY OF LITTLE ROCK, ARKANSAS
TAYLOR LOOP CREEK DRAINAGE
COVER SHEET

DEPARTMENT OF PUBLIC WORKS
CIVIL ENGINEERING
701 W. MARKHAM
LITTLE ROCK, ARKANSAS 72201

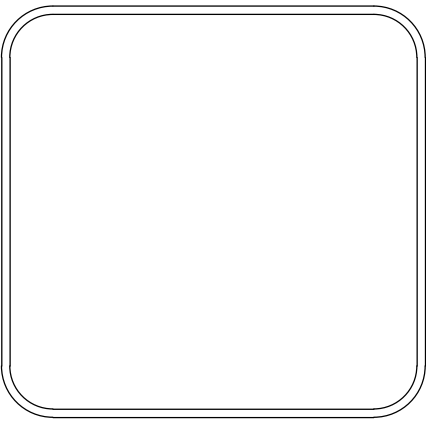

DRAWN BY	CTG
DESIGNED	CTG
CHECKED	BJW
DATE	01-20-25
SCALE	N.T.S.
PROJECT NO.	CLR 05-22-DR-36
SHEET NO.	C1

CLR PROJECT # 05-22-DR-36			
TAYLOR LOOP CREEK DRAINAGE			
ITEM #	ITEM DESCRIPTION	UNIT	QUANTITY
2.01	SITE PREPARATION	LS	1
3.01	UNCLASSIFIED EXCAVATION	CY	830
4.01	C-BALLAST - UNDER CONCRETE DITCH	TON	200
11.40	CONCRETE DITCH PAVING (6" Thick with 6" x 6" Welded Wire Mesh)	SF	5650
14.01	SOLID SODDING, BERMUDA	SY	300
18.40	HANDRAIL (SET IN CONCRETE)	LF	585
19.01	FINAL CLEAN UP	LS	1
24.12	SILT FENCE - TYPE B (SFB)	LF	660
26.10	TRENCH & EXCAVATION SAFETY	LS	1
30.00	RETAINING WALL SEGMENTED	SF	1750
SP	AS-BUILT (RECORD) DRAWINGS	LS	1

- NOTES:
- EXCAVATION FOR CONCRETE DITCH AND SEGMENTAL RETAINING WALL SHALL BE PAID FOR PER ITEM 3.01.

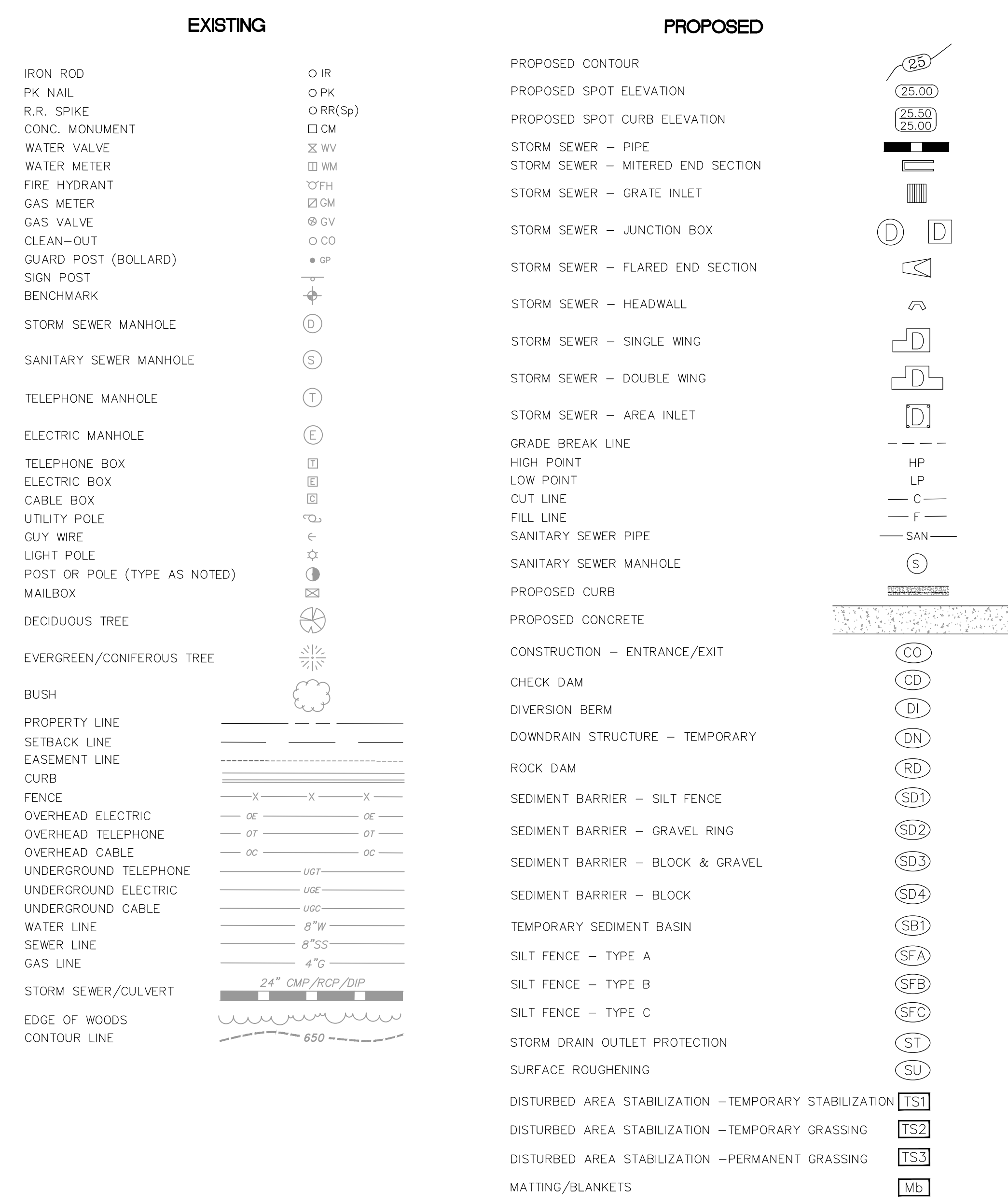

CITY OF LITTLE ROCK, ARKANSAS
 TAYLOR LOOP CREEK DRAINAGE
 GENERAL NOTES AND QUANTITIES

DEPARTMENT OF PUBLIC WORKS
 CIVIL ENGINEERING
 701 W. MARKHAM
 LITTLE ROCK, ARKANSAS 72201

DRAWN BY
CTG
 DESIGNED
CTG
 CHECKED
BJW
 DATE
01-20-25
 SCALE
N.T.S.
 PROJECT NO.
CLR 05-22-DR-36
 SHEET NO.
C2

REVISIONS DATE

CITY OF LITTLE ROCK, ARKANSAS
 TAYLOR LOOP CREEK DRAINAGE
 EXISTING SITE OVERVIEW

DEPARTMENT OF PUBLIC WORKS
 CIVIL ENGINEERING
 701 W. MARKHAM
 LITTLE ROCK, ARKANSAS 72201



DRAWN BY
 CTG
 DESIGNED
 CTG
 CHECKED
 BJW
 DATE
 01-20-25
 SCALE
 1" = 30'
 PROJECT NO.
 CLR 05-22-DR-36
 SHEET NO.
 C3

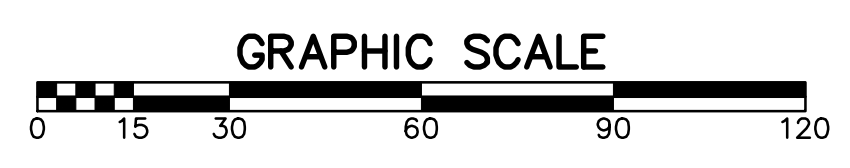
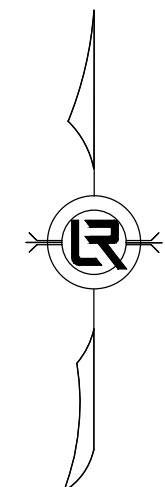
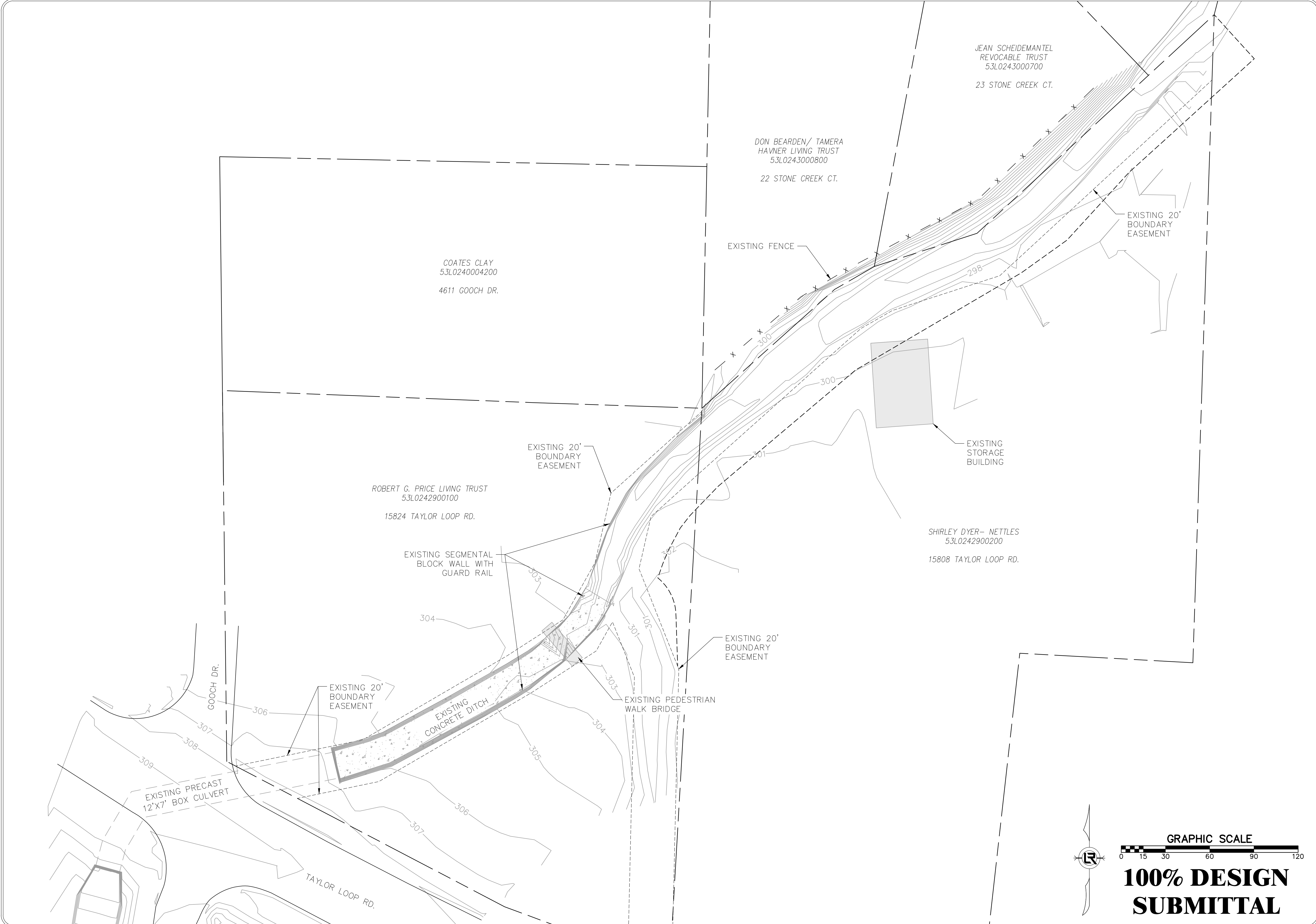

**100% DESIGN
 SUBMITTAL**

REVISIONS	DATE

CITY OF LITTLE ROCK, ARKANSAS
TAYLOR LOOP CREEK DRAINAGE
EROSION CONTROL PLAN

DEPARTMENT OF PUBLIC WORKS
CIVIL ENGINEERING
701 W. MARKHAM
LITTLE ROCK, ARKANSAS 72201



DRAWN BY
CTG
DESIGNED
CTG
CHECKED
BJW
DATE
01-20-25
SCALE
1" = 30'
PROJECT NO.
CLR 05-22-DR-36
SHEET NO.
C4

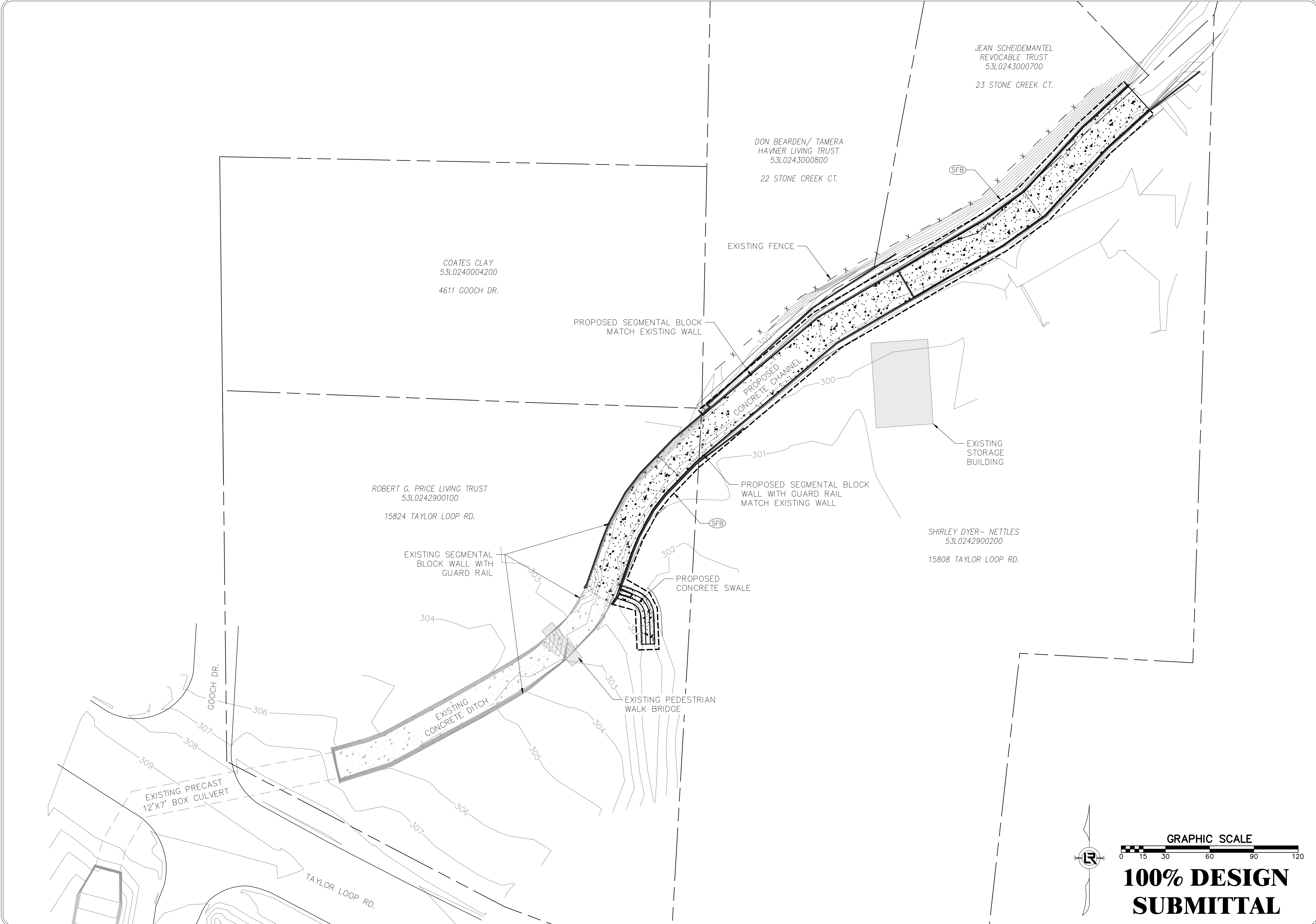

GRAPHIC SCALE
0 15 30 60 90 120

**100% DESIGN
SUBMITTAL**

REVISIONS	DATE

CITY OF LITTLE ROCK, ARKANSAS
TAYLOR LOOP CREEK DRAINAGE
PROJECT SITE OVERVIEW

DEPARTMENT OF PUBLIC WORKS
CIVIL ENGINEERING
701 W. MARKHAM
LITTLE ROCK, ARKANSAS 72201

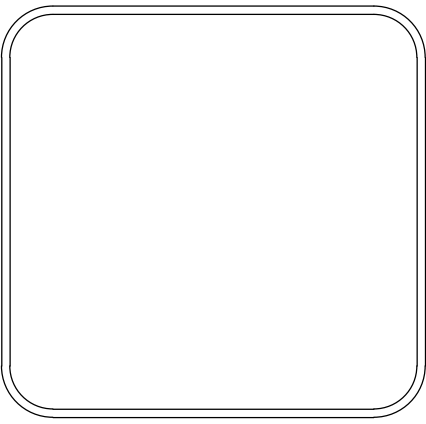

DRAWN BY
CTG
DESIGNED
CTG
CHECKED
BJW
DATE
01-20-25
SCALE
1" = 30'
PROJECT NO.
CLR 05-22-DR-36
SHEET NO.
C5

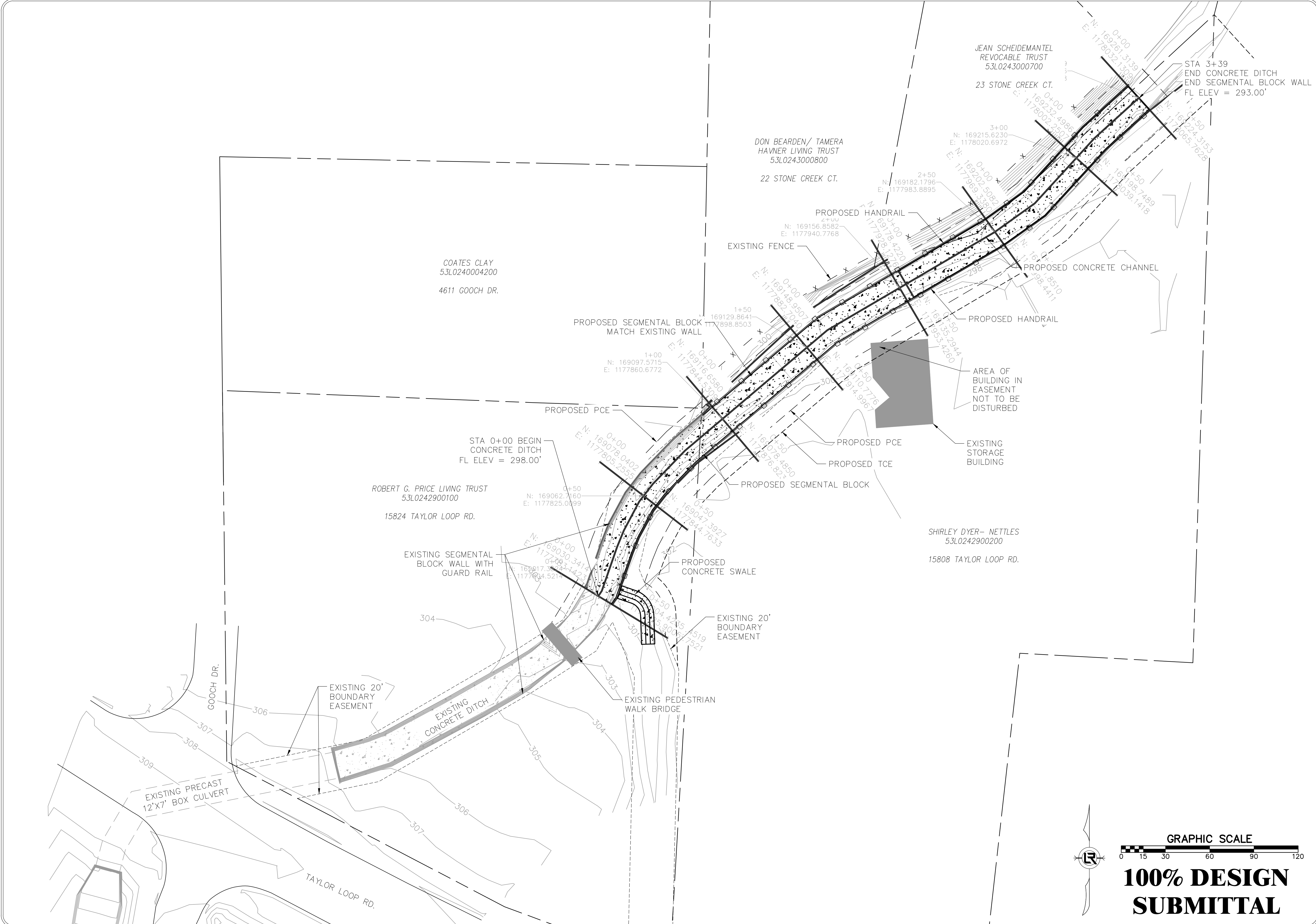

GRAPHIC SCALE
0 15 30 60 90 120

100% DESIGN SUBMITTAL

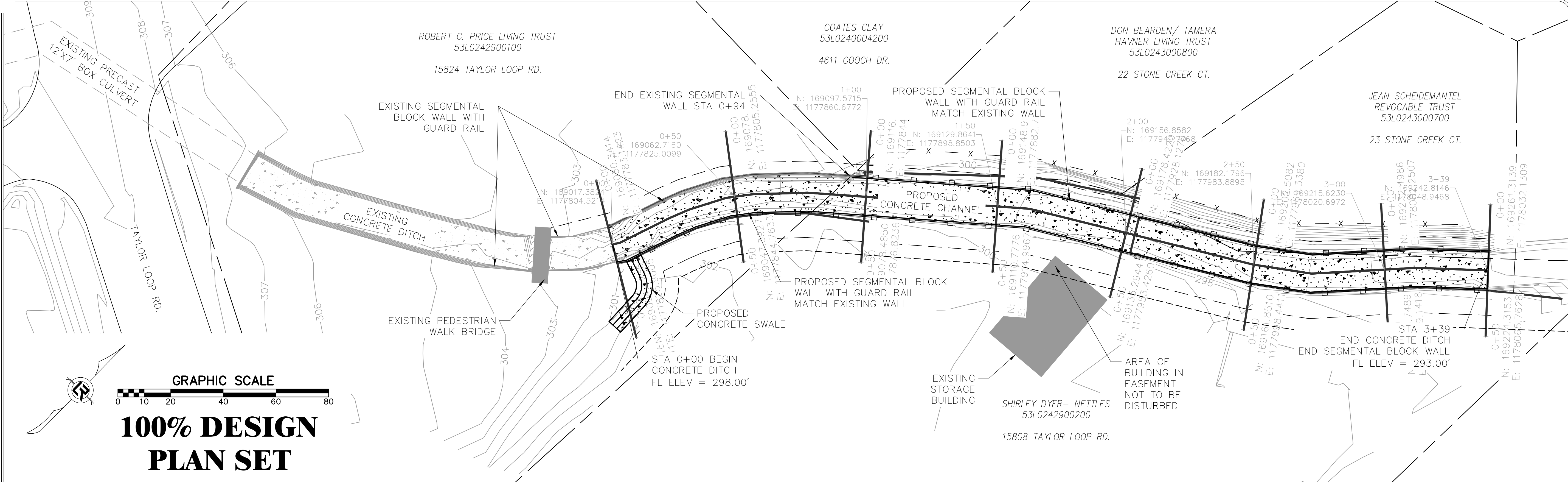

**100% DESIGN
PLAN SET**

NOTE:
TOP OF BANK LOCATIONS ARE 7' EITHER SIDE OF THE PROPOSED CHANNEL'S CENTERLINE.

PROPOSED GRADE ELEVATIONS			
STATION	TOB - WEST	TOB - EAST	CHANNEL
0+00	302.04'	300.77'	298.00'
0+50	302.24'	299.88'	297.20'
1+00	299.26'	299.23'	297.00'
1+50	297.99'	298.38'	297.54'
2+00	296.26'	297.76'	296.32'
2+50	296.37'	295.53'	294.99'
3+00	296.18'	295.03'	293.84'
3+39	294.22'	295.77'	293.00'

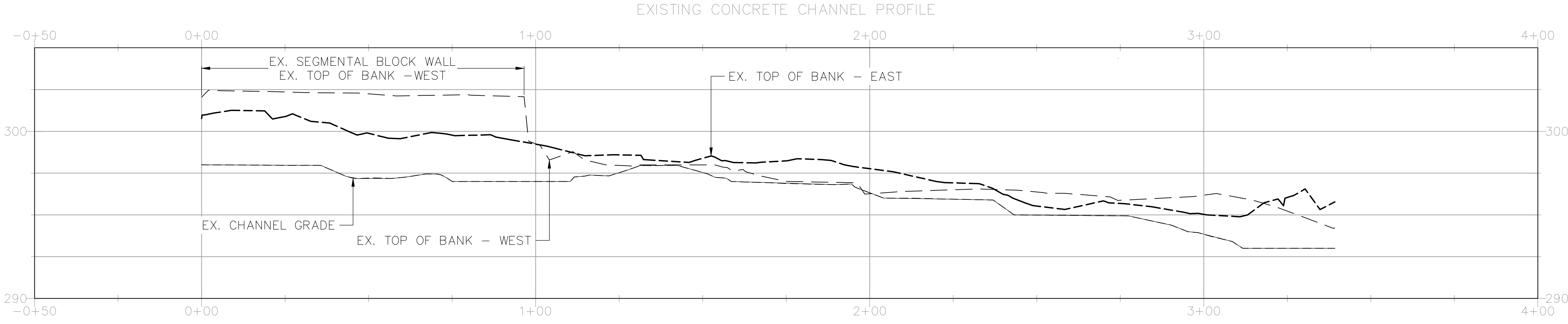

PROPOSED GRADE ELEVATIONS			
STATION	TOB - WEST	TOB - EAST	CHANNEL
0+00	302.04'	301.00'	298.00'
0+50	302.24'	300.26'	297.26'
1+00	299.61'	299.61'	296.61'
1+50	298.79'	298.79'	295.79'
2+00	298.05'	298.05'	295.05'
2+50	297.31'	297.31'	294.31'
3+00	296.58'	296.58'	293.58'
3+39	296.00'	296.00'	293.00'

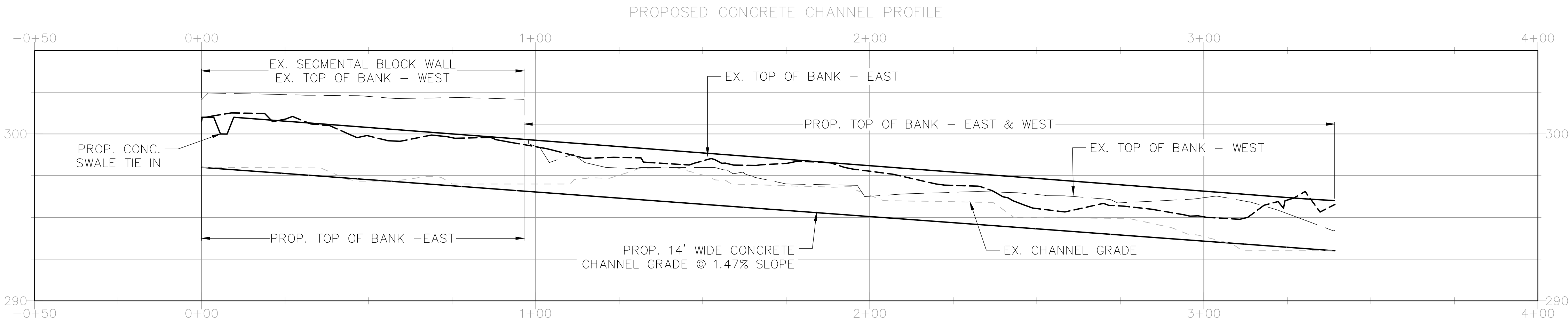

REVISIONS	DATE

CITY OF LITTLE ROCK, ARKANSAS
TAYLOR LOOP CREEK DRAINAGE
PLAN AND PROFILE SHEET

DEPARTMENT OF PUBLIC WORKS
CIVIL ENGINEERING
701 W. MARKHAM
LITTLE ROCK, ARKANSAS 72201

DRAWN BY
CTG
DESIGNED
CTG
CHECKED
BJW
DATE
01-20-25
SCALE
1" = 10'
PROJECT NO.
CLR 05-22-DR-36
SHEET NO.
C6

STA. 0+00 PROFILE

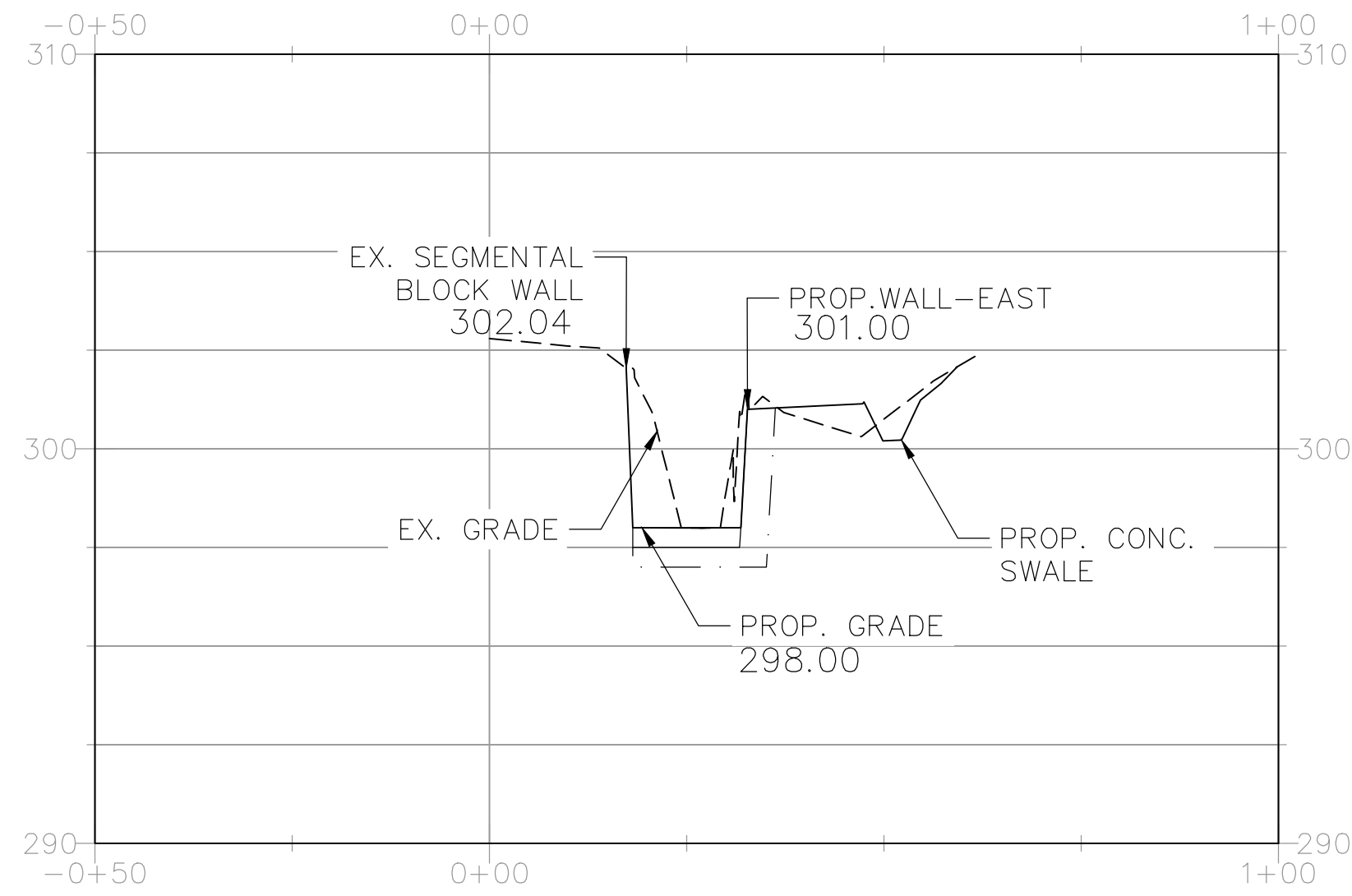

STA. 0+50 PROFILE

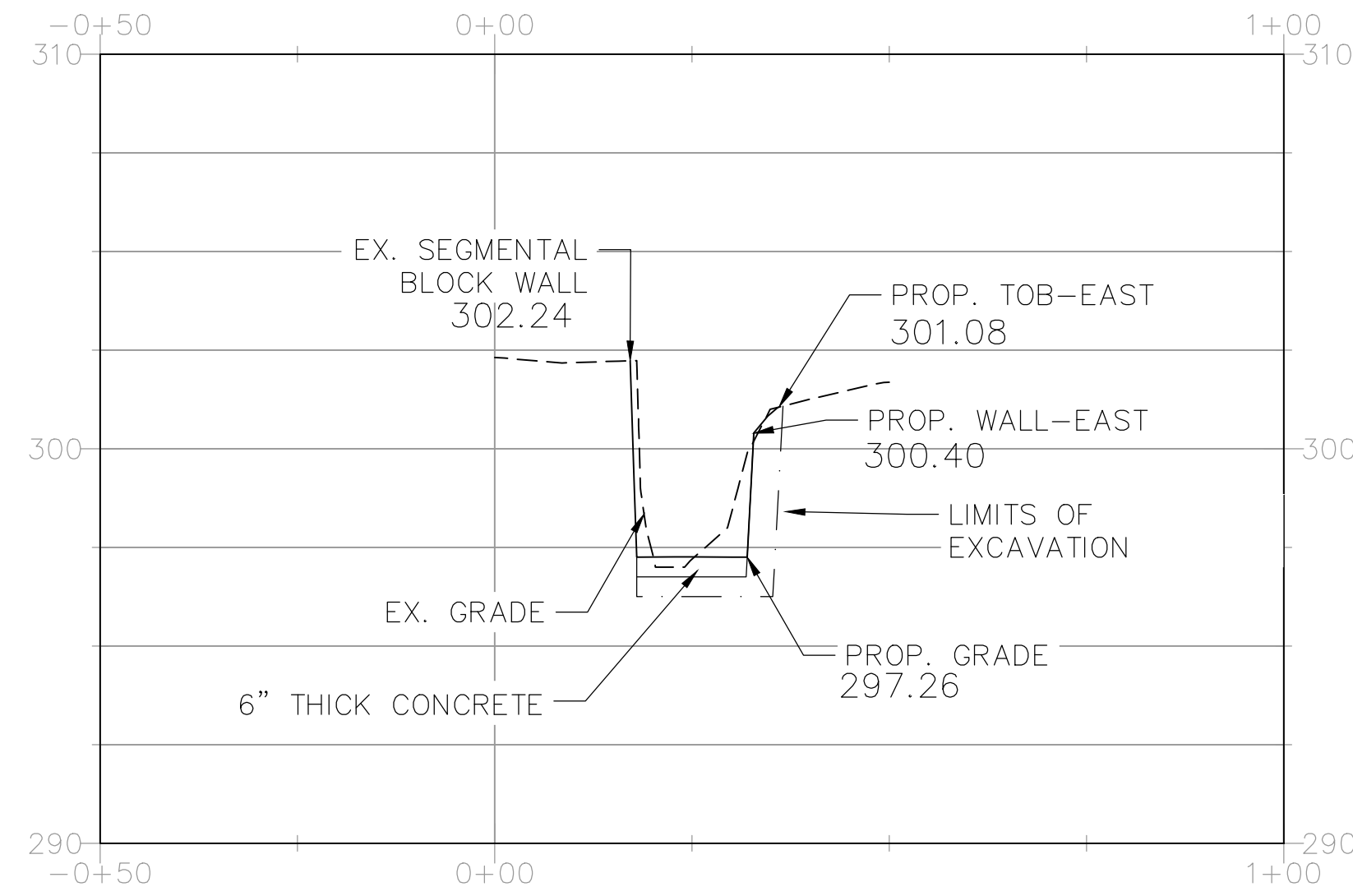

STA. 1+00 PROFILE

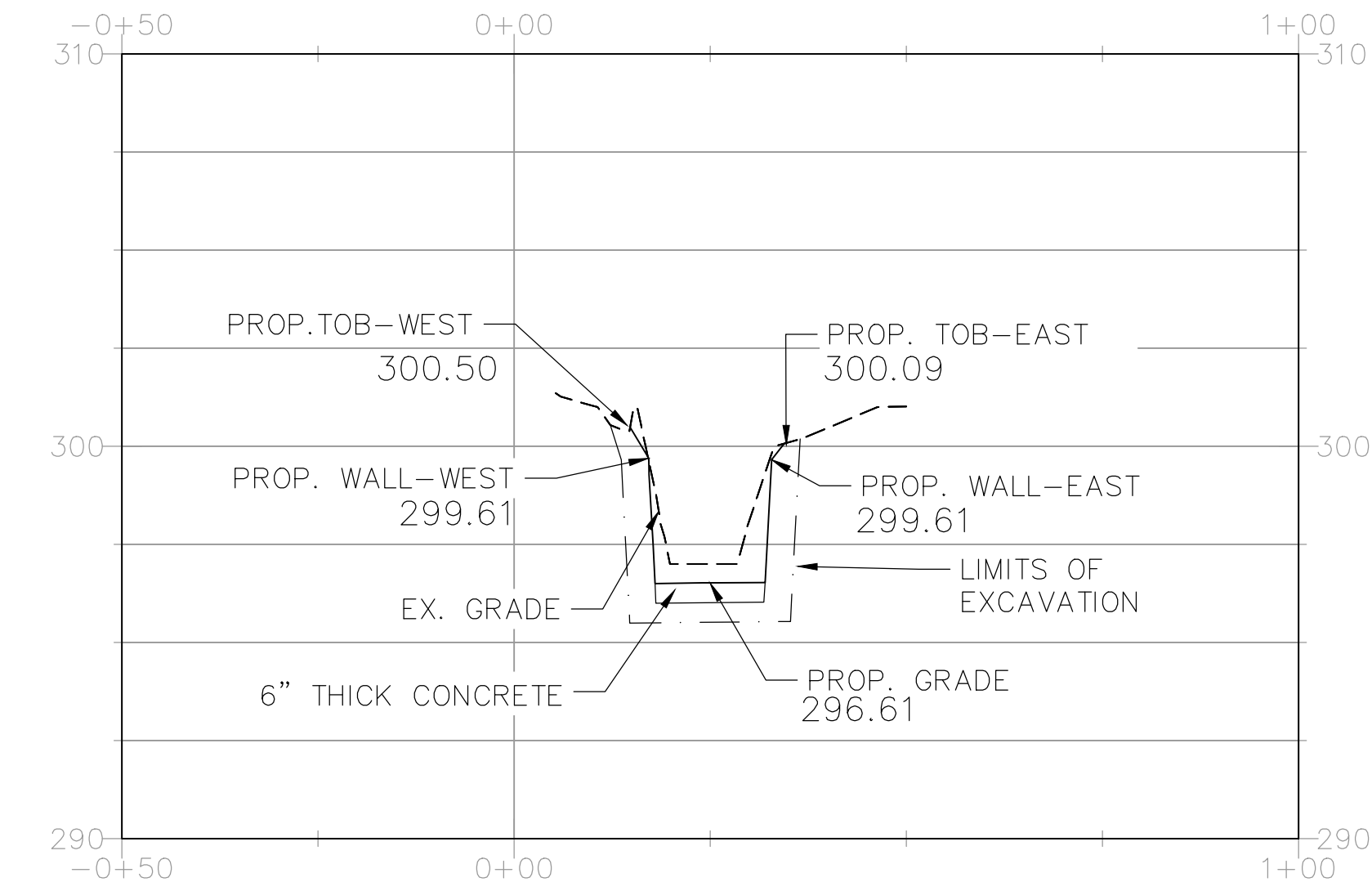

STA. 1+50 PROFILE

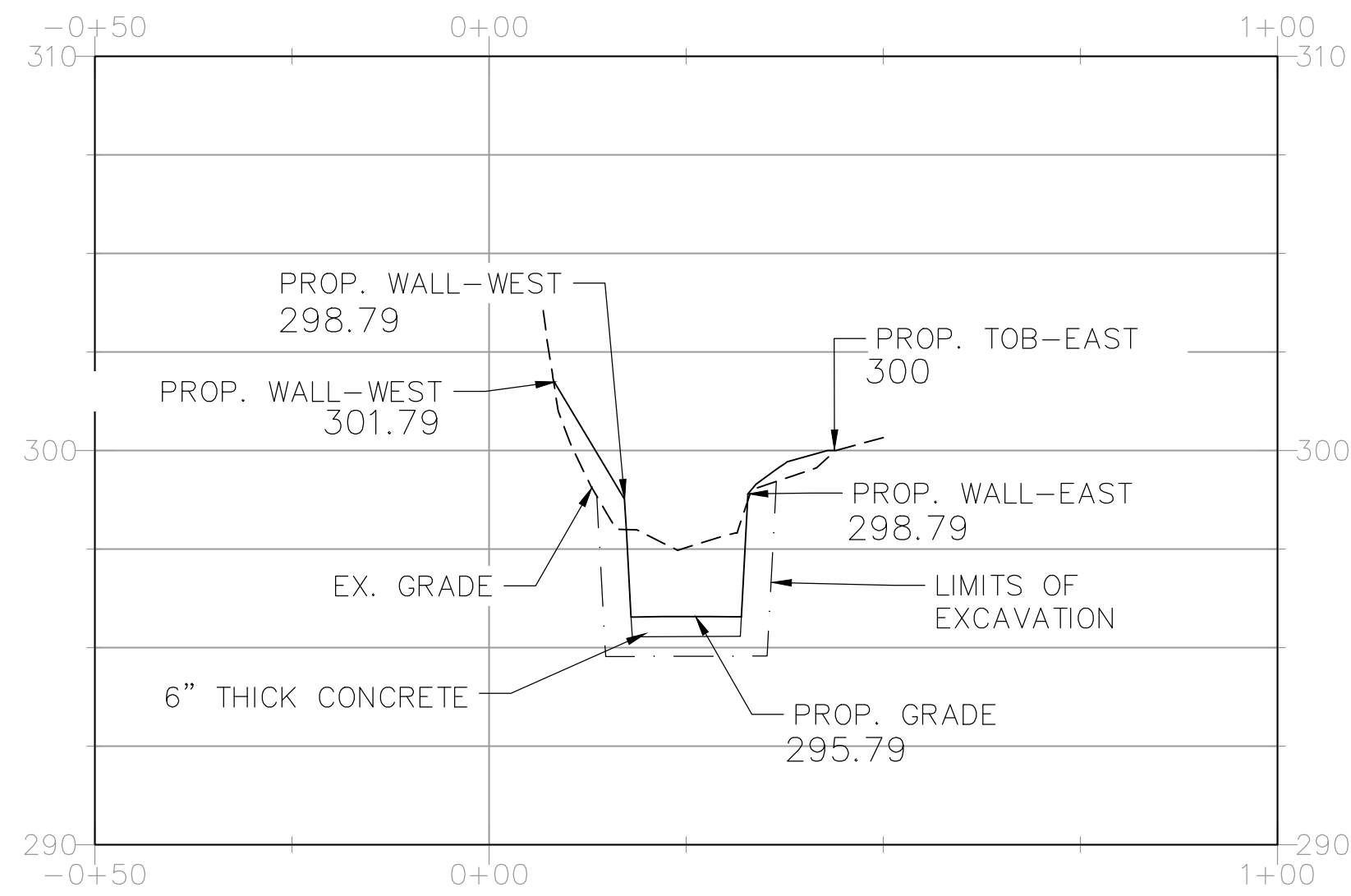

STA. 2+00 PROFILE

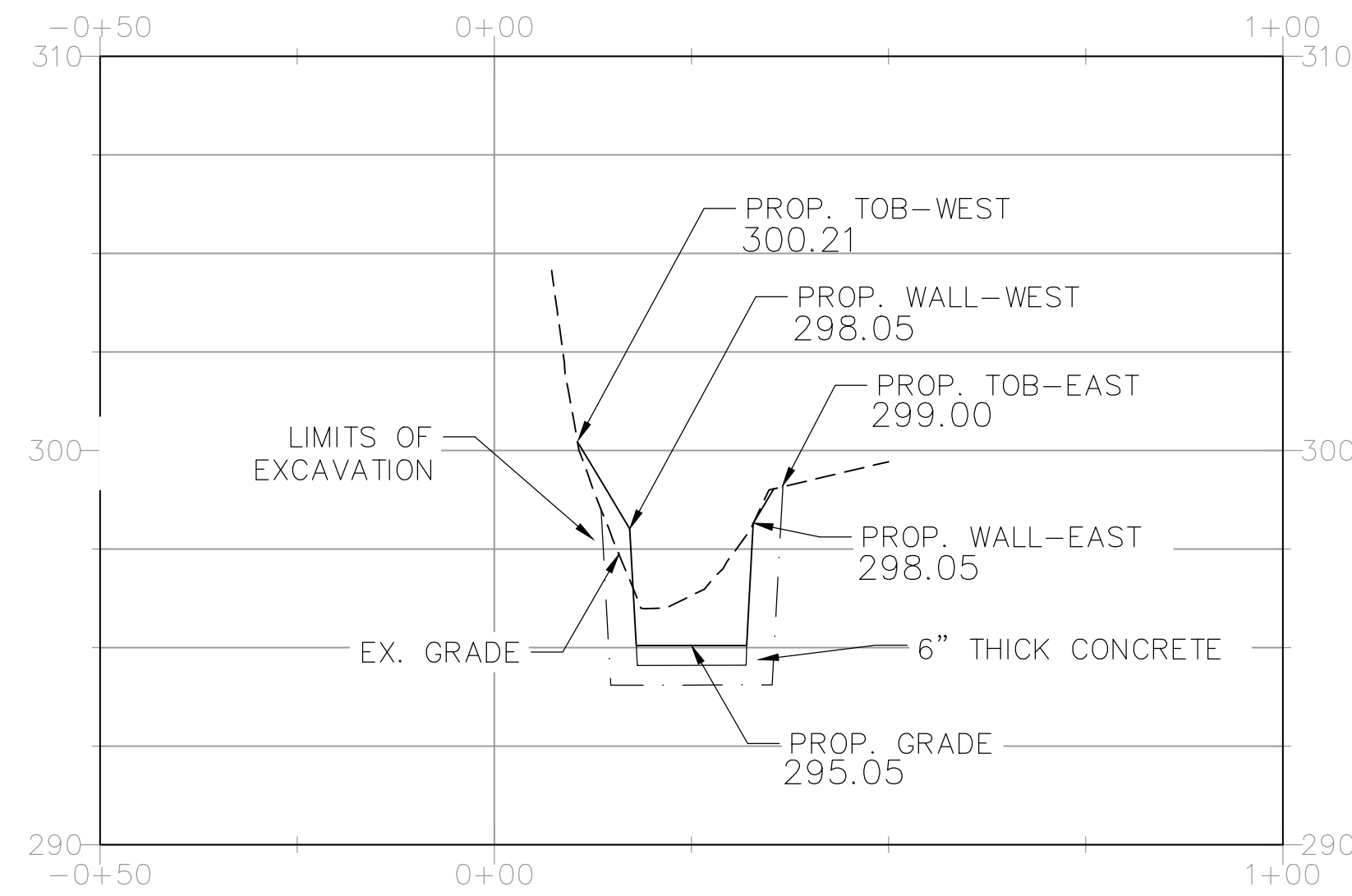

STA. 2+50 PROFILE

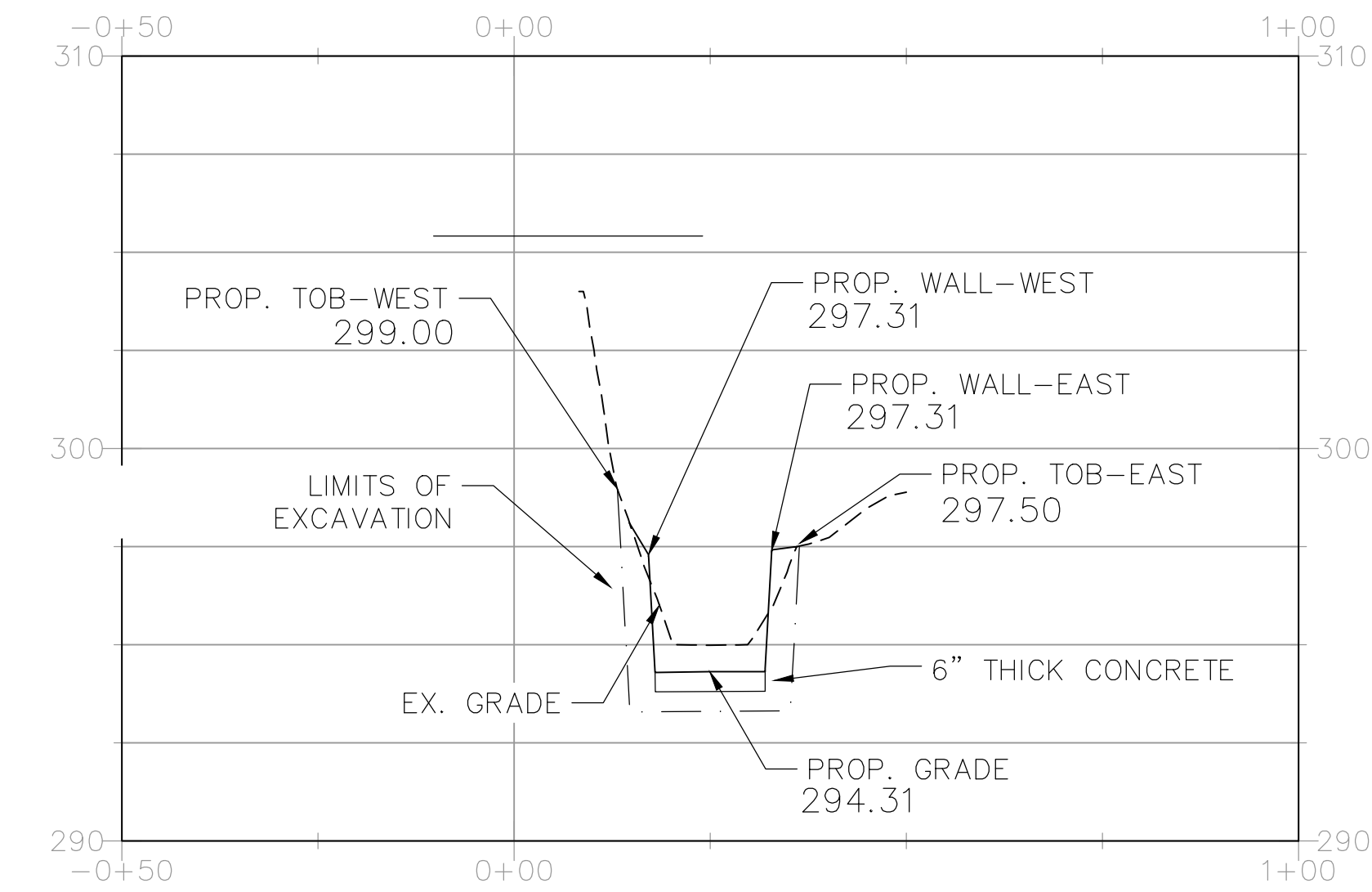

STA. 3+00 PROFILE

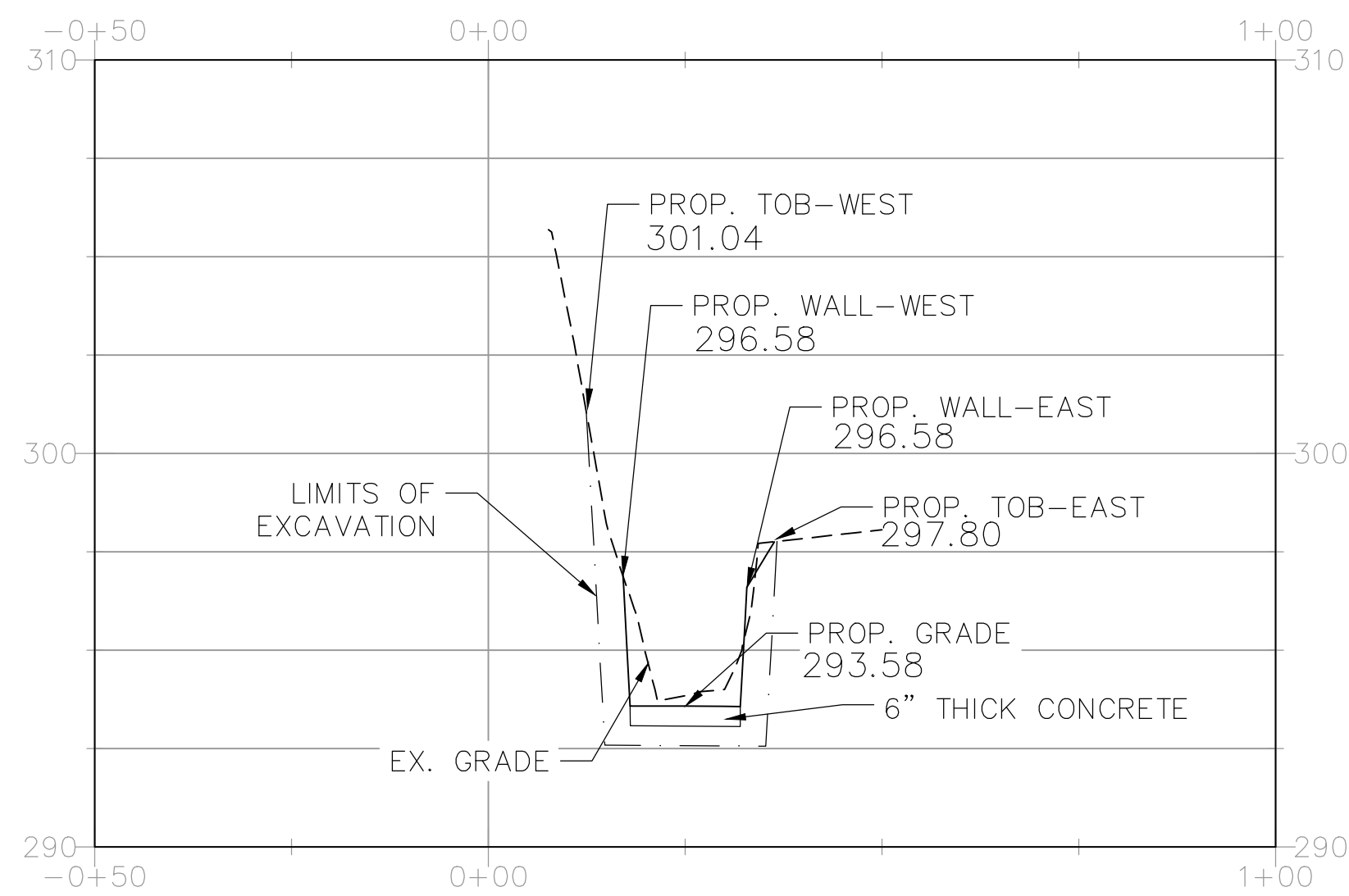

STA. 3+39 PROFILE

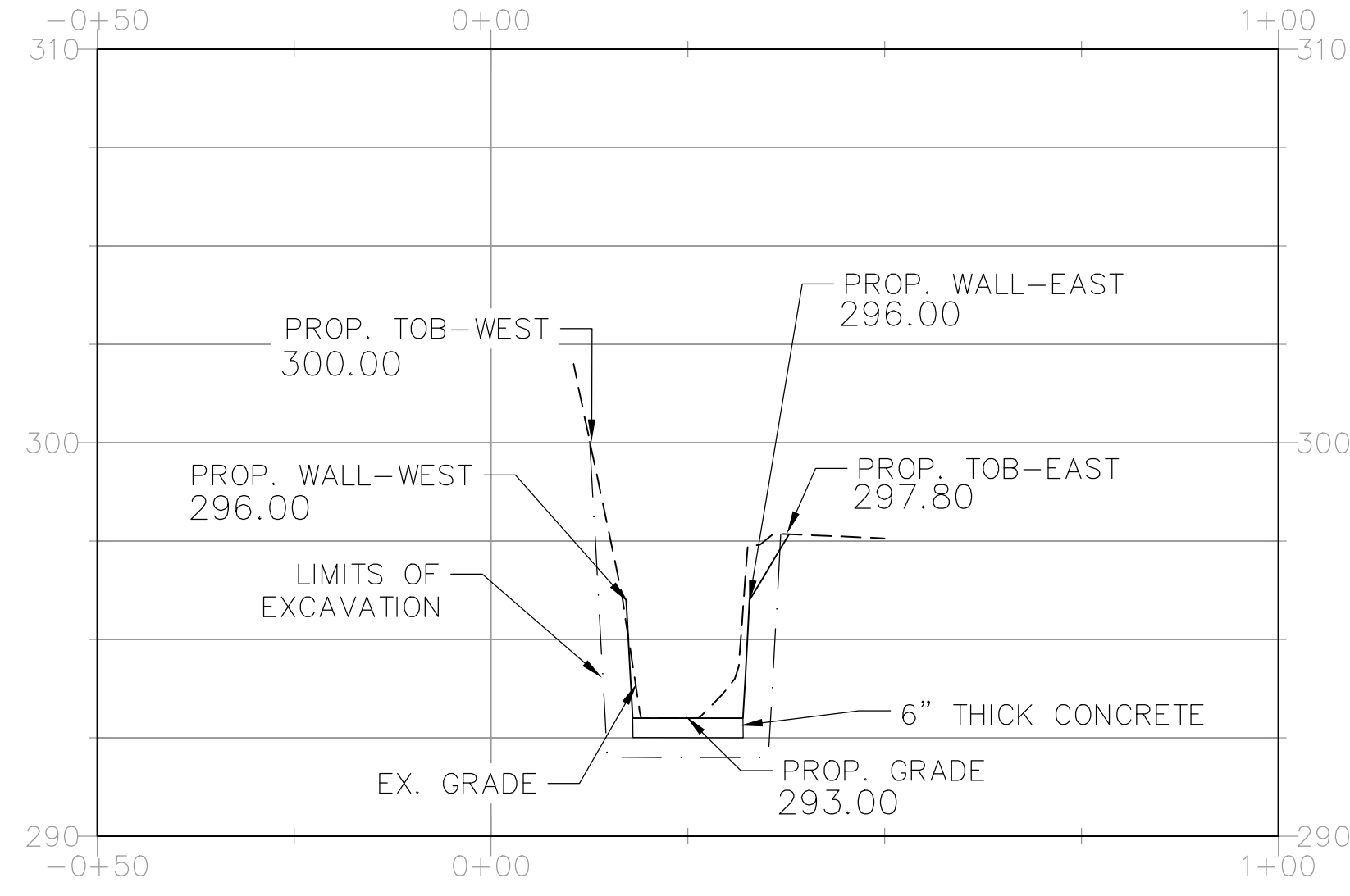

NOTE:
CONTRACTOR TO TIE INTO EXISTING SURFACE
OUTSIDE OF PROPOSED SEGMENTAL BLOCK
WALL AT A MAXIMUM SLOPE OF 3:1.

CITY OF LITTLE ROCK, ARKANSAS
TAYLOR LOOP CREEK DRAINAGE
CROSS-SECTION PROFILE SHEET

DEPARTMENT OF PUBLIC WORKS
CIVIL ENGINEERING
701 W. MARKHAM
LITTLE ROCK, ARKANSAS 72201



DRAWN BY
CTG
DESIGNED
CTG
CHECKED
BJW
DATE
01-20-25
SCALE
AS NOTED
PROJECT NO.
CLR 05-22-DR-36
SHEET NO.
C7

**100% DESIGN
SUBMITTAL**

REVISIONS	DATE

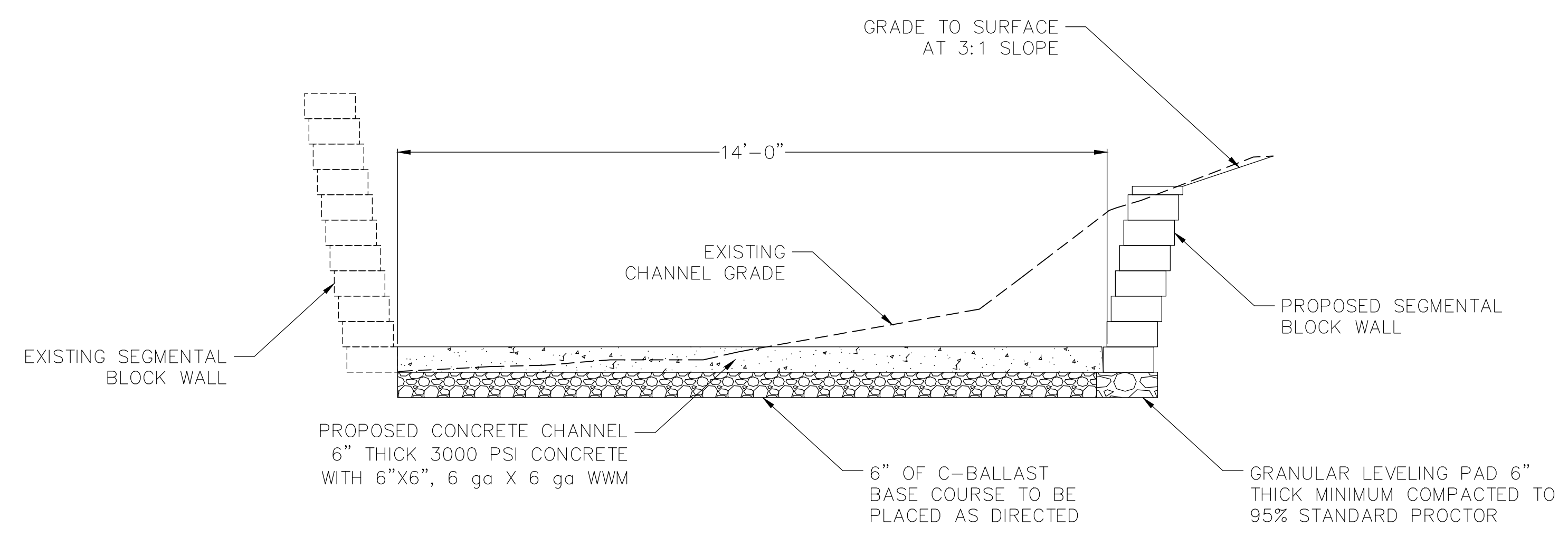

SECTION AT STA. 0+00 TO 0+94
NTS

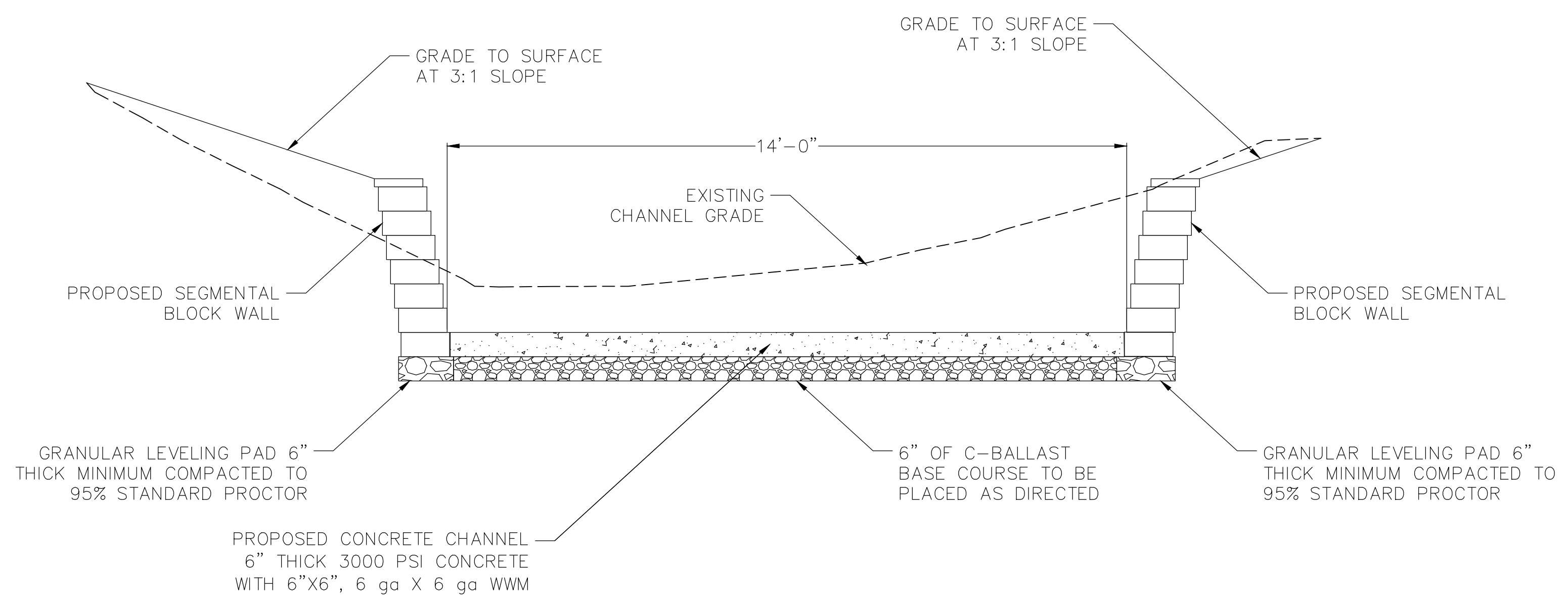

SECTION AT STA. 2+00
NTS

CITY OF LITTLE ROCK, ARKANSAS
TAYLOR LOOP CREEK DRAINAGE
CONCRETE CHANNEL SECTIONS

DEPARTMENT OF PUBLIC WORKS
CIVIL ENGINEERING
701 W. MARKHAM
LITTLE ROCK, ARKANSAS 72201



DRAWN BY
CTG
DESIGNED
CTG
CHECKED
BJW
DATE
01-20-25
SCALE
NTS
PROJECT NO.
CLR 05-22-DR-36
SHEET NO.
C8

**100% DESIGN
SUBMITTAL**

REVISIONS	DATE

CITY OF LITTLE ROCK, ARKANSAS
TAYLOR LOOP CREEK DRAINAGE
PROJECT DETAILS I

DEPARTMENT OF PUBLIC WORKS
CIVIL ENGINEERING
701 W. MARKHAM
LITTLE ROCK, ARKANSAS 72201

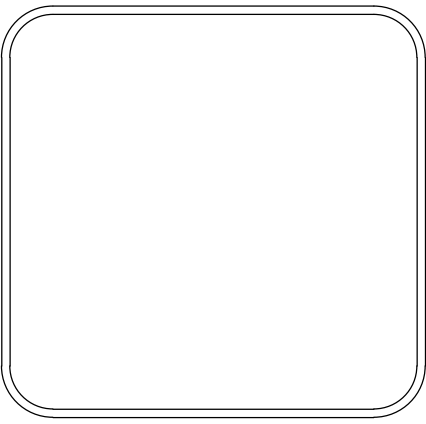

DRAWN BY
CTG
DESIGNED
CTG
CHECKED
BJW
DATE
01-20-25
SCALE
NTS
PROJECT NO.
CLR 05-22-DR-36
SHEET NO.
C9

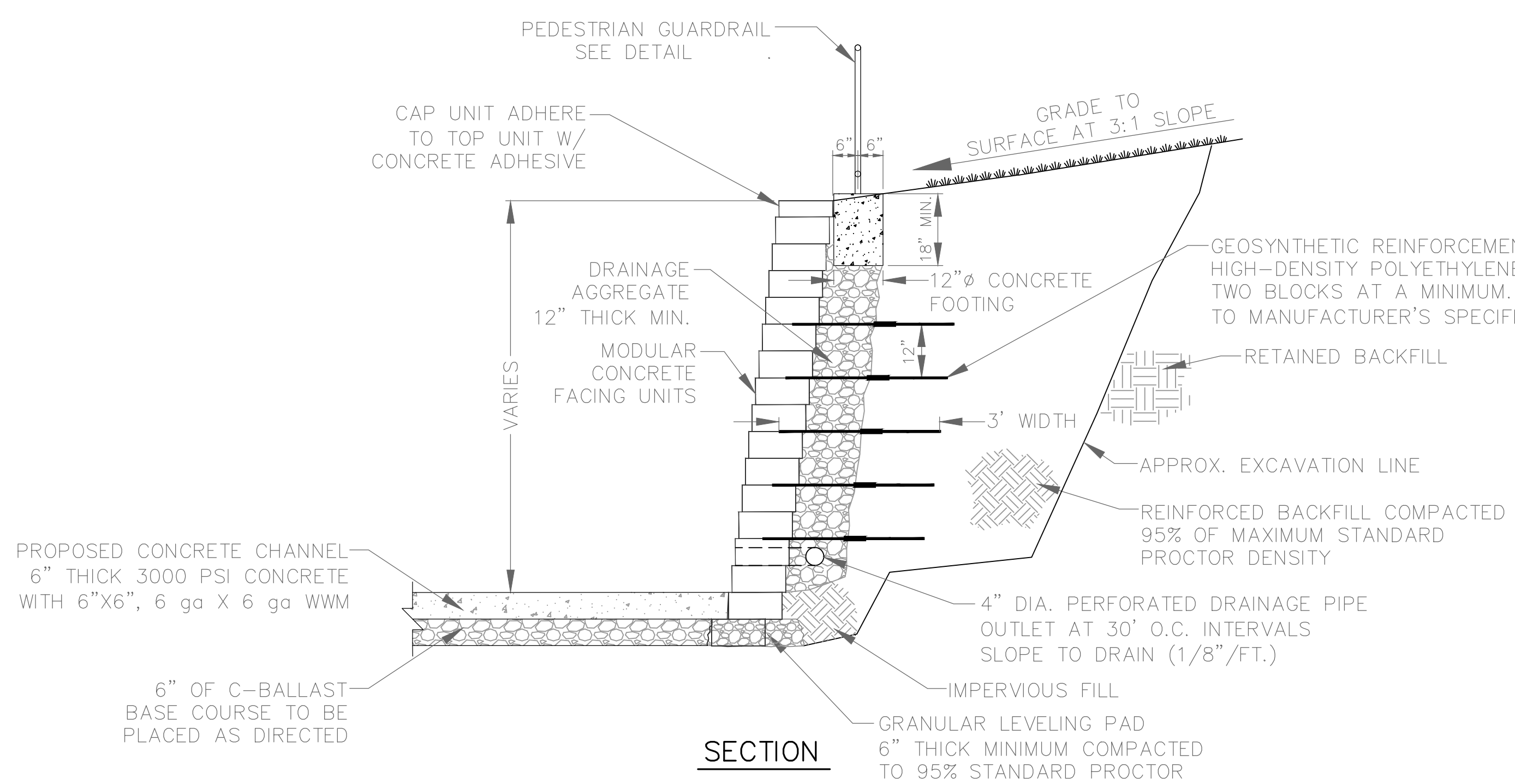

- NOTES:
- CONTRACTOR TO USE ABC BLOCK + BRICK'S CLASSIC 6 (BEVELED) RETAINING WALL BLOCK TO MATCH EXISTING RETAINING WALL ON SITE.
 - CONTRACTOR TO SUBMIT ABC BLOCK + BRICK RETAINING WALL SHOP DRAWINGS, STAMPED & SIGNED BY PROFESSIONAL ENGINEER, BASED ON MANUFACTURER'S RECOMMENDATIONS, TO ENGINEER FOR APPROVAL PRIOR TO CONSTRUCTION.

TYP. SECTION - SEGMENTAL BLOCK WALL WITH GUARDRAIL
NTS

ALL ITEMS SHOW FOR SEGMENTAL WALL SHALL BE PAID PER SQUARE FOOT OF WALL INCLUDING GEOSYNTHETIC FABRIC, DRAINAGE AGGREGATE & 4" DRAINAGE PIPE

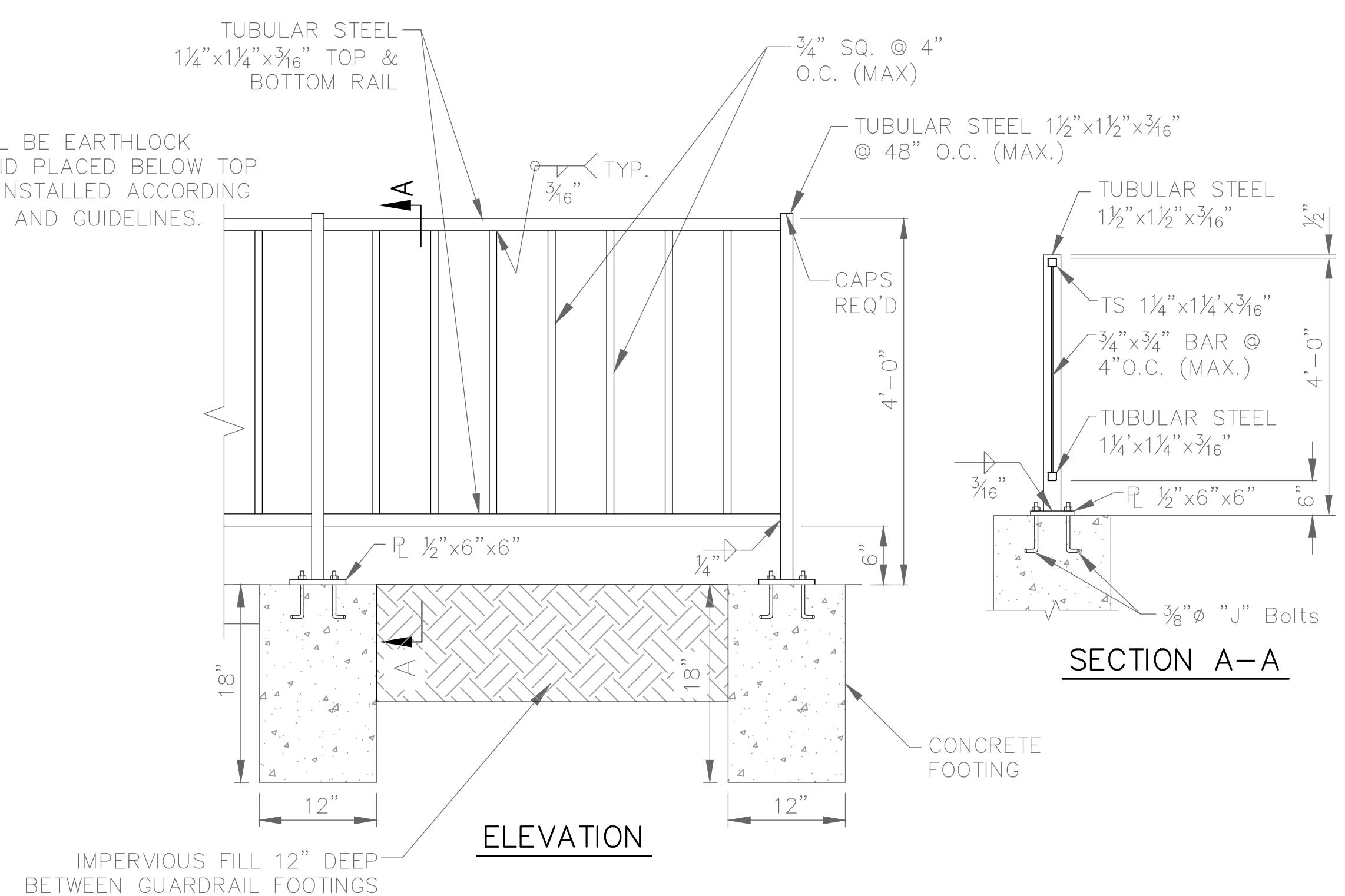

MATERIAL FOR PEDESTRIAN HANDRAIL SHALL BE AASHTO M270, GR. 36 AND SHALL BE PAINTED (BLACK). NUTS & WASHERS SHALL BE STAINLESS STEEL.

TYP. PEDESTRIAN HANDRAIL DETAIL
NTS

**100% DESIGN
SUBMITTAL**

REVISIONS	DATE

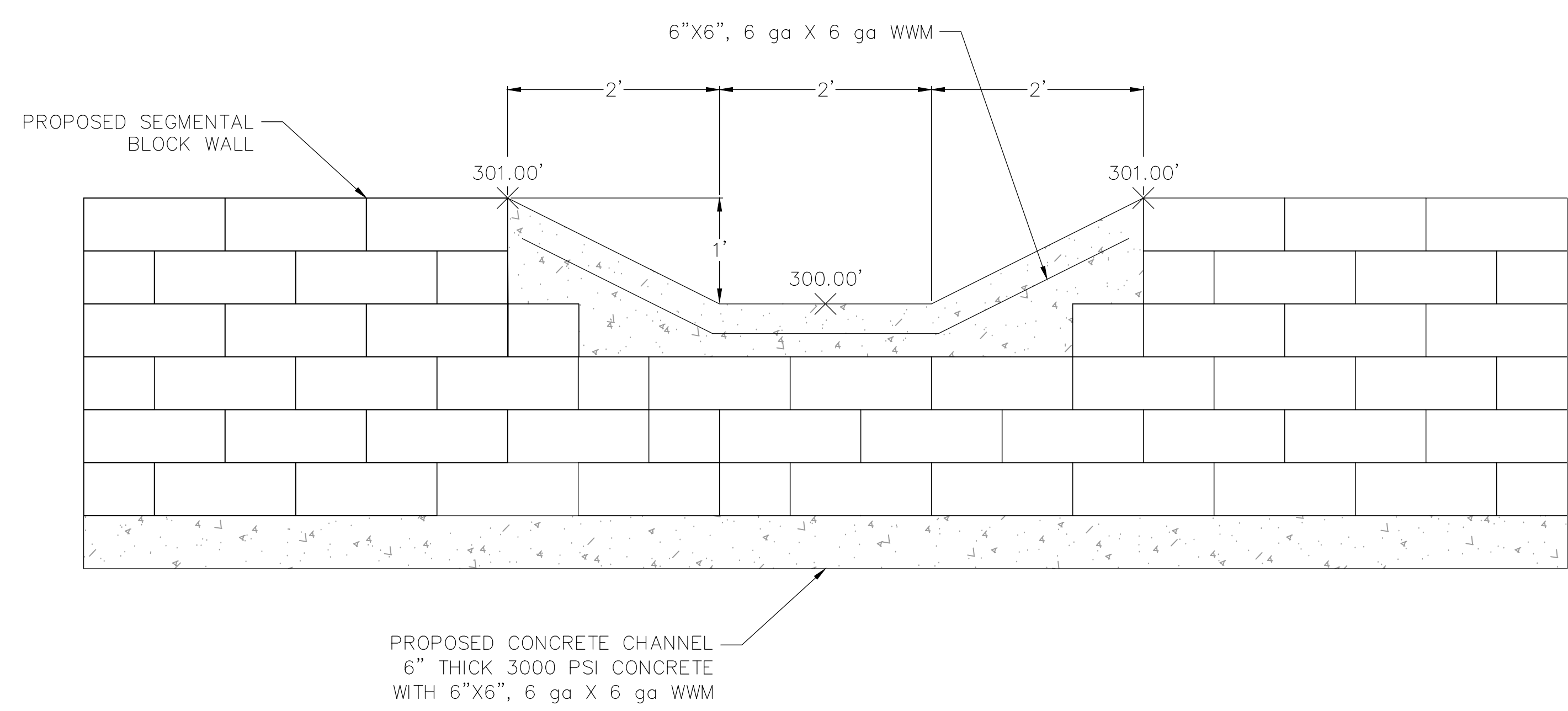

CONCRETE SWALE & BLOCK WALL TIE-IN DETAIL
NTS

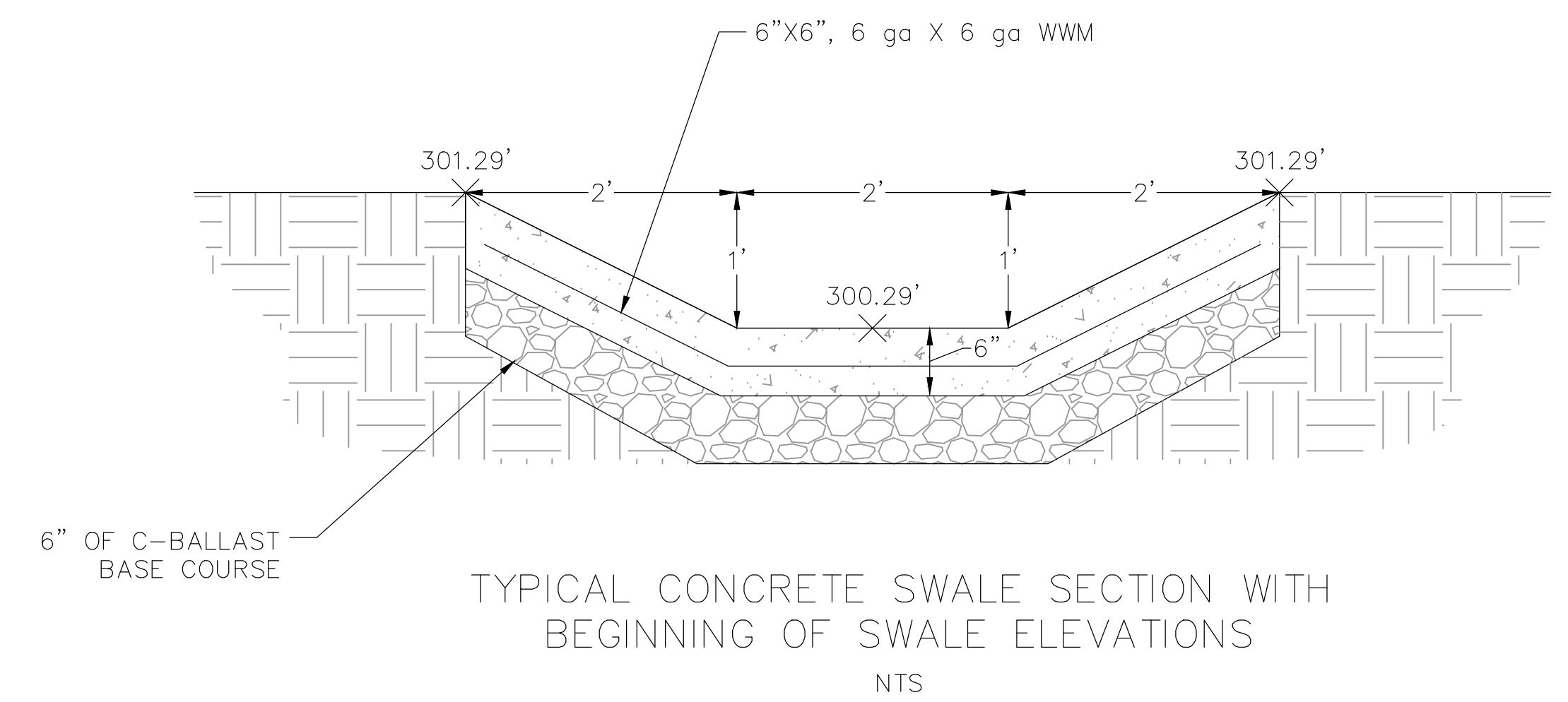

TYPICAL CONCRETE SWALE SECTION WITH
BEGINNING OF SWALE ELEVATIONS
NTS

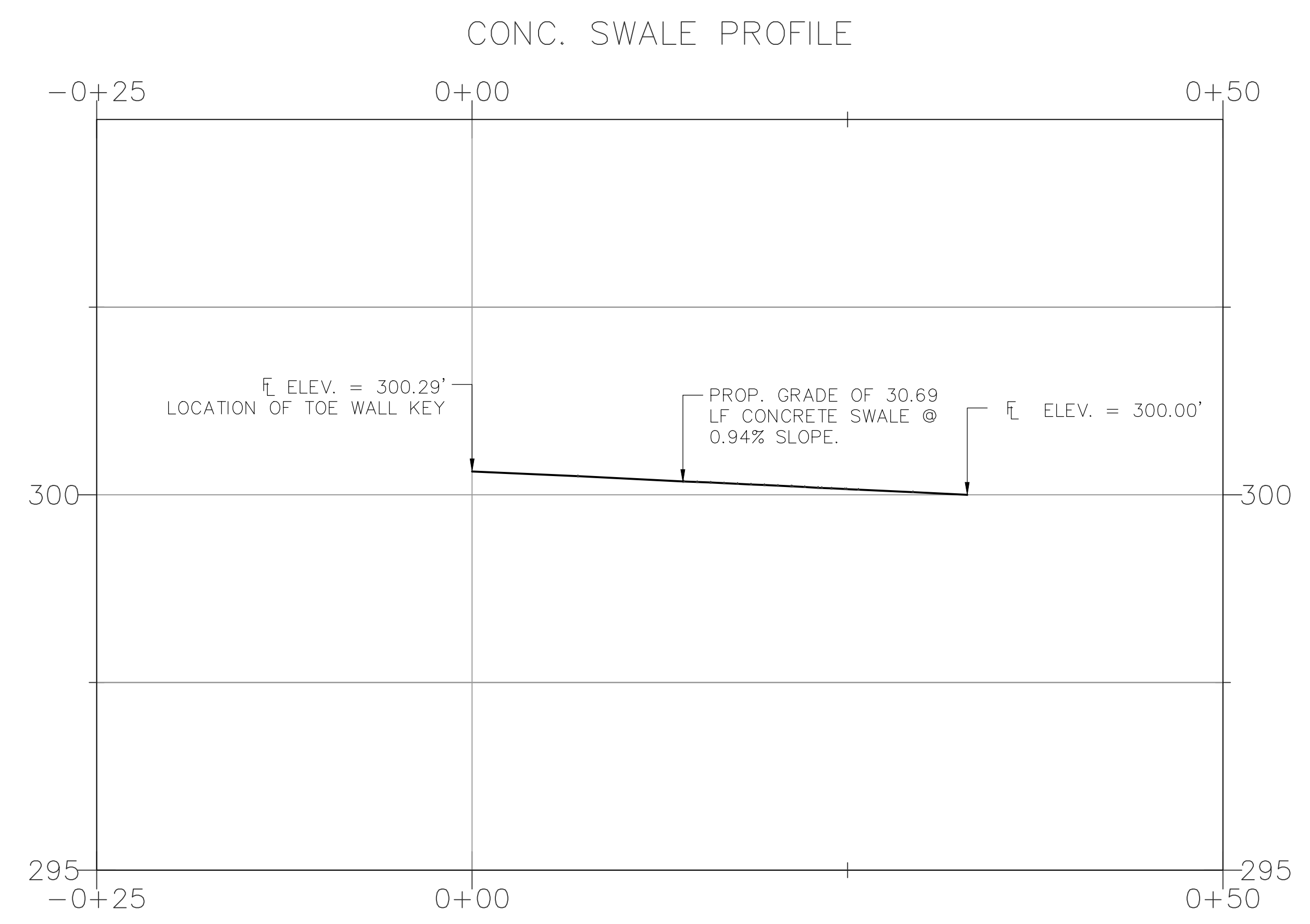

CONC. SWALE PROFILE

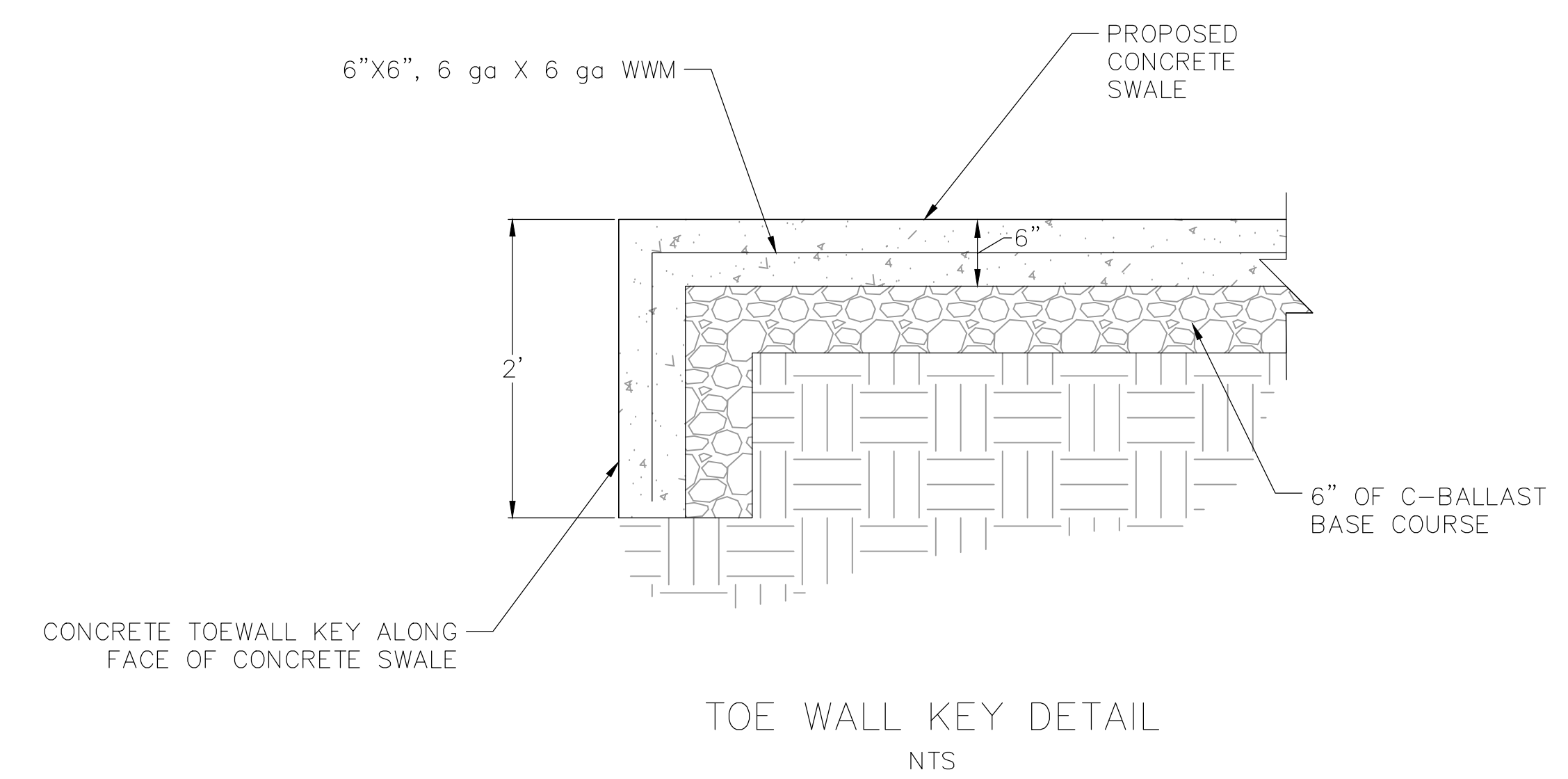

TOE WALL KEY DETAIL
NTS

**100% DESIGN
SUBMITTAL**

CITY OF LITTLE ROCK, ARKANSAS
TAYLOR LOOP CREEK DRAINAGE
PROJECT DETAILS II

DEPARTMENT OF PUBLIC WORKS
CIVIL ENGINEERING
701 W. MARKHAM
LITTLE ROCK, ARKANSAS 72201

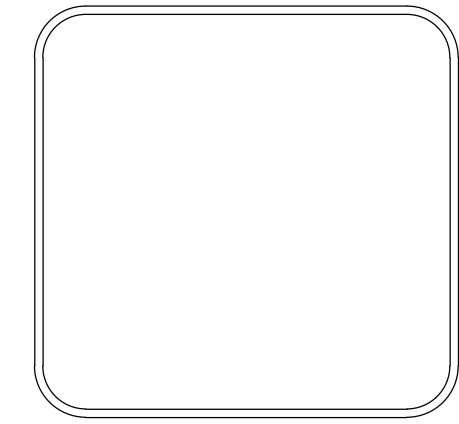

DRAWN BY
CTG
DESIGNED
CTG
CHECKED
BJW
DATE
01-20-25
SCALE
NTS
PROJECT NO.
CLR 05-22-DR-36
SHEET NO.
C10