

CLR PROJECT 02-22-DR-06 #57TH STREET DRAINAGE

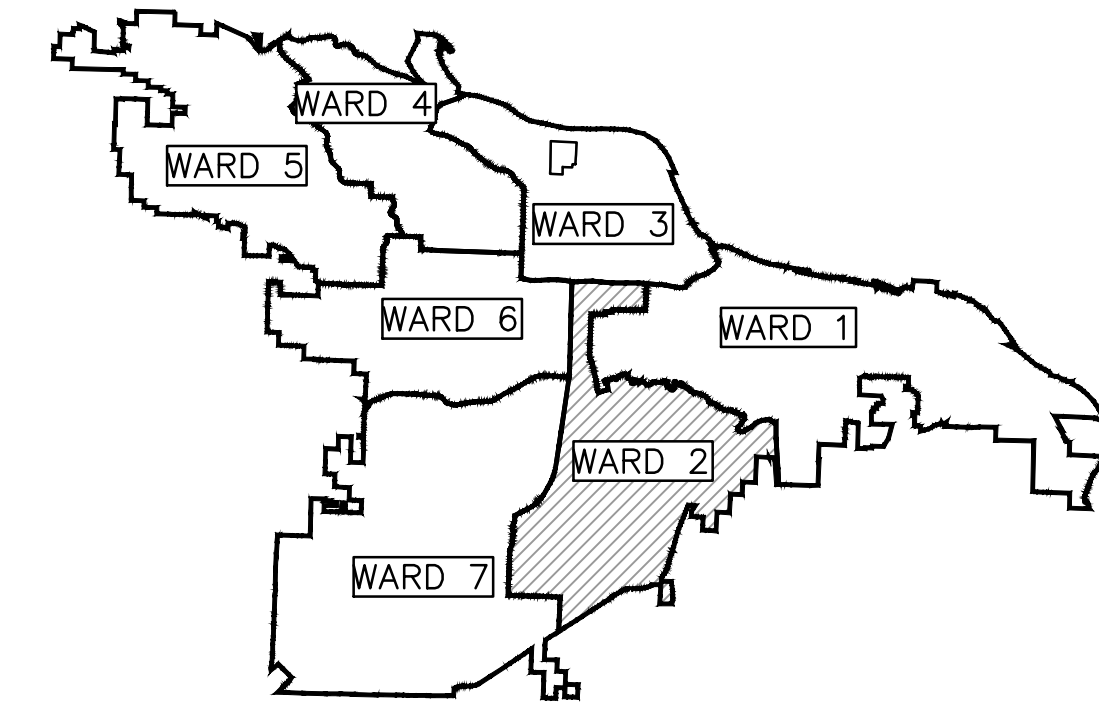

PROJECT LOCATION - WARD 2

INDEX OF SHEETS:

- C1 COVER SHEET
- C2 GENERAL NOTES, LEGEND AND QUANTITIES
- C3 TYPICAL SECTIONS
- C4 EXISTING CONDITIONS
- C5 PLAN & PROFILE
- C6 DRIVEWAY DETAILS
- C7 CROSS SECTIONS
- C8 PROJECT LAYOUT
- C9 EROSION CONTROL

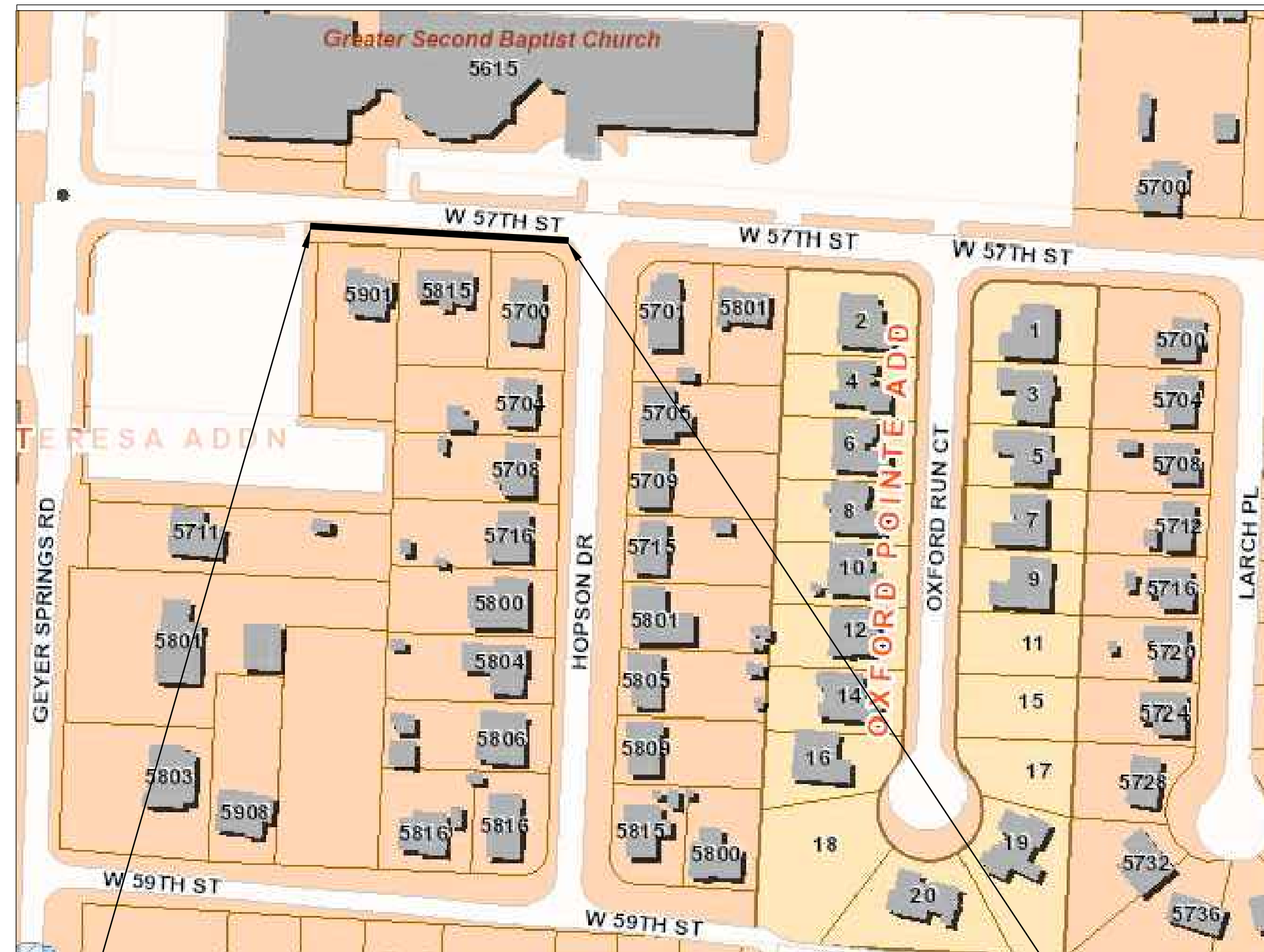

PROJECT LOCATION

BEGIN PROJECT
57TH STREET
CL STA 10+54.18
NORTHING = 132897.4412
EASTING = 1209480.5066

END PROJECT
57TH STREET
CL STA 12+91.44
NORTHING = 132883.4800
EASTING = 1209717.8943

DEPARTMENT OF PUBLIC WORKS
CIVIL ENGINEERING
701 WEST MARKHAM STREET
LITTLE ROCK, ARKANSAS 72201



**2023-2025
BOND PROGRAM**



SURVEYOR:



4701 NORTHSHORE DRIVE
NORTH LITTLE ROCK, AR 72118
PHONE: 501-376-3633
WWW.GARVERUSA.COM

ENGINEER OF RECORD:



2020 WEST 3RD STREET, SUITE 504
LITTLE ROCK, AR 72205
PHONE: 501-215-5807 FAX: 501-227-8302
WWW.ICONICCG.COM



REVISIONS DATE

REVISIONS	DATE

CITY OF LITTLE ROCK, ARKANSAS
#57TH STREET DRAINAGE

COVER SHEET

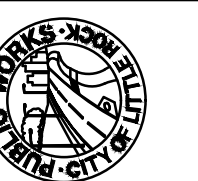

DEPARTMENT OF PUBLIC WORKS
CIVIL ENGINEERING
701 W. MARKHAM
LITTLE ROCK, ARKANSAS 72201

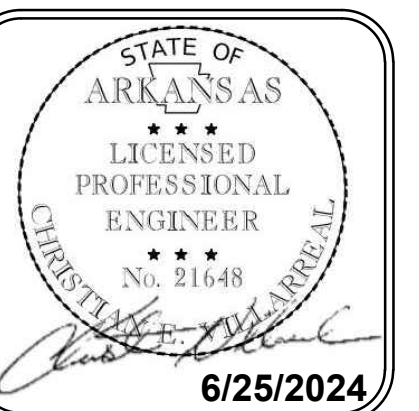
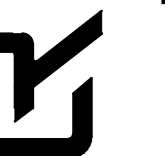

DRAWN BY

BJ
DESIGNED
BJ
CHECKED
CV
DATE
6/25/2024
SCALE
N.T.S.
PROJECT NO.
02-22-DR-06
SHEET NO.
C1

CLR PROJECT 02-22-DR-06			
		2024/06/24	
ITEM #	ITEM DESCRIPTION	UNIT	QUANTITY
2.01	SITE PREPARATION (INCLUDES MOBILIZATION)	LS	1
3.01	UNCLASSIFIED EXCAVATION	CY	35
3.07	COMPACTED EMBANKMENT	CY	88
4.01	AGGREGATE BASE COURSE	TON	-12
5.01	TACK COAT	GAL	5
6.01	ACHM SURFACE COURSE	TON	-5
7.06	CONCRETE DRIVEWAY (6" THICK), STANDARD FINISH	SF	-497
8.03	CONCRETE CURB & GUTTER (CLASS 3)	LF	237
10.01	JUNCTION BOX (4')	EA	1
10.04A	CURB INLET- 4'X6' BOX	EA	1
10.07	WING 3' EXTENSION	EA	1
13.21	STORM DRAIN PIPE, 24" SIDE DRAIN	LF	232
13.61	TIE TO EXISTING JUNCTION BOX	EA	1
14.01	SOLID SODDING (BERMUDA) (INCLUDES 4" TOPSOIL)	SY	350
16.01	MAINTENANCE OF TRAFFIC	LS	1
19.01	FINAL CLEAN-UP	LS	1
24.09	SEDIMENT BARRIER, BLOCK (SD4)	EA	1
24.11	SILT FENCE - TYPE A (SFA)	LF	454
26.01	TRENCH & EXCAVATION SAFETY	LS	1
SP	ASBUILT SURVEY	LS	1

40
9
578

EXISTING

- IRON ROD
- PK NAIL
- R.R. SPIKE
- CONC. MONUMENT
- WATER VALVE
- WATER METER
- FIRE HYDRANT
- GAS METER
- GAS VALVE
- CLEAN-OUT
- GUARD POST (BOLLARD)
- SIGN POST
- BENCHMARK
- STORM SEWER MANHOLE
- SANITARY SEWER MANHOLE
- TELEPHONE MANHOLE
- ELECTRIC MANHOLE
- TELEPHONE BOX
- ELECTRIC BOX
- CABLE BOX
- UTILITY POLE
- GUY WIRE
- LIGHT POLE
- POST OR POLE (TYPE AS NOTED)
- MAILBOX
- DECIDUOUS TREE
- EVERGREEN/CONIFEROUS TREE
- BUSH
- PROPERTY LINE
- SETBACK LINE
- EASEMENT LINE
- CURB
- FENCE
- OVERHEAD ELECTRIC
- OVERHEAD TELEPHONE
- OVERHEAD CABLE
- UNDERGROUND TELEPHONE
- UNDERGROUND ELECTRIC
- UNDERGROUND CABLE
- FIBER OPTIC
- WATER LINE
- SEWER LINE
- GAS LINE
- STORM SEWER/CULVERT
- EDGE OF WOODS
- CONTOUR LINE



PROPOSED

- PROPOSED CONTOUR
- PROPOSED SPOT ELEVATION
- PROPOSED SPOT CURB ELEVATION
- STORM SEWER - PIPE
- STORM SEWER - MITERED END SECTION
- STORM SEWER - GRATE INLET
- STORM SEWER - JUNCTION BOX
- STORM SEWER - FLARED END SECTION
- STORM SEWER - HEADWALL
- STORM SEWER - SINGLE WING
- STORM SEWER - DOUBLE WING
- STORM SEWER - AREA INLET
- GRADE BREAK LINE
- HIGH POINT
- LOW POINT
- CUT LINE
- FILL LINE
- SANITARY SEWER PIPE
- SANITARY SEWER MANHOLE
- PROPOSED CURB
- PROPOSED CONCRETE
- PROPOSED ASPHALT
- 1-1/2" ASPHALT MILL AND OVERLAY
- CONSTRUCTION - ENTRANCE/EXIT
- CHECK DAM
- DIVERSION BERM
- DOWNDRAIN STRUCTURE - TEMPORARY
- ROCK DAM
- SEDIMENT BARRIER - SILT FENCE
- SEDIMENT BARRIER - GRAVEL RING
- SEDIMENT BARRIER - BLOCK & GRAVEL
- SEDIMENT BARRIER - BLOCK
- TEMPORARY SEDIMENT BASIN
- SILT FENCE - TYPE A
- SILT FENCE - TYPE B
- SILT FENCE - TYPE C
- STORM DRAIN OUTLET PROTECTION
- SURFACE ROUGHENING
- DISTURBED AREA STABILIZATION -TEMPORARY STABILIZATION
- DISTURBED AREA STABILIZATION -TEMPORARY GRASSING
- DISTURBED AREA STABILIZATION -PERMANENT GRASSING
- MATTING/BLANKETS

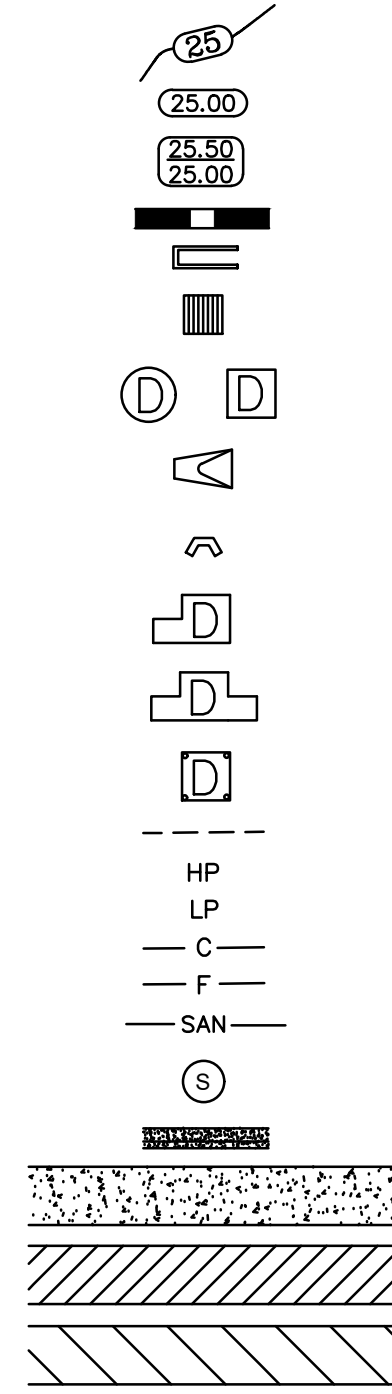

REVISIONS	DATE

CITY OF LITTLE ROCK, ARKANSAS
#57TH STREET DRAINAGE
GENERAL NOTES, LEGEND AND QUANTITIES

DEPARTMENT OF PUBLIC WORKS
CIVIL ENGINEERING
701 W. MARKHAM
LITTLE ROCK, ARKANSAS 72201

6/25/2024

DRAWN BY BJ
DESIGNED BJ
CHECKED CV
DATE 6/25/2024
SCALE N.T.S
PROJECT NO. 02-22-DR-06
SHEET NO. C2

REVISIONS	DATE

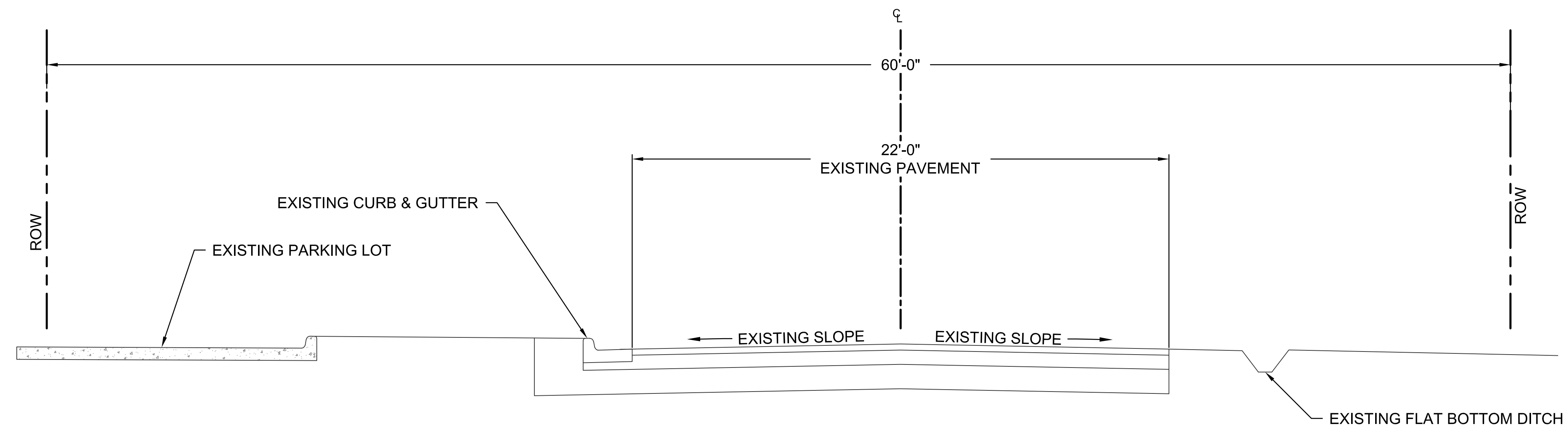

EXISTING TYPICAL SECTION

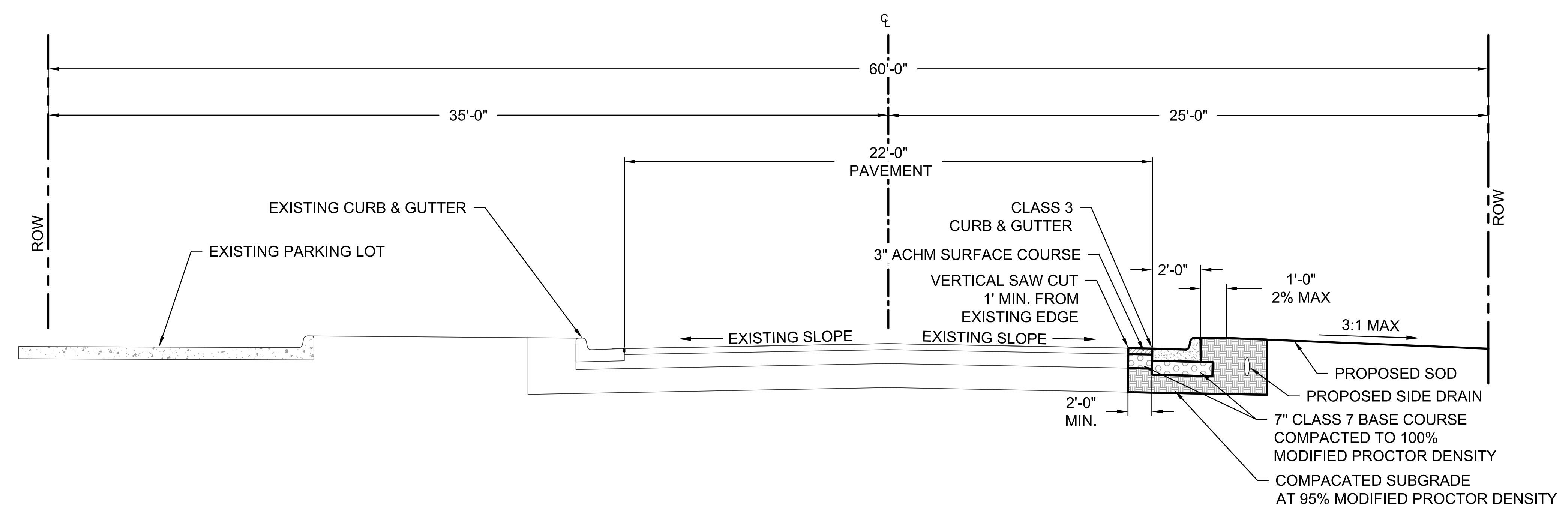

PROPOSED TYPICAL SECTION

CITY OF LITTLE ROCK, ARKANSAS
 #57TH STREET DRAINAGE
 TYPICAL SECTIONS

DEPARTMENT OF PUBLIC WORKS
 CIVIL ENGINEERING
 701 W. MARKHAM
 LITTLE ROCK, ARKANSAS 72201

STATE OF ARKANSAS
 LICENSED PROFESSIONAL ENGINEER
 No. 21648
 6/25/2024

DRAWN BY
 BJ
 DESIGNED
 BJ
 CHECKED
 CV
 DATE
 6/25/2024
 SCALE
 NTS
 PROJECT NO.
 02-22-DR-06
 SHEET NO.
C3

REVISIONS	DATE

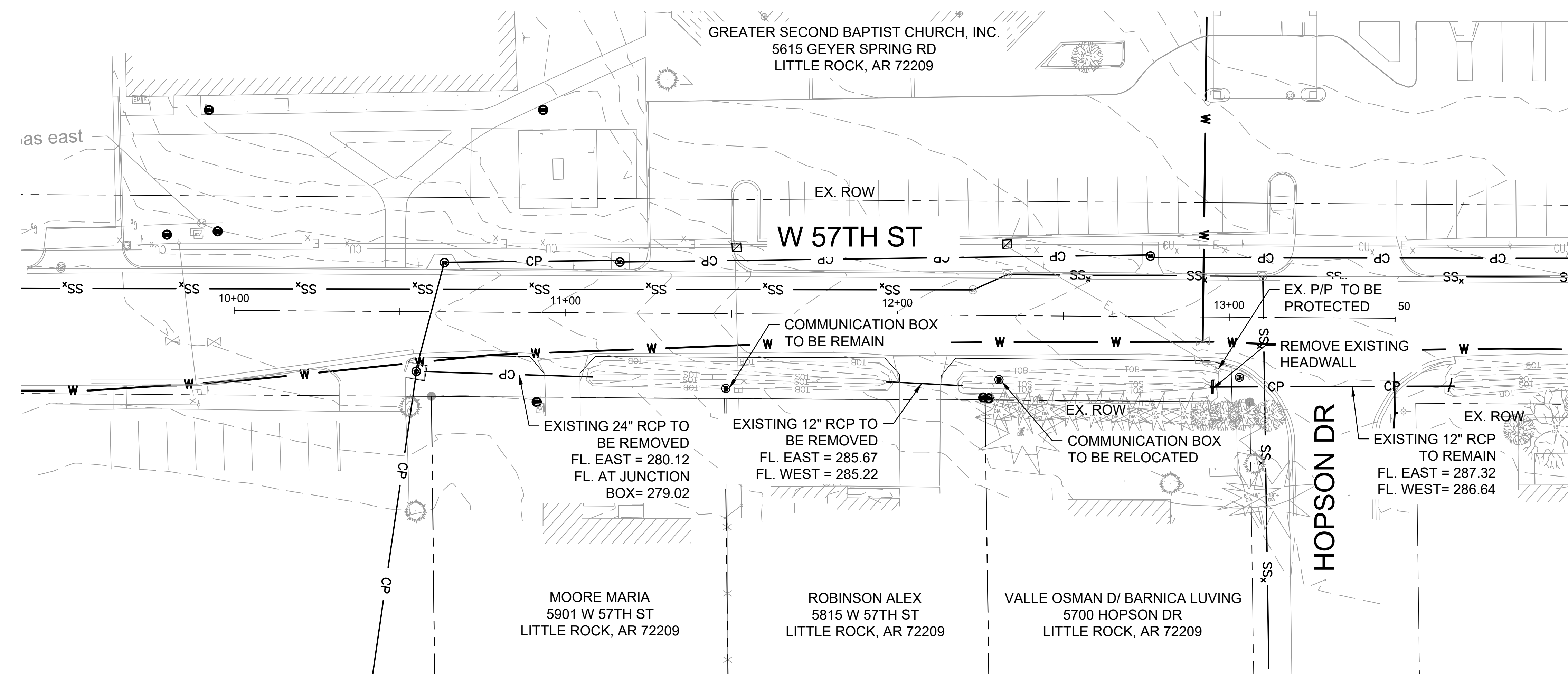
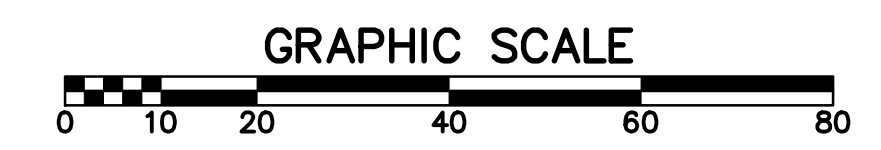
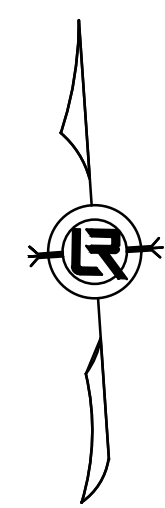

- NOTES:
- REMOVAL OF EXISTING DRAINAGE PIPE AND STRUCTURES ARE SUBSIDIARY TO SITE PREPARATION.

CITY OF LITTLE ROCK, ARKANSAS
#57TH STREET DRAINAGE
EXISTING CONDITIONS

DEPARTMENT OF PUBLIC WORKS
CIVIL ENGINEERING
701 W. MARKHAM
LITTLE ROCK, ARKANSAS 72201

STATE OF ARKANSAS
LICENSED PROFESSIONAL ENGINEER
No. 21648
6/25/2024

DRAWN BY
B.J.
DESIGNED
B.J.
CHECKED
C.V.
DATE
6/25/2024
SCALE
1" = 20'
PROJECT NO.
02-22-DR-06
SHEET NO.
C4

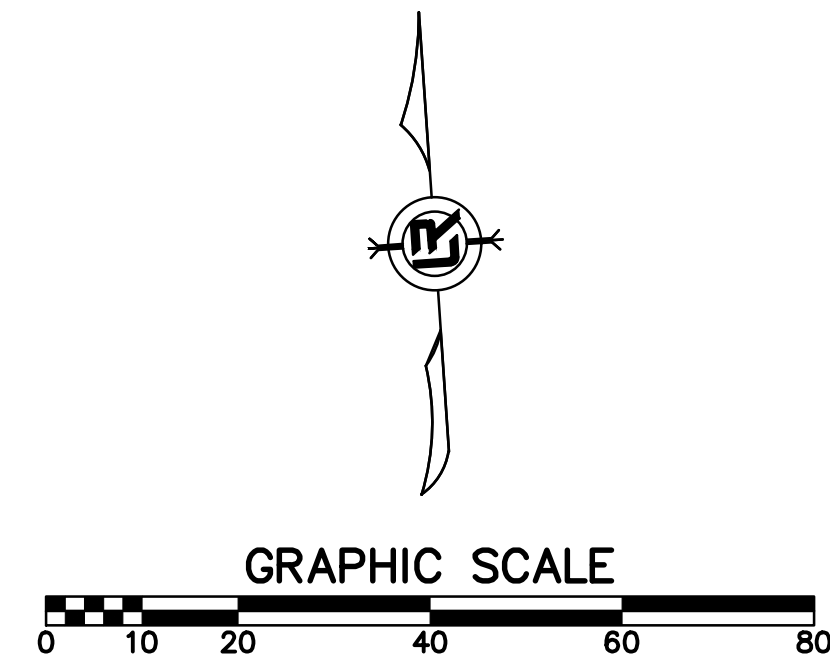
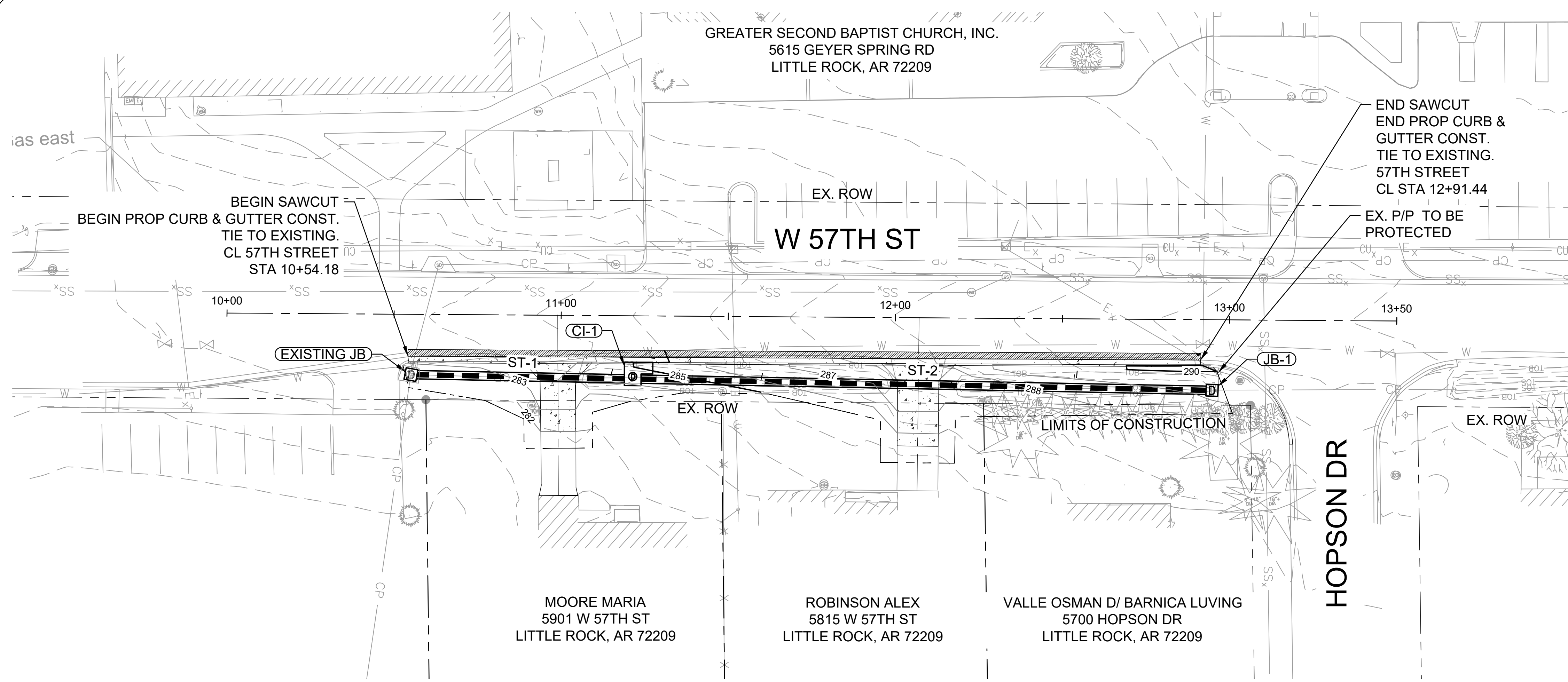

- NOTES:
1. REFER TO CITY OF LITTLE ROCK STANDARD DETAILS FOR DRAINAGE DETAILS.
 2. FOR CURB AND GUTTER DETAILS REFER TO CITY OF LITTLE ROCK STANDARD DETAIL PW-29 CURB & GUTTER SECTIONS RESIDENTIAL & COLLECTOR STREETS.

REVISIONS	DATE

CITY OF LITTLE ROCK, ARKANSAS
#57TH STREET DRAINAGE
PLAN & PROFILE

DEPARTMENT OF PUBLIC WORKS
CIVIL ENGINEERING
701 W. MARKHAM
LITTLE ROCK, ARKANSAS 72201

STATE OF ARKANSAS
LICENSED PROFESSIONAL ENGINEER
No. 21648
6/25/2024

DRAWN BY
BJ
DESIGNED
BJ
CHECKED
CV
DATE
6/25/2024
SCALE
H: 1" = 20' V: 1" = 5'
PROJECT NO.
02-22-DR-06
SHEET NO.
C5

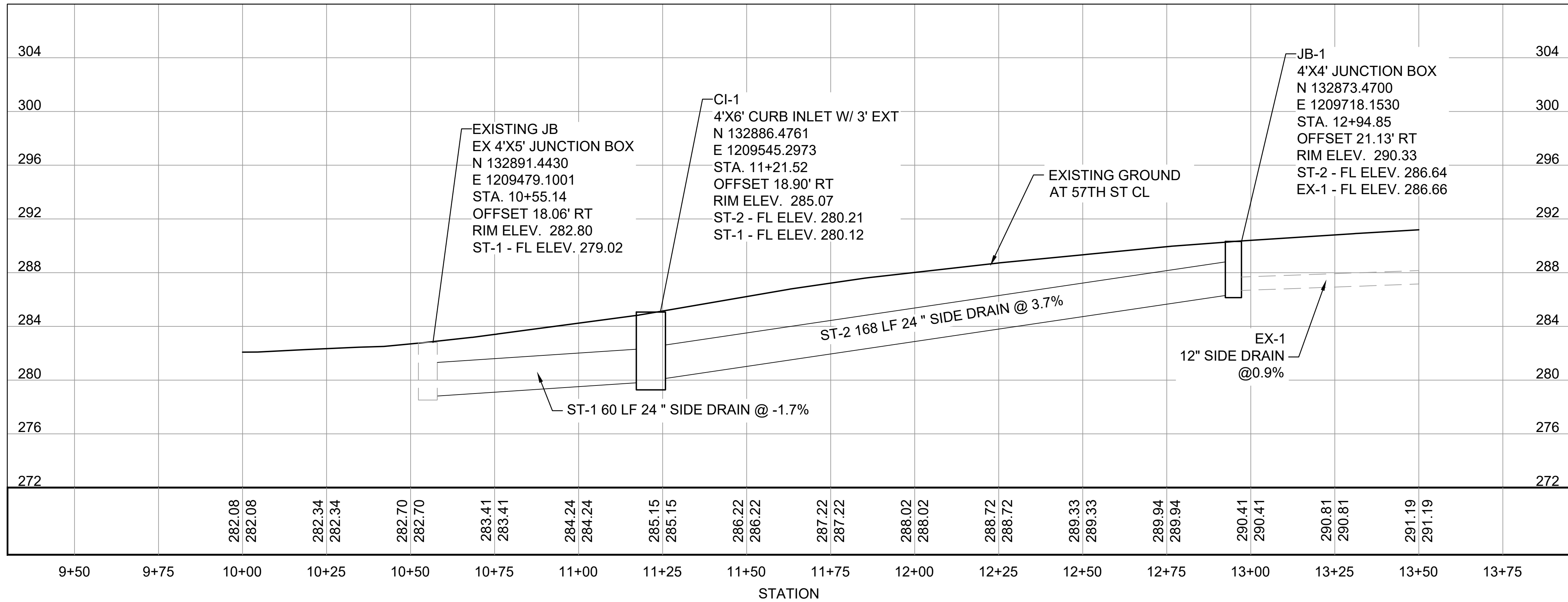

REVISIONS	DATE

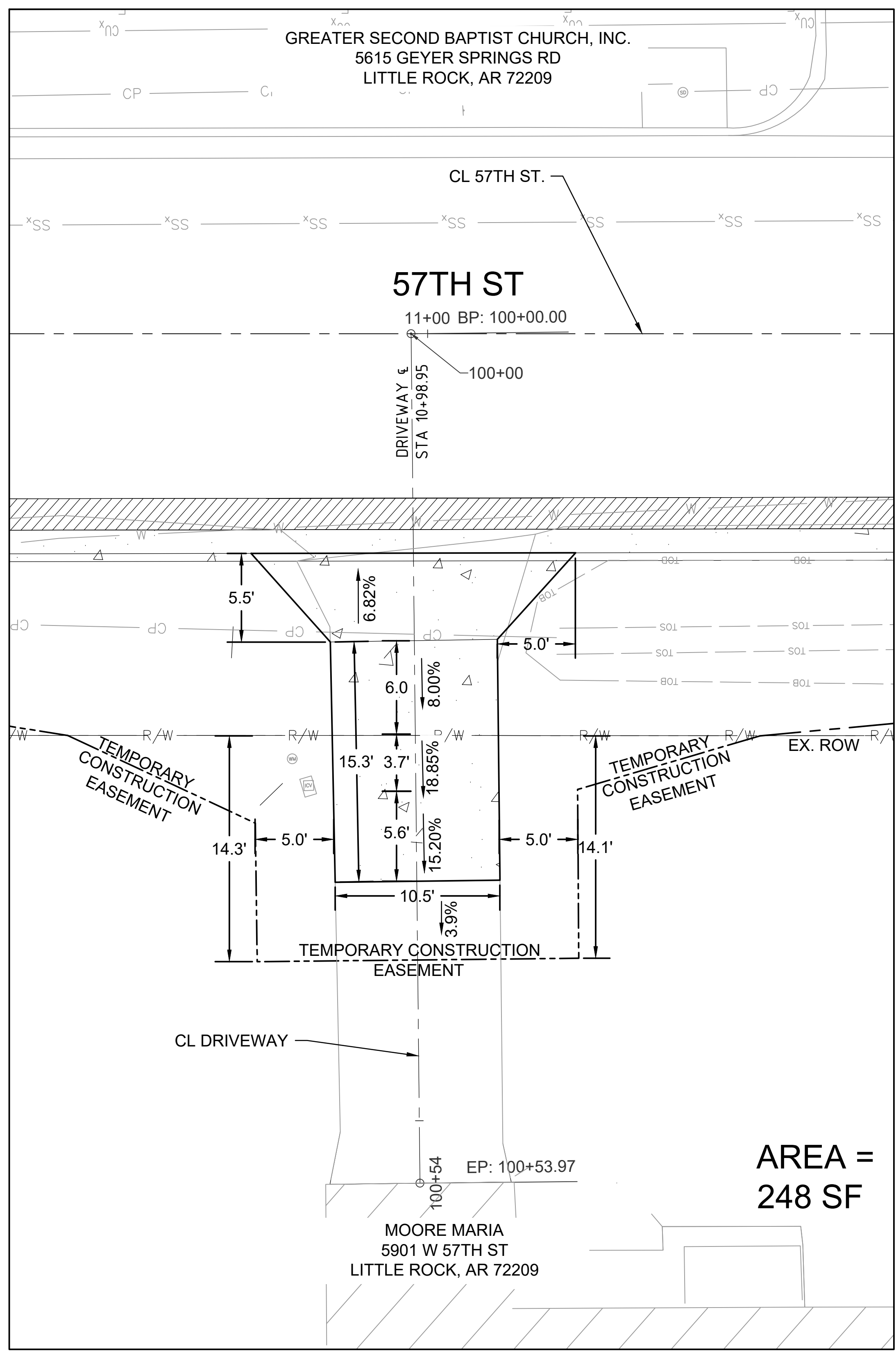

**DRIVEWAY AT
STA 10+98.95**

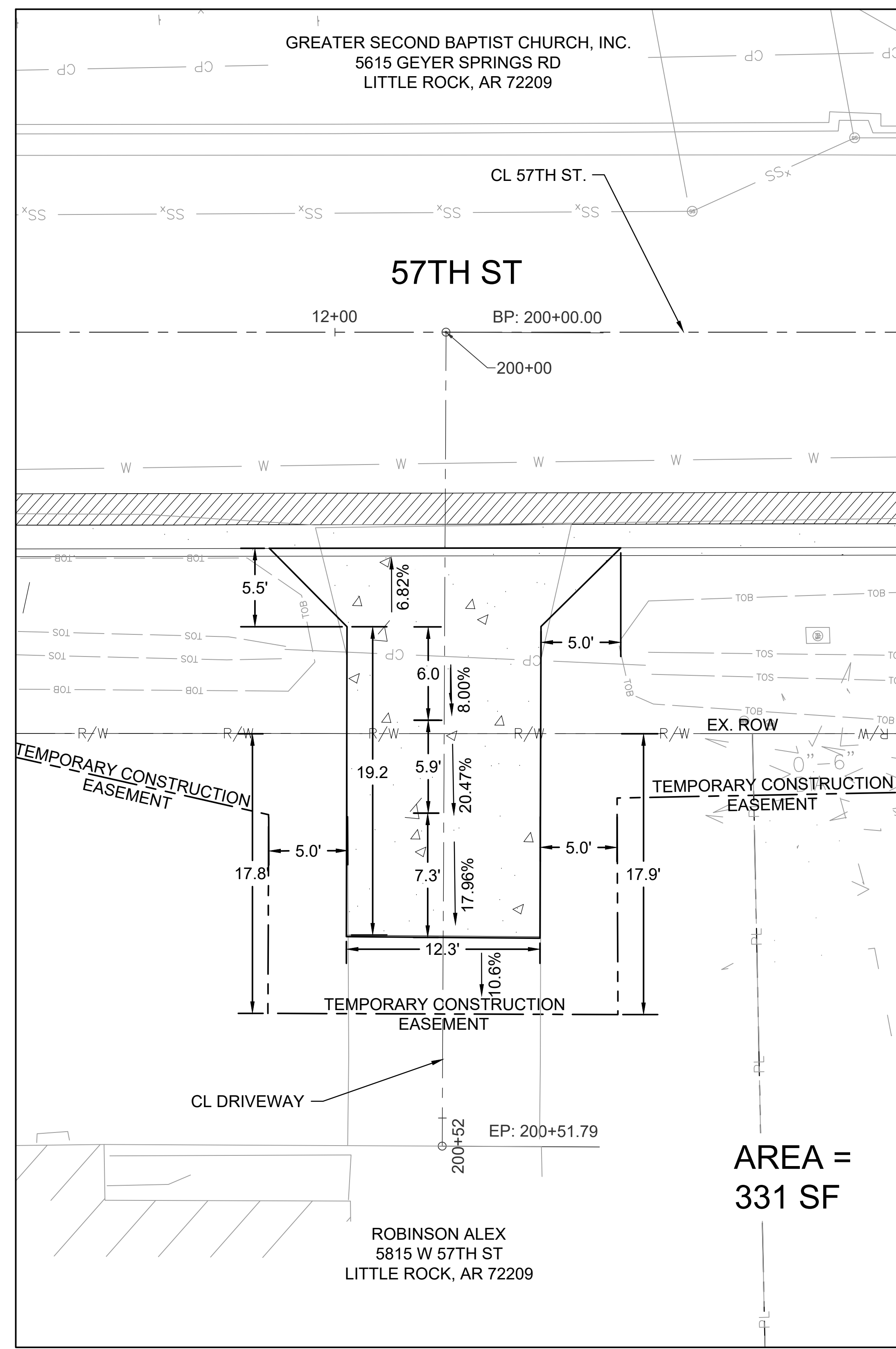

**DRIVEWAY AT
STA 12+07.07**

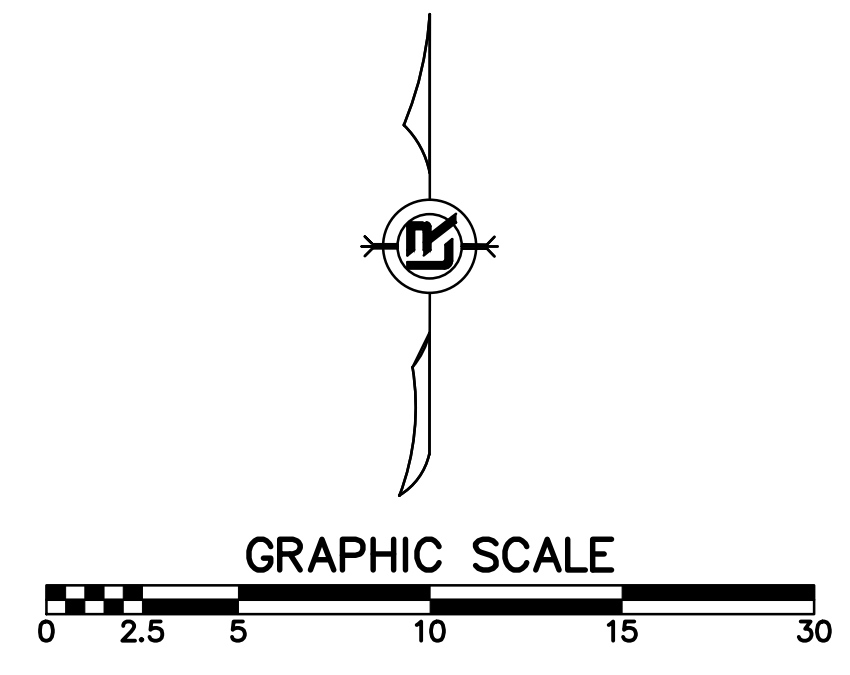

- NOTES:
1. DRIVEWAYS HAVE A 1.5" LIP AT THE FACE OF THE CURB.
 2. ALL DRIVEWAY GRADES SHALL BE ROUND WITH A 2' RADIUS.
 3. DRIVEWAY APRONS SHALL BE PLACED MONOLITHICALLY WITH GUTTER SECTION.
 4. FOR EXPANSION JOINT PLACEMENT REFER TO CITY OF LITTLE ROCK STANDARD DETAIL PW-30 RESIDENTIAL DRIVEWAY DETAILS (BUFFERED SIDEWALK)

**CITY OF LITTLE ROCK, ARKANSAS
#57TH STREET DRAINAGE
DRIVEWAY DETAILS**

DEPARTMENT OF PUBLIC WORKS
CIVIL ENGINEERING
701 W. MARKHAM
LITTLE ROCK, ARKANSAS 72201

STATE OF ARKANSAS
LICENSED PROFESSIONAL ENGINEER
No. 21648
6/25/2024

DRAWN BY BJ
DESIGNED BJ
CHECKED CV
DATE 6/25/2024
SCALE 1" = 5'
PROJECT NO. 02-22-DR-06
SHEET NO. C6

REVISIONS	DATE

CITY OF LITTLE ROCK, ARKANSAS
#57TH STREET DRAINAGE
CROSS SECTIONS

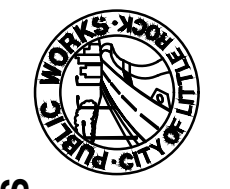

DEPARTMENT OF PUBLIC WORKS
CIVIL ENGINEERING
701 W. MARKHAM
LITTLE ROCK, ARKANSAS 72201

6/25/2024

DRAWN BY
BJ
DESIGNED
BJ
CHECKED
CV
DATE
6/25/2024
SCALE
1" = 10' H, 1" = 5V
PROJECT NO.
02-22-DR-06
SHEET NO.
C7

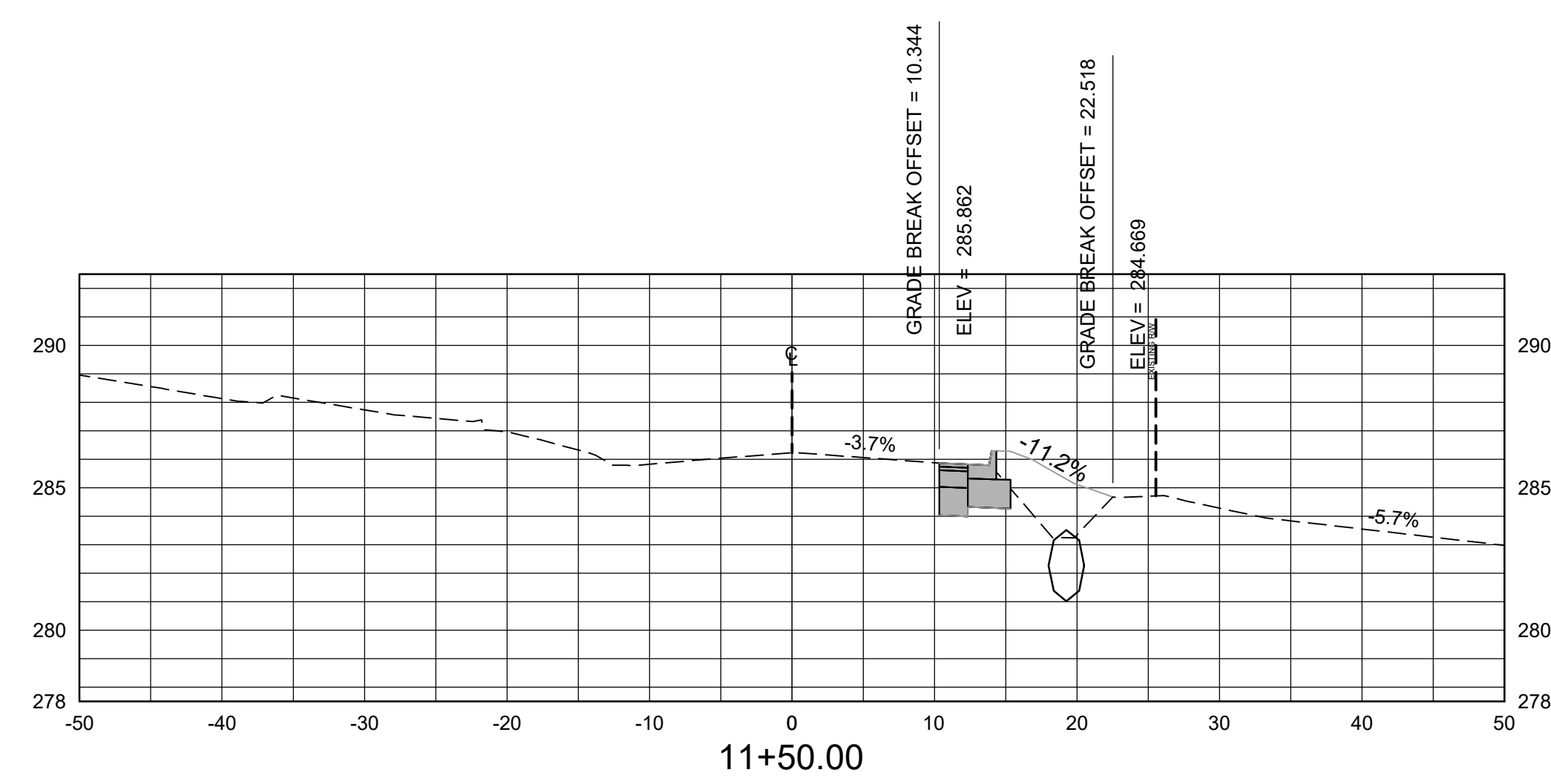

Total Volume at Station 11+50.00	
Cut Area	7.26
Fill Area	12.90
Cut Vol	15.30
Fill Vol	27.08
Cum Cut Vol	23.87
Cum Fill Vol	42.21
Net Vol	-18.34

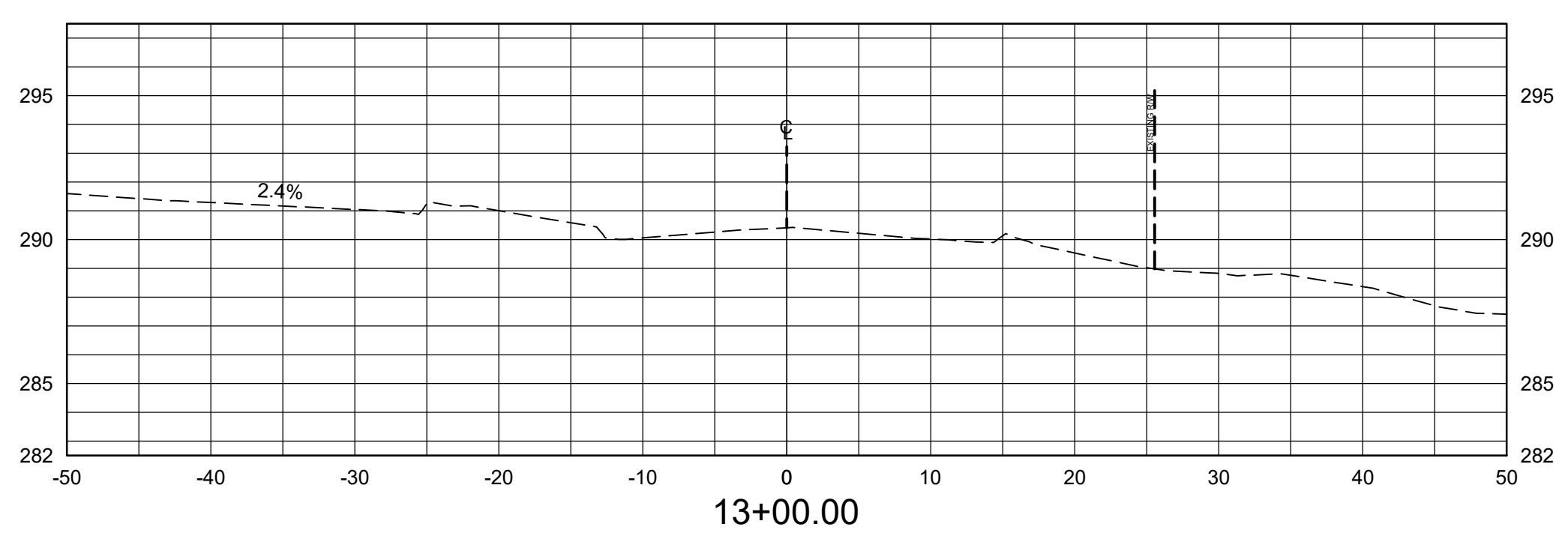

Total Volume at Station 13+00.00	
Cut Area	0.00
Fill Area	0.00
Cut Vol	7.31
Fill Vol	12.44
Cum Cut Vol	60.44
Cum Fill Vol	108.86
Net Vol	-48.42

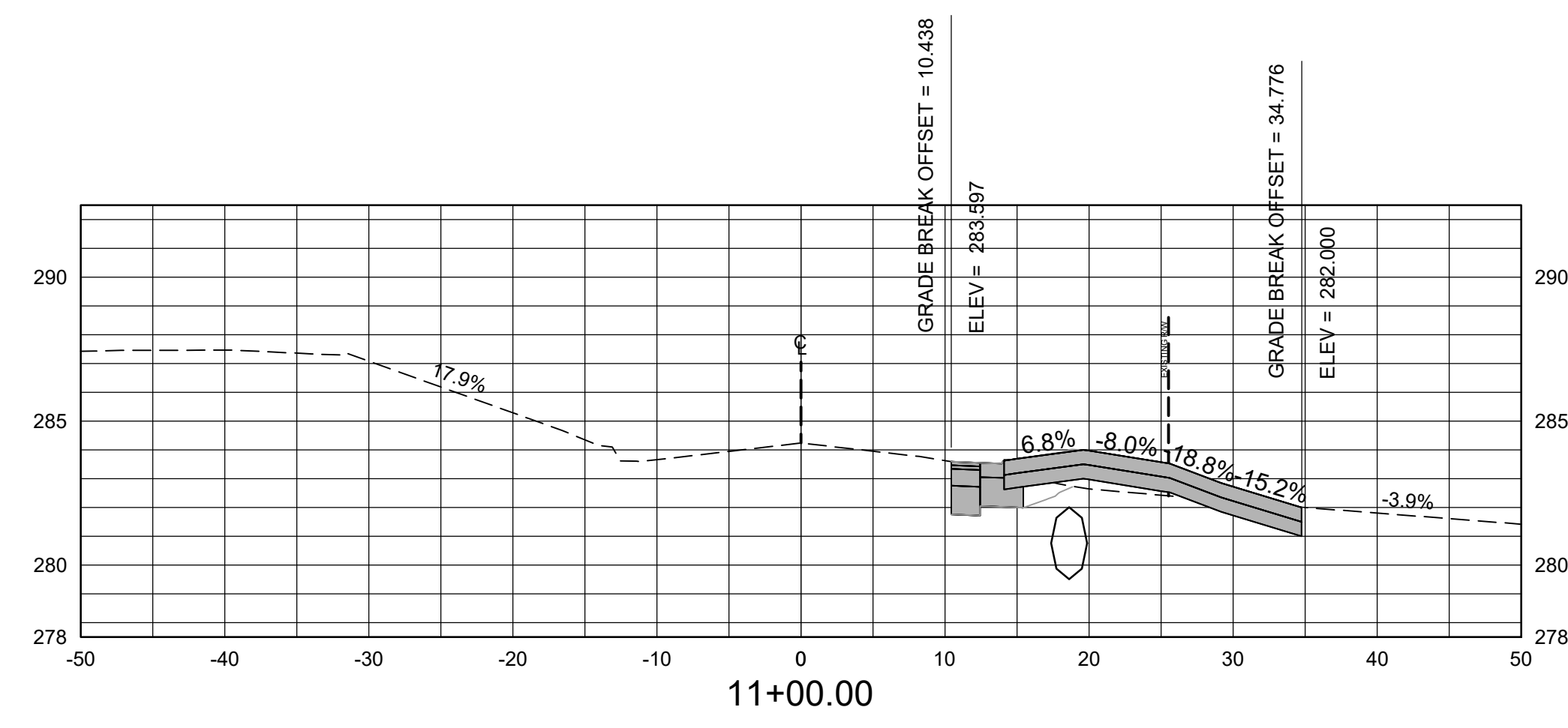

Total Volume at Station 11+00.00	
Cut Area	9.26
Fill Area	16.34
Cut Vol	8.57
Fill Vol	15.13
Cum Cut Vol	8.57
Cum Fill Vol	15.13
Net Vol	-6.56

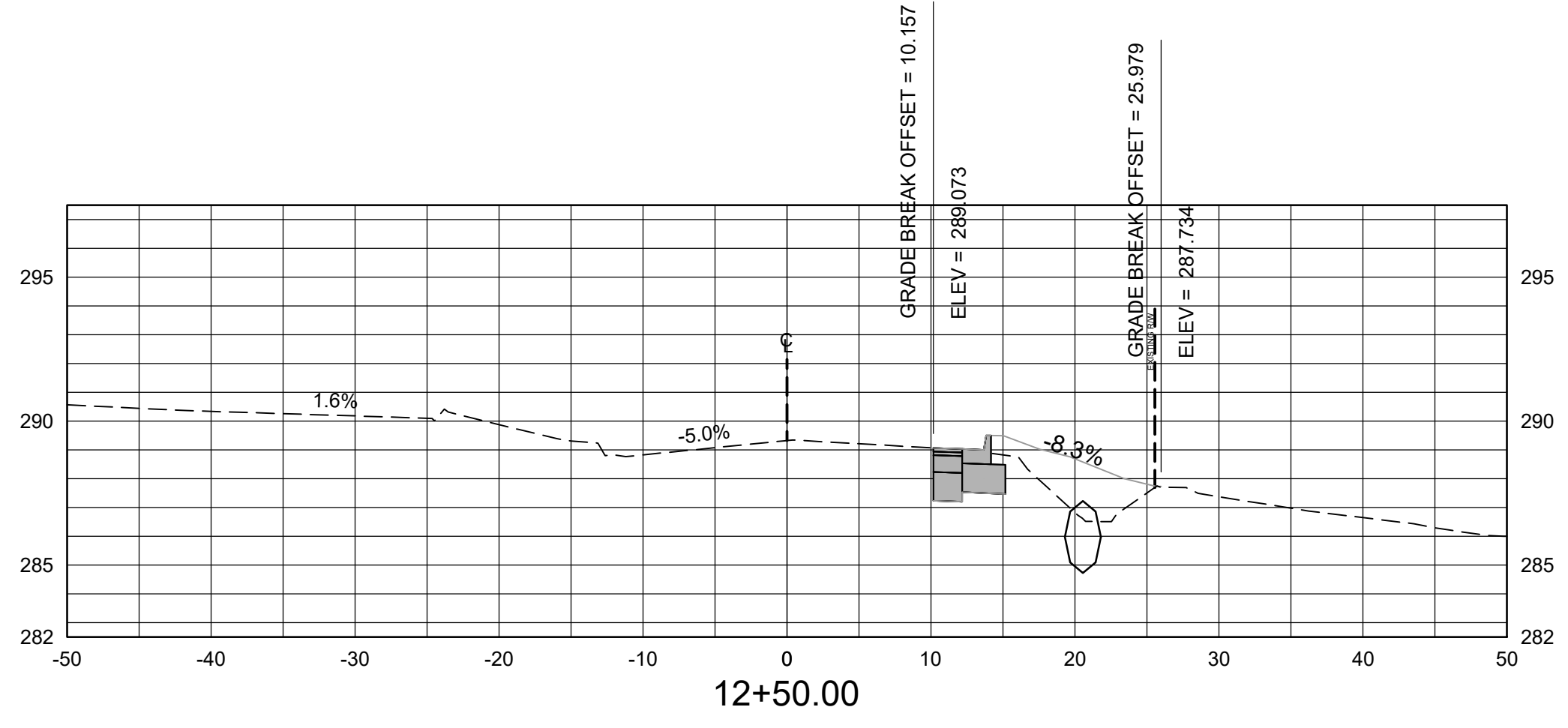

Total Volume at Station 12+50.00	
Cut Area	7.89
Fill Area	13.44
Cut Vol	14.92
Fill Vol	27.36
Cum Cut Vol	53.14
Cum Fill Vol	96.42
Net Vol	-43.29

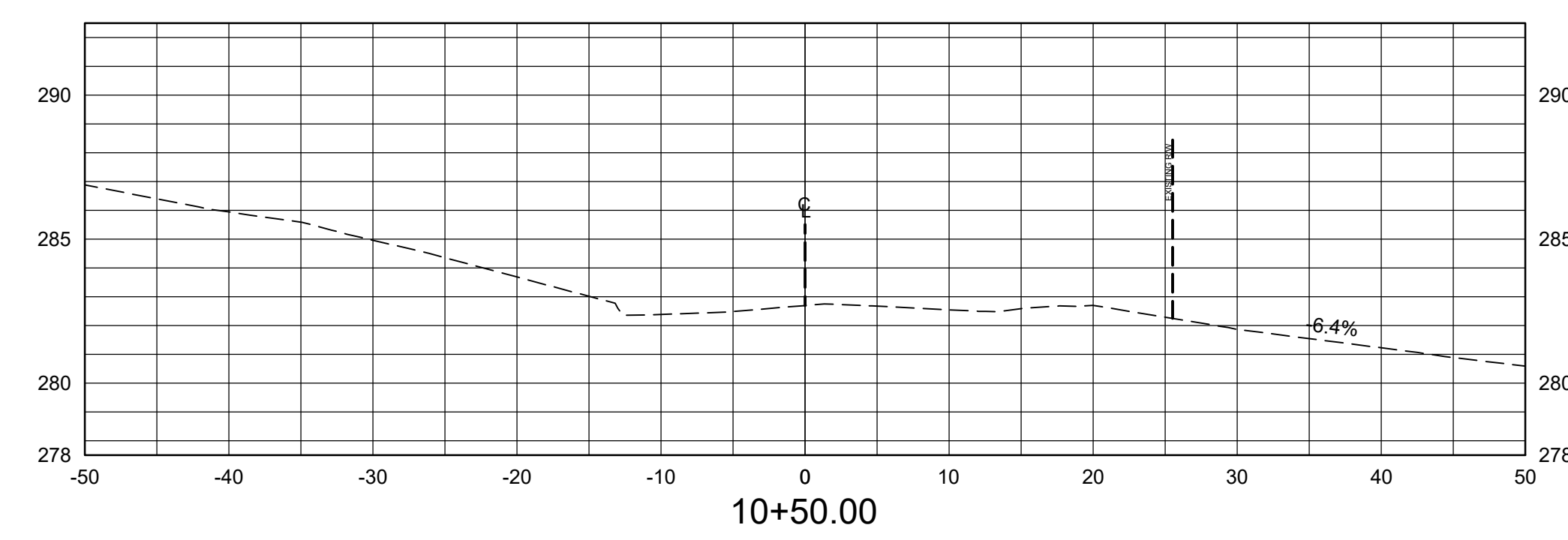

Total Volume at Station 10+50.00	
Cut Area	0.00
Fill Area	0.00
Cut Vol	0.00
Fill Vol	0.00
Cum Cut Vol	0.00
Cum Fill Vol	0.00
Net Vol	0.00

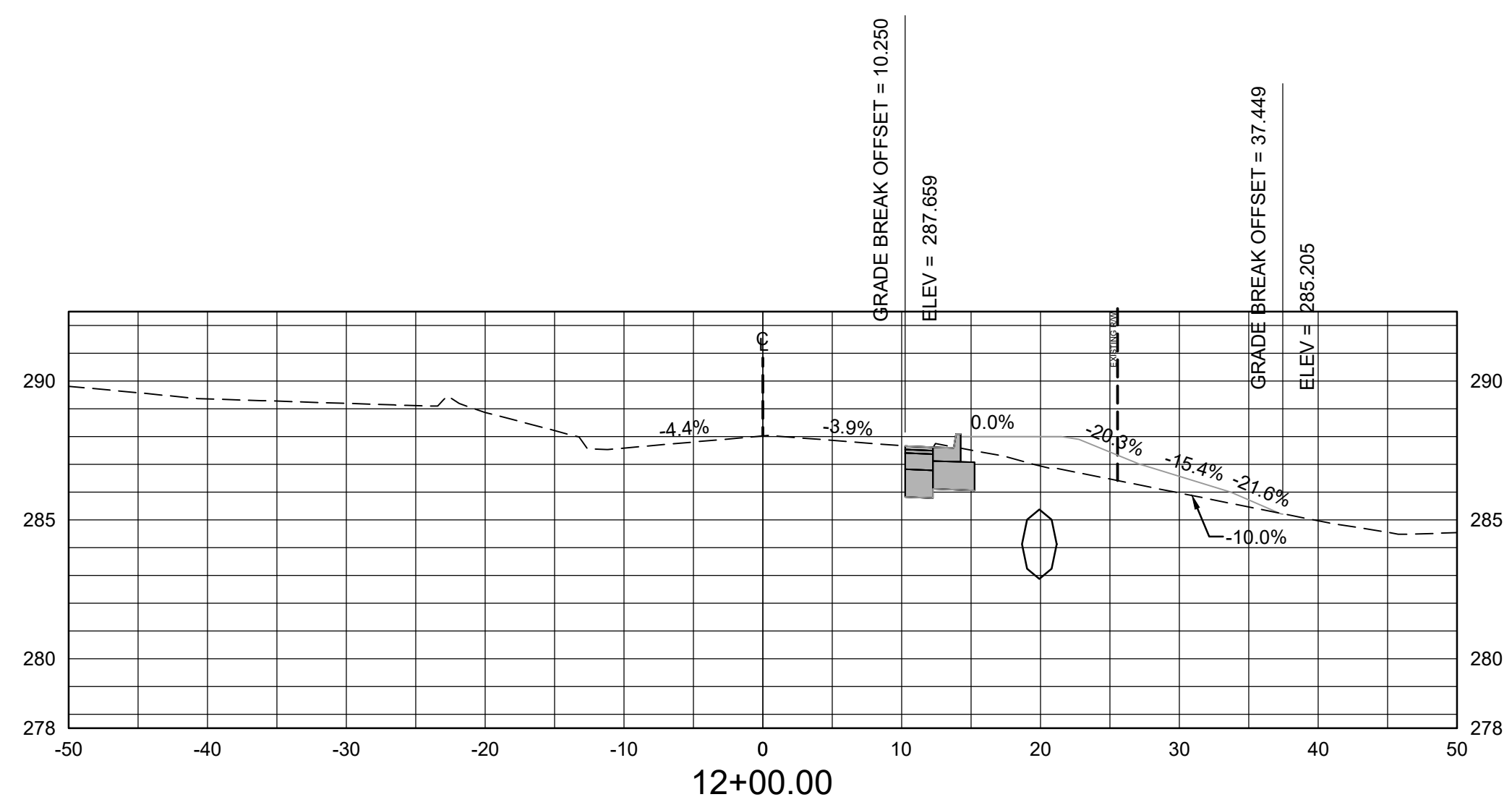

Total Volume at Station 12+00.00	
Cut Area	8.23
Fill Area	16.11
Cut Vol	14.34
Fill Vol	26.86
Cum Cut Vol	38.21
Cum Fill Vol	69.07
Net Vol	-30.86

SURVEY CONTROL POINTS LARCH ROAD							
POINT	DESCRIPTION	NORTHING	EASTING	ELEVATION	BASELINE REFERENCE	BASELINE STATION	BASELINE OFFSET
C/P #1	ALUMINUM MONUMENT 3' FROM BACK OF SOUTH CURB ON W. 57TH ST. AND 56' FROM BACK OF EAST CURB OF GEYER SPRINGS RD.	132893.5420	1209314.1830	281.38	W. 57TH ST.	N/A	25.47 RT
C/P #2	ALUMINUM MONUMENT ON THE NORTH SIDE OF W. 57TH ST.	132934.4470	1209546.5620	286.91	W. 57TH ST.	11+19.77	29.03 LT
C/P #3	ALUMINUM MONUMENT 8.5' FROM BACK OF SOUTH CURB ON W. 57TH ST. AND 111.5' FROM BACK OF EAST CURB OF GEYER SPRINGS RD.	133566.8902	1213365.8978	269.61	W. 57TH ST.	N/A	31.29 RT
C/P #4	ALUMINUM MONUMENT ON THE NORTH SIDE OF W. 57TH ST.	132913.6850	1209723.1460	290.95	W. 57TH ST.	12+97.29	19.27 LT
C/P #6	ALUMINUM MONUMENT WEST SIDE OF HOPSON DR.	132860.8010	1209737.8490	289.01	W. 57TH ST.	13+15.28	32.54 RT
C/P #7	ALUMINUM MONUMENT NORTH SIDE OF GREATER 2ND BAPTIST'S CONCRETE SIDEWALK	132983.6660	1209535.5230	288.79	W. 57TH ST.	11+05.71	77.49 LT
C/P #8	ALUMINUM MONUMENT ON THE NORTH SIDE OF W. 57TH ST.	132916.7660	1209678.9480	290.03	W. 57TH ST.	12+53.01	19.63 LT

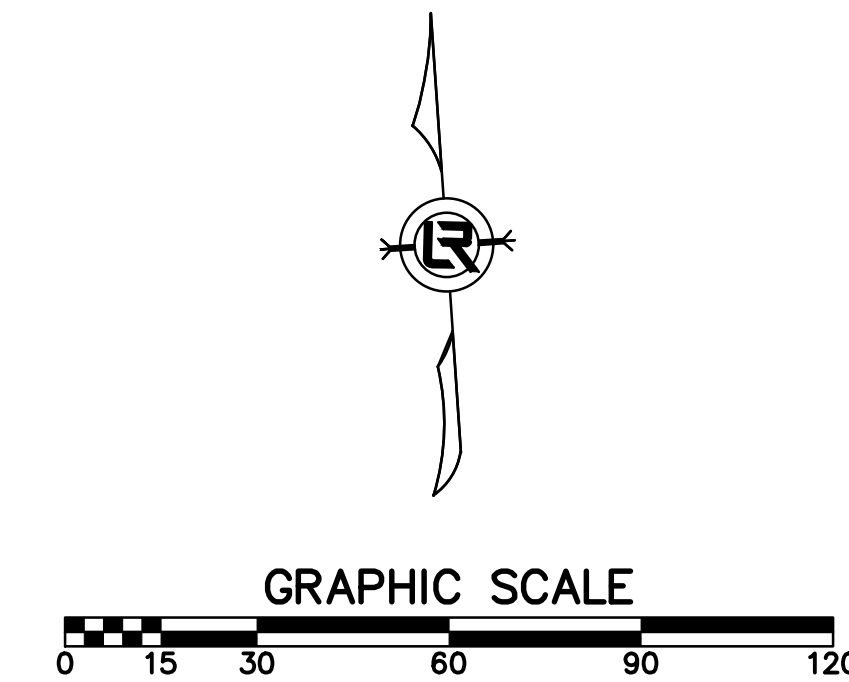

REVISIONS	DATE

CITY OF LITTLE ROCK, ARKANSAS
#57TH STREET DRAINAGE
PROJECT LAYOUT

DEPARTMENT OF PUBLIC WORKS
CIVIL ENGINEERING
701 W. MARKHAM
LITTLE ROCK, ARKANSAS 72201

STATE OF ARKANSAS
LICENSED PROFESSIONAL ENGINEER
No. 21648
6/25/2024

DRAWN BY
BJ
DESIGNED
BJ
CHECKED
CV
DATE
6/25/2024
SCALE
1" = 30'
PROJECT NO.
02-22-DR-06
SHEET NO.
C8

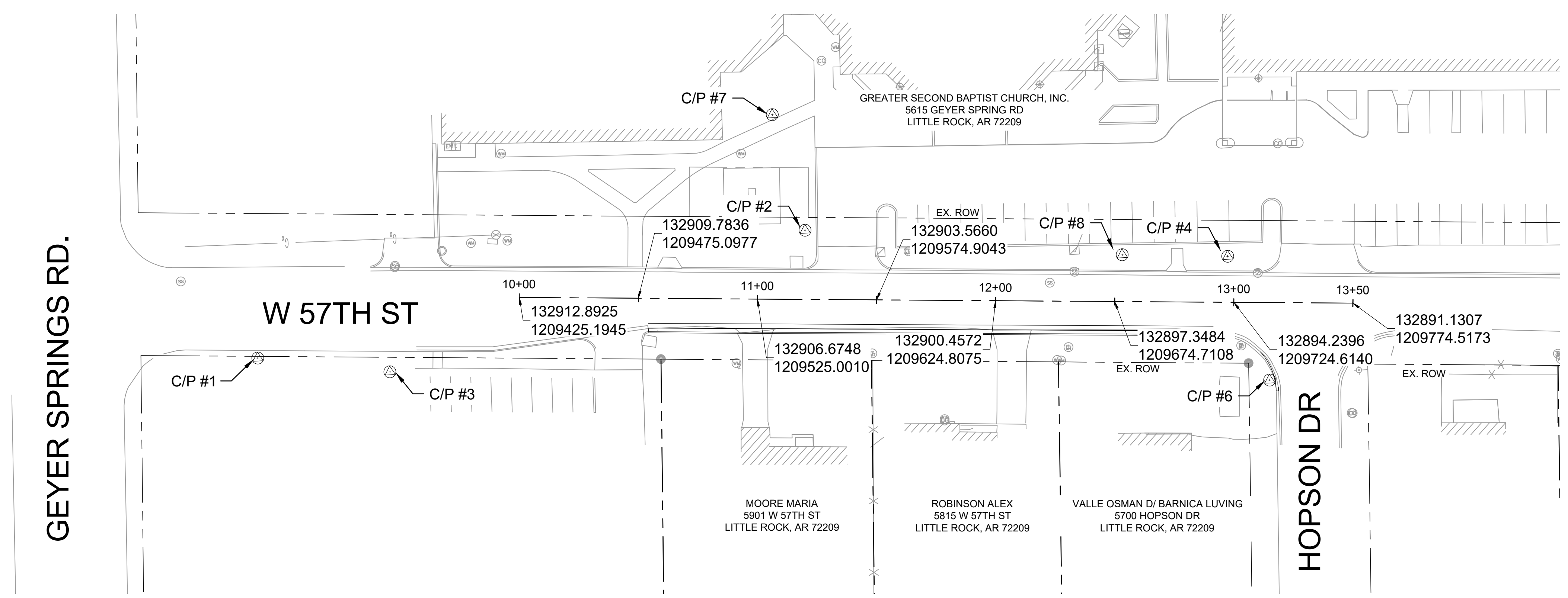

REVISIONS	DATE

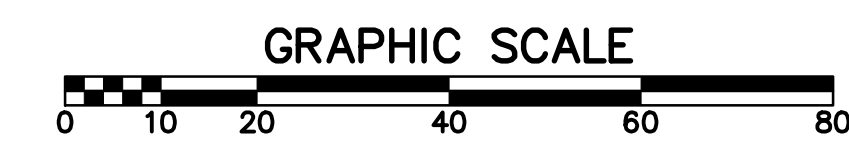
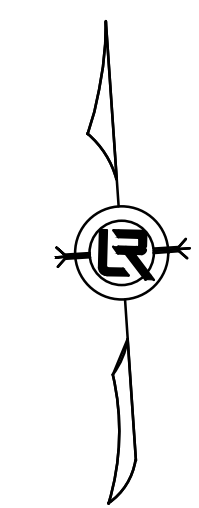

PHASING LEGEND
 PHASE 1 (INITIAL STRIP AND DEMOLITION)
 PHASE 2 (NEW DRAINAGE, CURB, ASPHALT, AND DRIVEWAY APRON CONSTRUCTED)
 PHASE 3 (RESTORE DISTURBED AREAS WITH SOD)

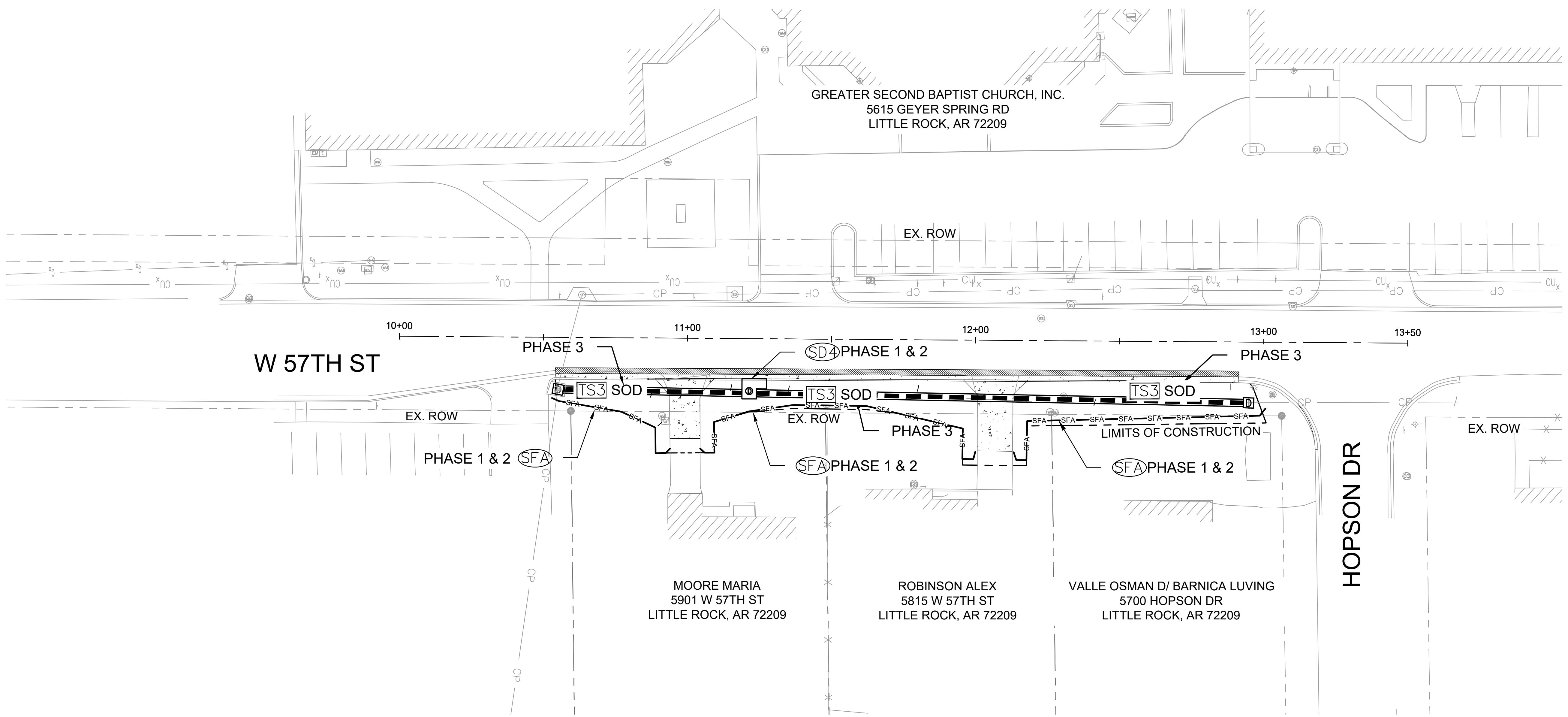

CITY OF LITTLE ROCK, ARKANSAS
 #57TH STREET DRAINAGE
 EROSION CONTROL

DEPARTMENT OF PUBLIC WORKS
 CIVIL ENGINEERING
 701 W. MARKHAM
 LITTLE ROCK, ARKANSAS 72201

STATE OF ARKANSAS
 LICENSED PROFESSIONAL ENGINEER
 No. 21648
 CHRISTOPHER J. BARNICA
 6/25/2024

DRAWN BY
 B.J.
 DESIGNED
 B.J.
 CHECKED
 C.V.
 DATE
 6/25/2024
 SCALE
 1" = 20'
 PROJECT NO.
 02-22-DR-06
 SHEET NO.
 C9