

GREEN MOUNTAIN DR. SIDEWALK IMPROVEMENTS

LITTLE ROCK, ARKANSAS

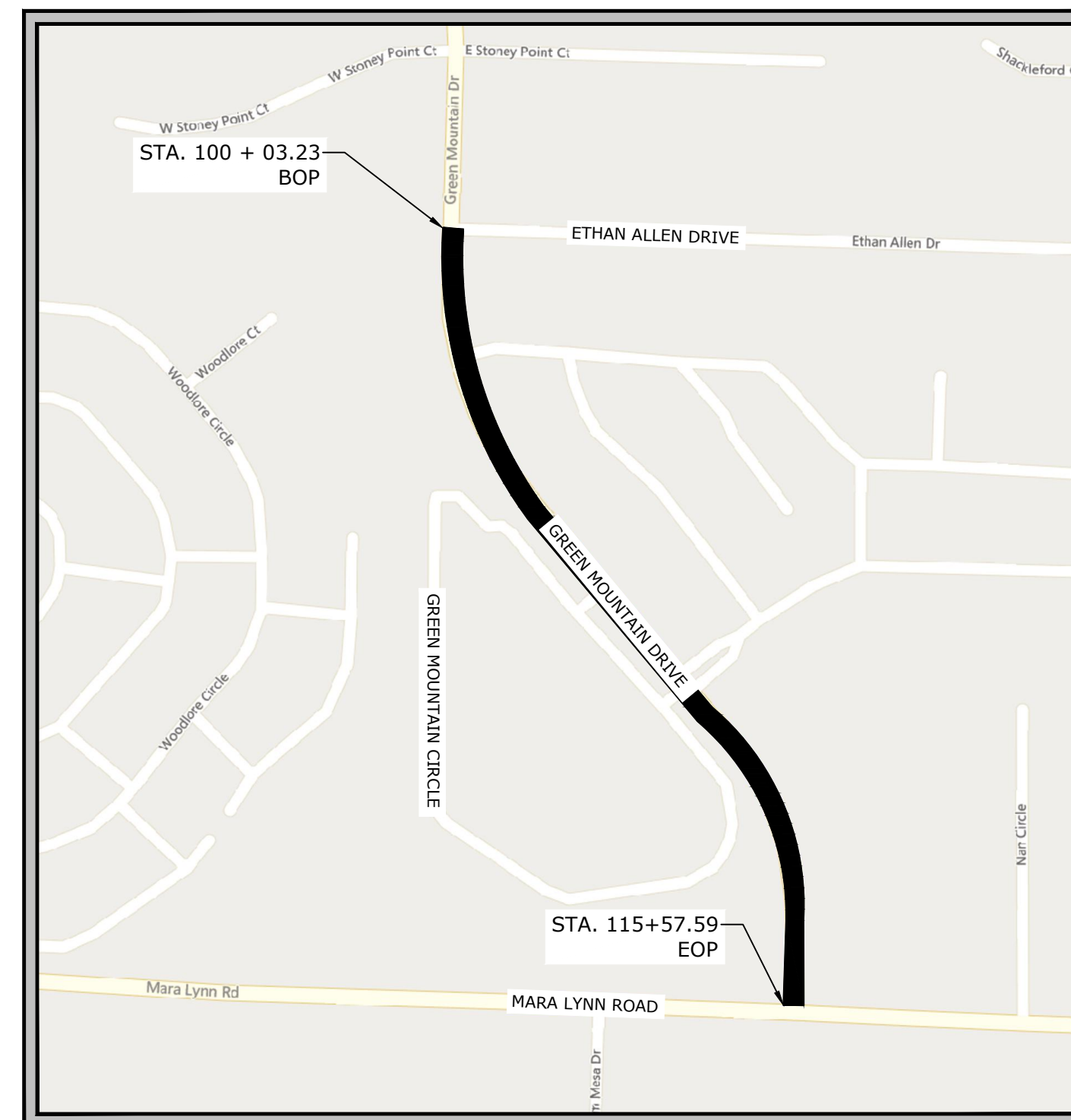

VICINITY MAP
N.T.S.

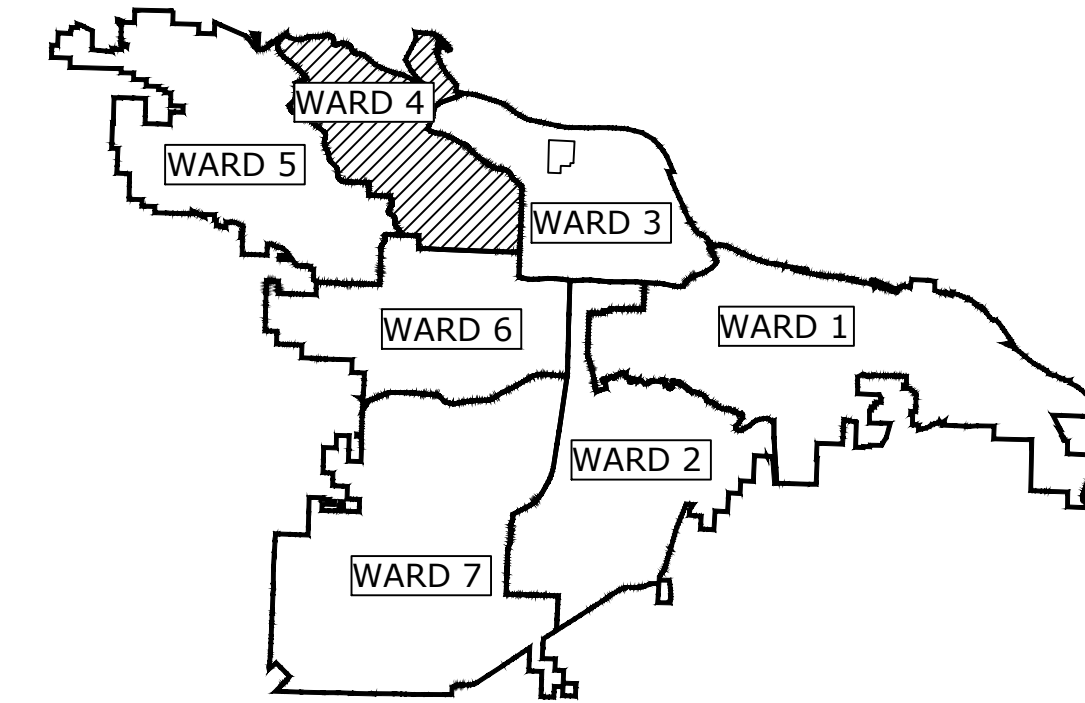

PROJECT LOCATION - WARD 4

INDEX TO DRAWINGS

- 1 COVER
- 2 TYPICAL SECTIONS
- 3 TO 6 PLAN AND PROFILE
- 7 TO 9 CROSS SECTIONS

REVISIONS DATE

CITY OF LITTLE ROCK, ARKANSAS
GREEN MOUNTAIN DR. SIDEWALK IMPROVEMENTS

COVER SHEET

DEPARTMENT OF PUBLIC WORKS
CIVIL ENGINEERING
701 W. MARKHAM
LITTLE ROCK, ARKANSAS 72201



PRELIMINARY
NOT FOR
CONSTRUCTION

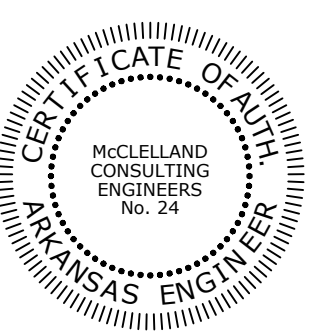

ORIGINAL SIGNATURE ON FILE

DEPARTMENT OF PUBLIC WORKS
CIVIL ENGINEERING
701 WEST MARKHAM STREET
LITTLE ROCK, ARKANSAS 72201

MCE PROJECT NUMBER 24-5756

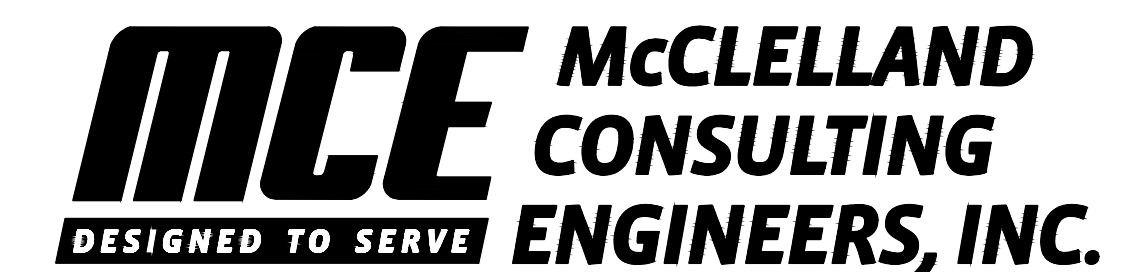

<http://www.mce.us.com>

7302 KANIS ROAD
LITTLE ROCK, ARKANSAS
(501) 371-0272

DRAWN BY
??
DESIGNED
??
CHECKED
??
DATE
??
SCALE
N.T.S.

PROJECT NO.
MCE 24-5756

SHEET NO.
C1



REVISIONS	DATE

CITY OF LITTLE ROCK, ARKANSAS
 GREEN MOUNTAIN DRIVE SIDEWALK
 ETHAN ALLEN DR. TO MARA LYNN RD.
 TYPICAL SECTIONS

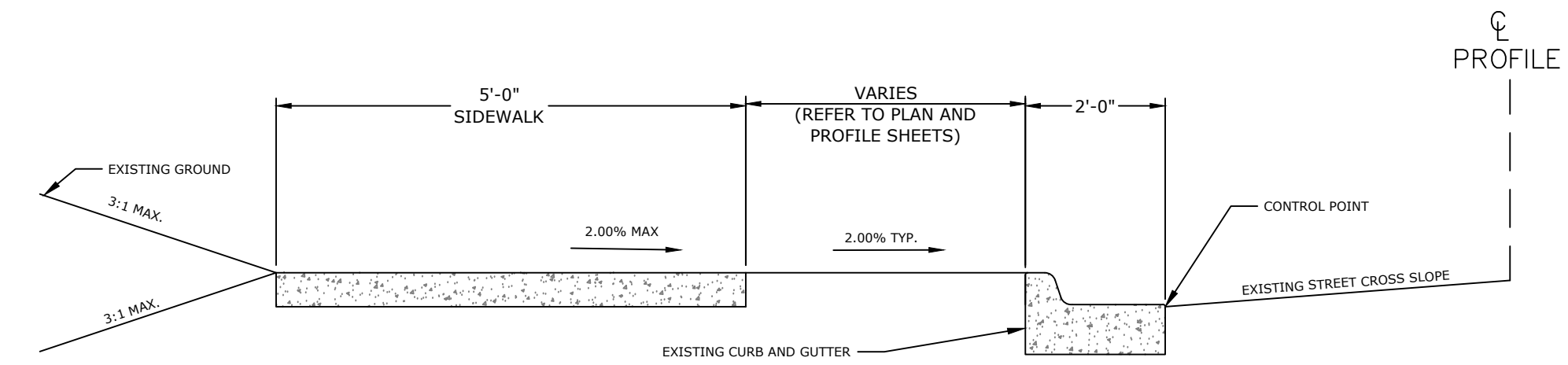

PROPOSED 5' SIDEWALK WITH GREENSPACE ON EXISTING BACK OF CURB DETAIL (WITH GUTTER)
 STA. 100+03.53' TO 100+24.11'
 STA. 100+83.89' TO 102+25.01'
 STA. 104+25.00' TO 109+27.40'
 STA. 110+79.36' TO 112+17.97'
 STA. 112+52.62' TO 112+60.26'
 STA. 114+76.17' TO 115+57.63'
 N.T.S.

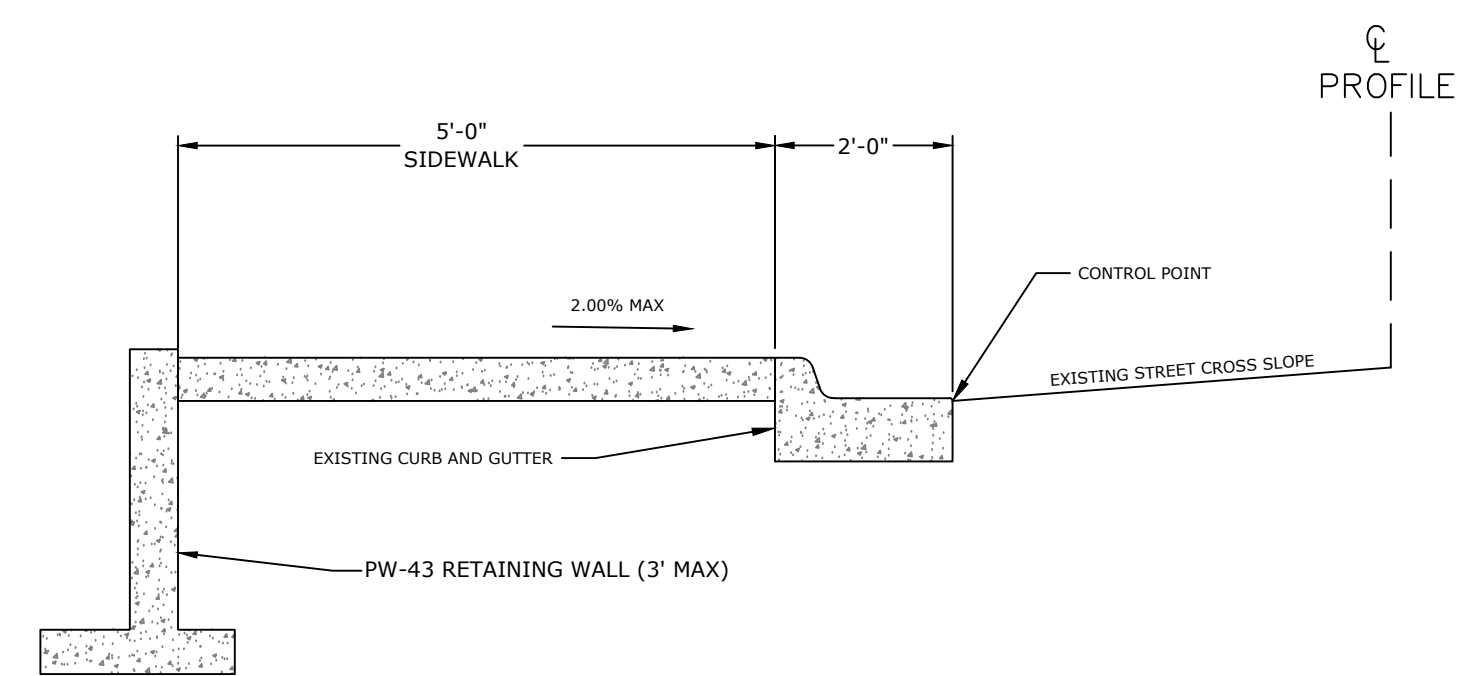

PROPOSED 5' SIDEWALK WITH GREENSPACE ON EXISTING BACK OF CURB DETAIL (WITH GUTTER)
 STA. 112+60.26' TO 114+29.46'
 N.T.S.

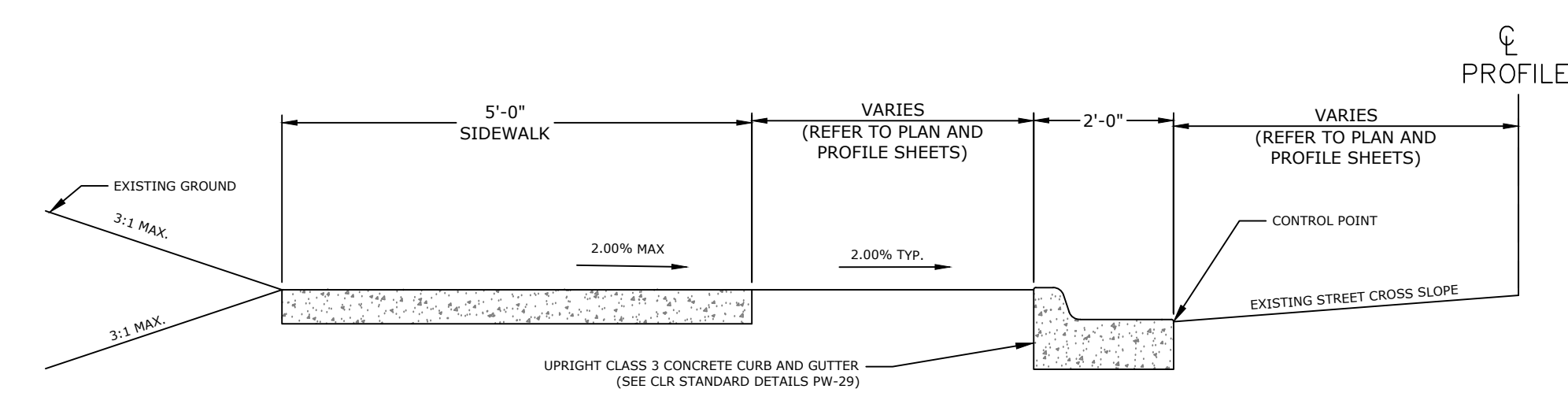

PROPOSED 5' SIDEWALK ON BACK OF PROPOSED CURB & GUTTER
 STA. 103+19.06' TO 104+25.00'
 STA. 110+28.65' TO 110+79.36'
 N.T.S.

TYPICAL SECTION GENERAL NOTES

1. PRIOR TO AND DURING PLACEMENT OF PAVEMENT IN FRONT OF THE CURB AND GUTTER, THE CONTRACTOR SHALL PROVIDE POSITIVE DRAINAGE AT ALL TIMES. THE METHOD(S) USED SHALL BE APPROVED BY THE ENGINEER. PAYMENT FOR THIS WORK SHALL BE CONSIDERED INCLUDED IN THE PRICE BID FOR THE VARIOUS CONTRACT ITEMS.
2. REFER TO CROSS SECTIONS FOR DEVIATIONS FROM NORMAL SLOPES. NO CHANGES SHALL BE MADE FROM THE PLANNED SLOPES WITHOUT THE APPROVAL OF THE ENGINEER.
3. THE THICKNESS OF AGGREGATE BASE COURSE SHALL BE WITHIN PLUS OR MINUS ONE INCH OF THE PLAN THICKNESS SHOWN. THE CONTRACTOR WILL CORRECT ANY DEFICIENT THICKNESS THAT DOES NOT MEET TOLERANCE INDICATED. PAYMENT WILL NOT BE MADE FOR MATERIAL PLACED IN EXCESS OF TOLERANCE INDICATED.

 DEPARTMENT OF PUBLIC WORKS
 CIVIL ENGINEERING
 701 W. MARKHAM
 LITTLE ROCK, ARKANSAS 72201

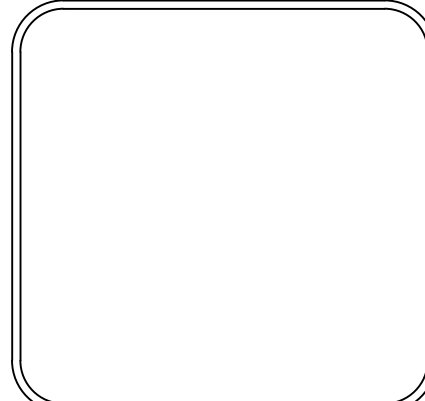

DRAWN BY
 ??
DESIGNED
 ??
CHECKED
 ??
DATE
 ??
SCALE
 N.T.S.
PROJECT NO.
 MCE 24-5756
SHEET NO.
 C2

PLAN SCALE

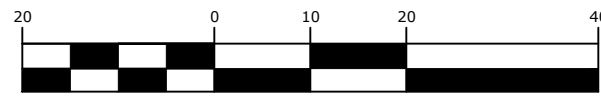

(IN FEET)
1 inch = 20ft.

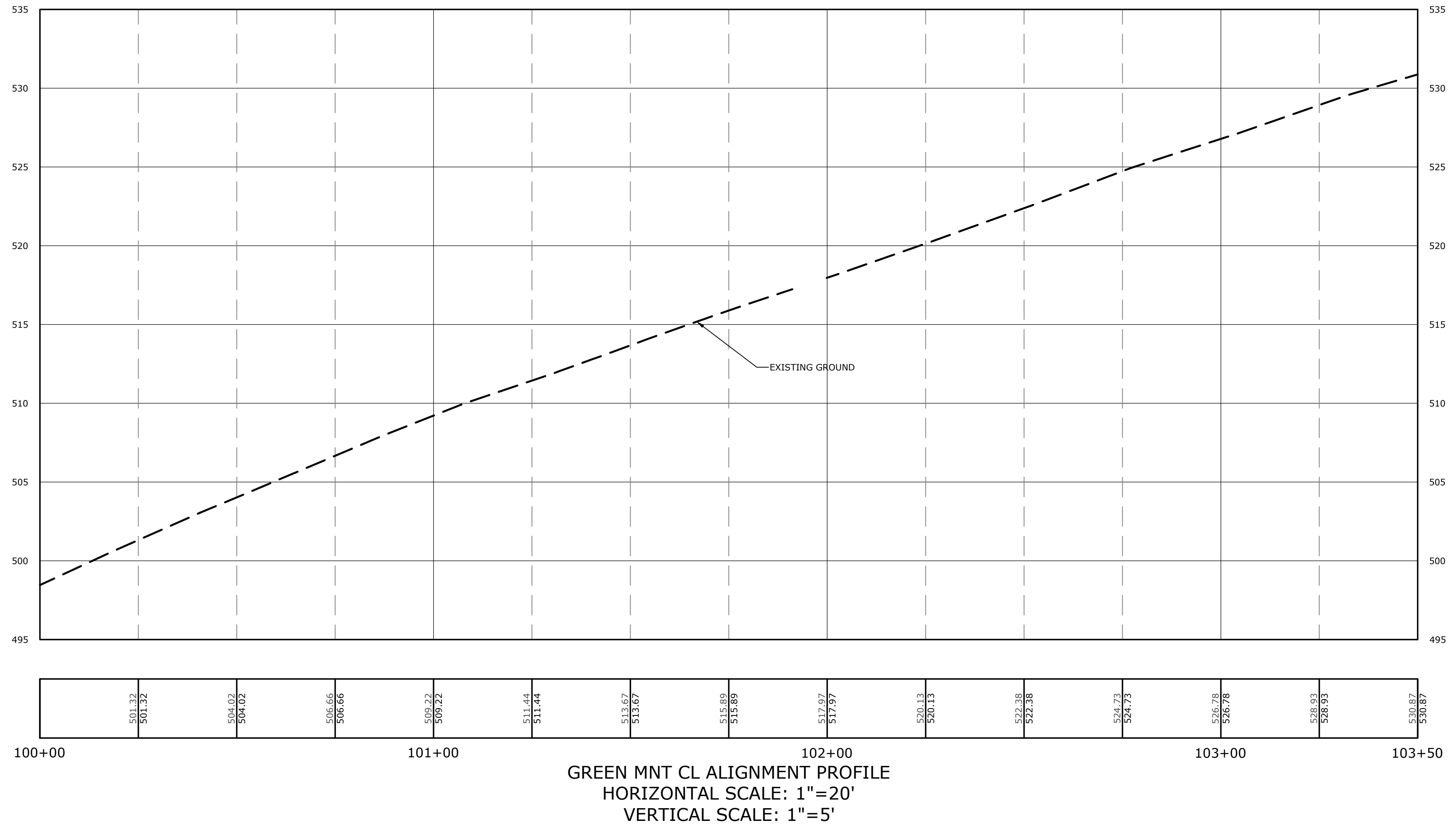
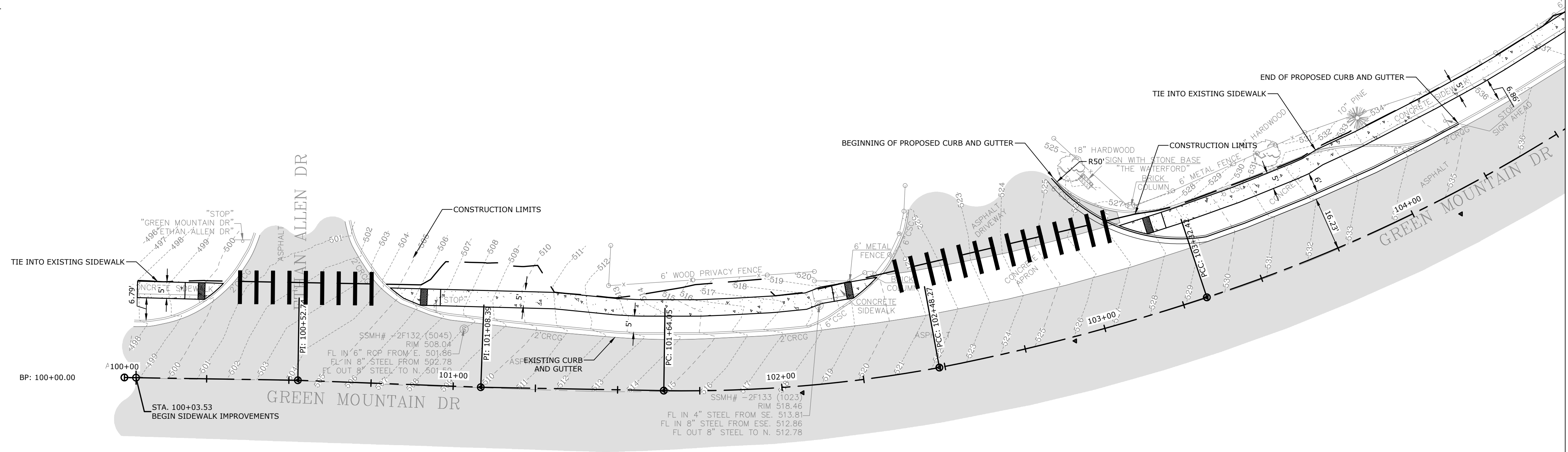
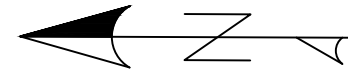

REVISIONS	DATE

CITY OF LITTLE ROCK, ARKANSAS
GREEN MOUNTAIN DRIVE SIDEWALK
ETHAN ALLEN DR. TO MARA LYNN RD.

PLAN AND PROFILE I

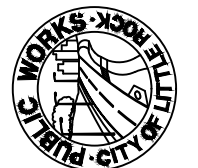
DEPARTMENT OF PUBLIC WORKS
CIVIL ENGINEERING
701 W. MARKHAM
LITTLE ROCK, ARKANSAS 72201

DRAWN BY
??
DESIGNED
??
CHECKED
??
DATE
??
SCALE
1" = 20'
PROJECT NO.
MCE 24-5756
SHEET NO.
C3

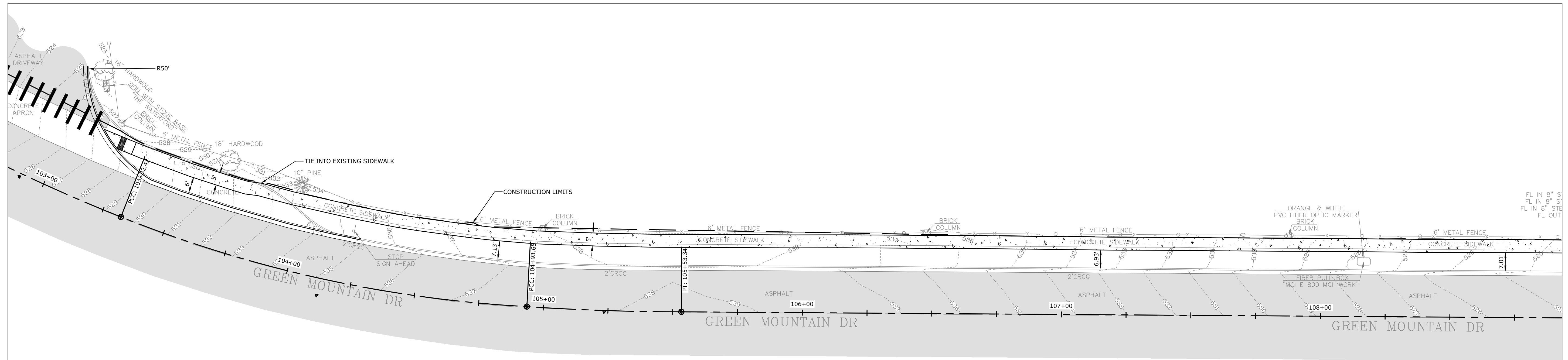

REVISIONS	DATE

CITY OF LITTLE ROCK, ARKANSAS
GREEN MOUNTAIN DRIVE SIDEWALK
ETHAN ALLEN DR. TO MARA LYNN RD.

PLAN AND PROFILE II

DEPARTMENT OF PUBLIC WORKS
CIVIL ENGINEERING
701 W. MARKHAM
LITTLE ROCK, ARKANSAS 72201

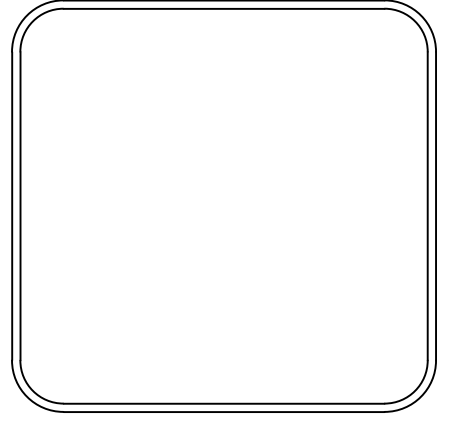

DRAWN BY ??
DESIGNED ??
CHECKED ??
DATE ??
SCALE 1" = 20'
PROJECT NO. MCE 24-5756
SHEET NO. C4

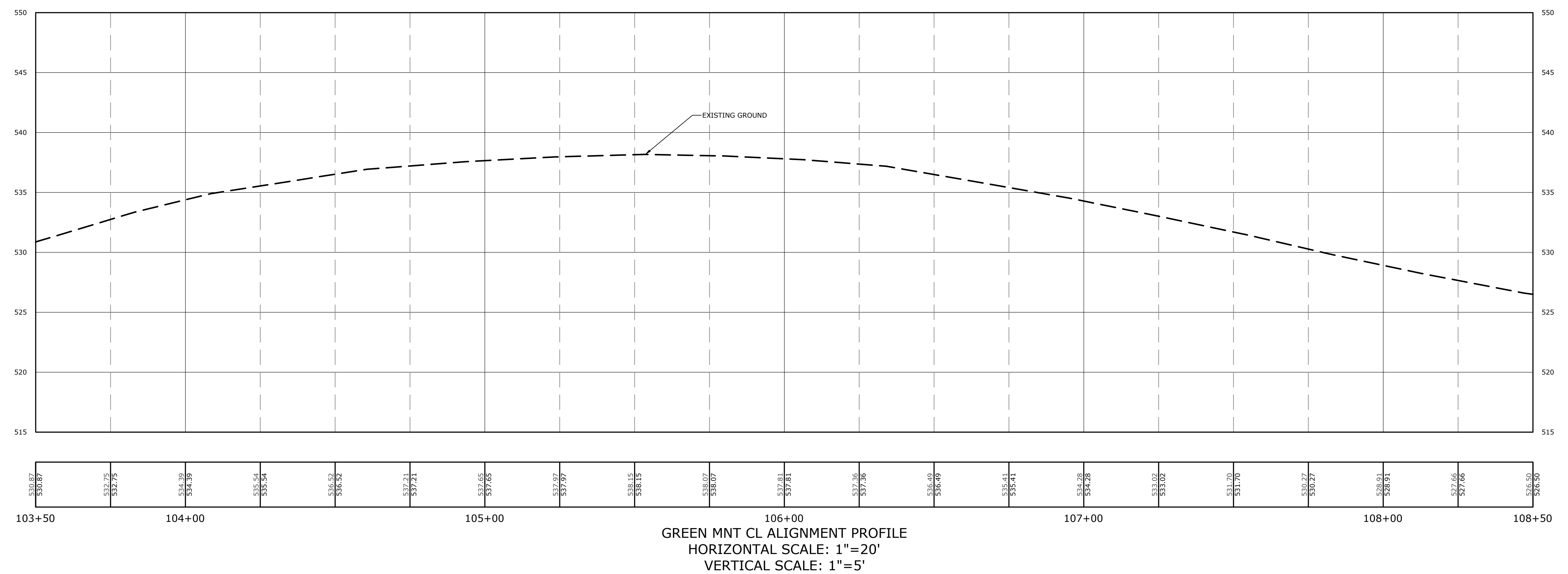

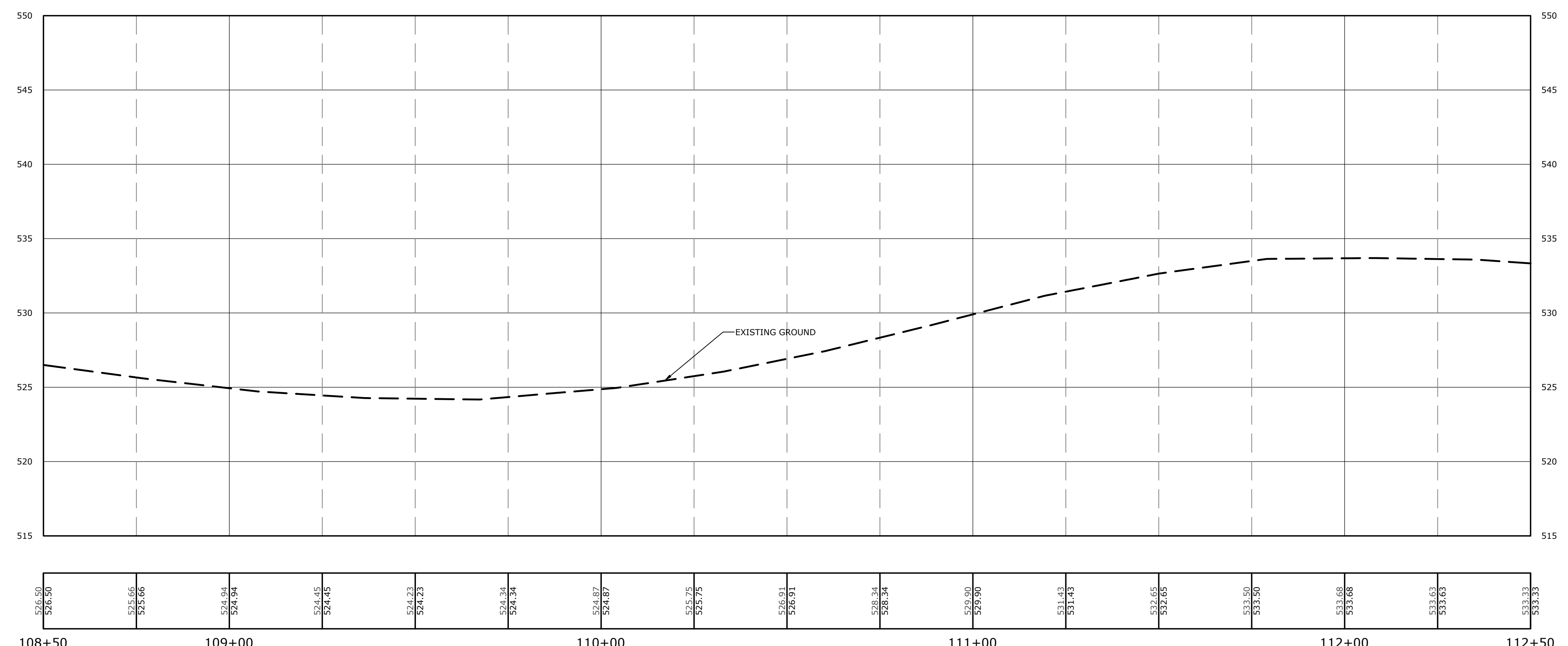
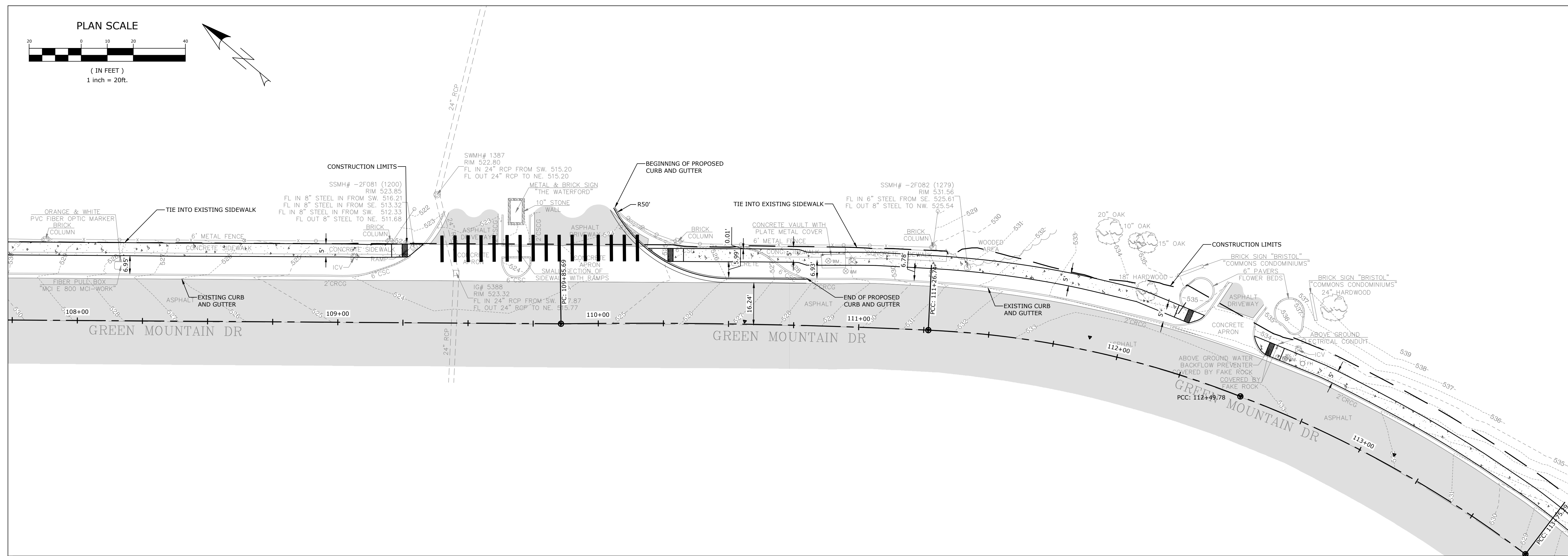
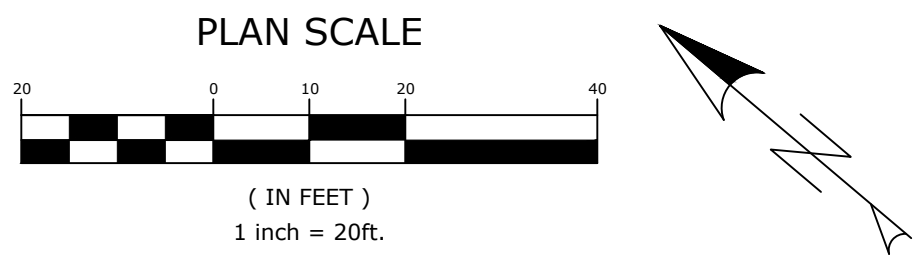

GREEN MNT CL ALIGNMENT PROFILE
 HORIZONTAL SCALE: 1"=20'
 VERTICAL SCALE: 1"=5'

REVISIONS	DATE

CITY OF LITTLE ROCK, ARKANSAS
 GREEN MOUNTAIN DRIVE SIDEWALK
 ETHAN ALLEN DR. TO MARA LYNN RD.
 PLAN AND PROFILE III

DEPARTMENT OF PUBLIC WORKS
 CIVIL ENGINEERING
 701 W. MARKHAM
 LITTLE ROCK, ARKANSAS 72201

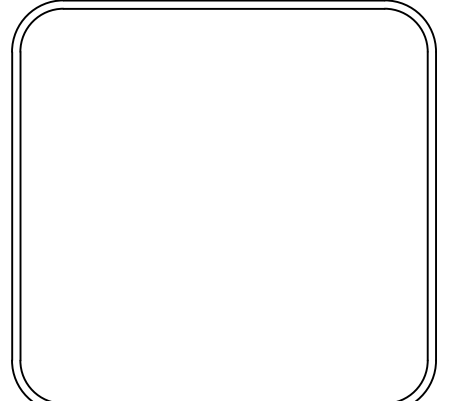

DRAWN BY ??
 DESIGNED ??
 CHECKED ??
 DATE ??
 SCALE 1"=20'
 PROJECT NO. MCE 24-5756
 SHEET NO. C5

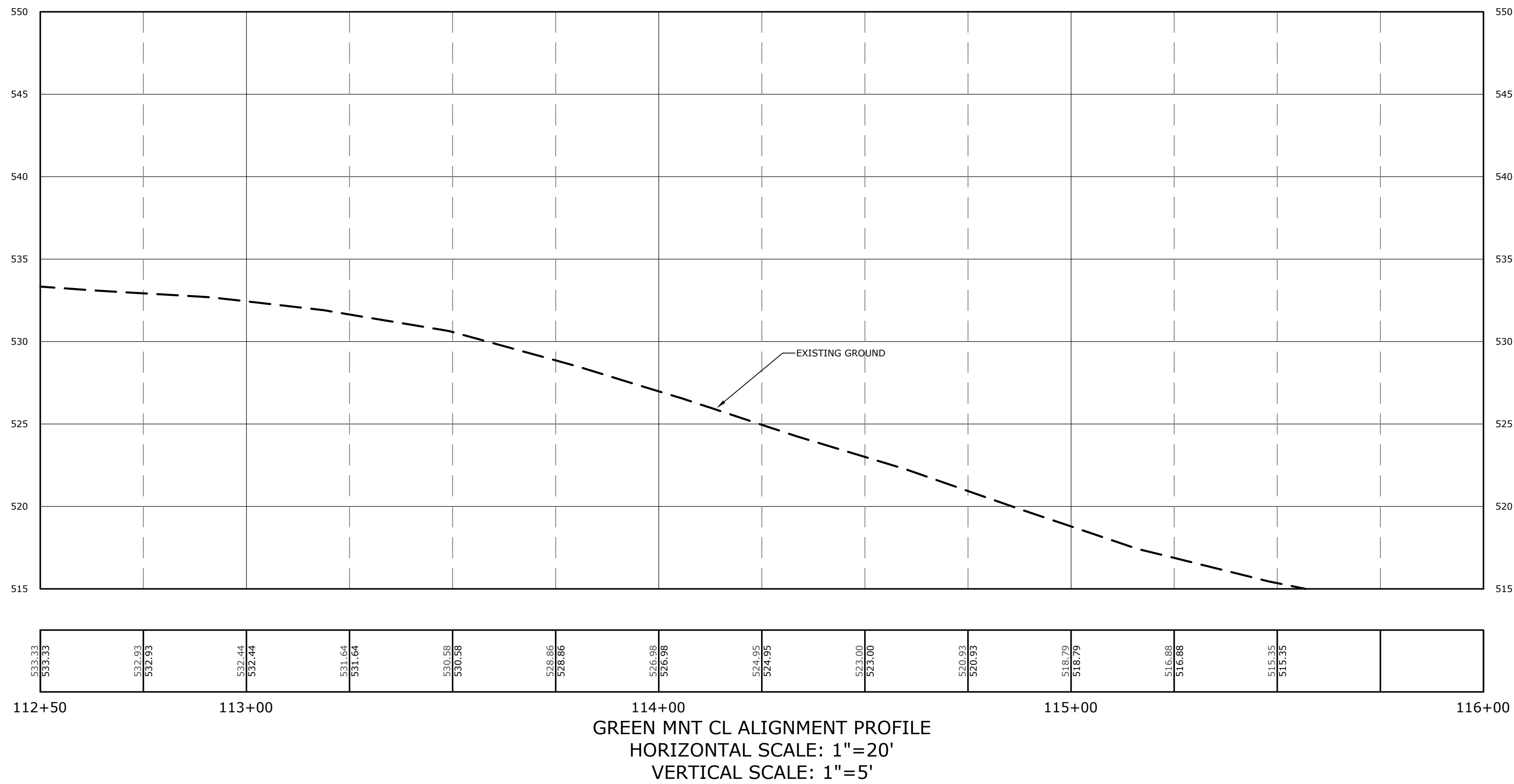
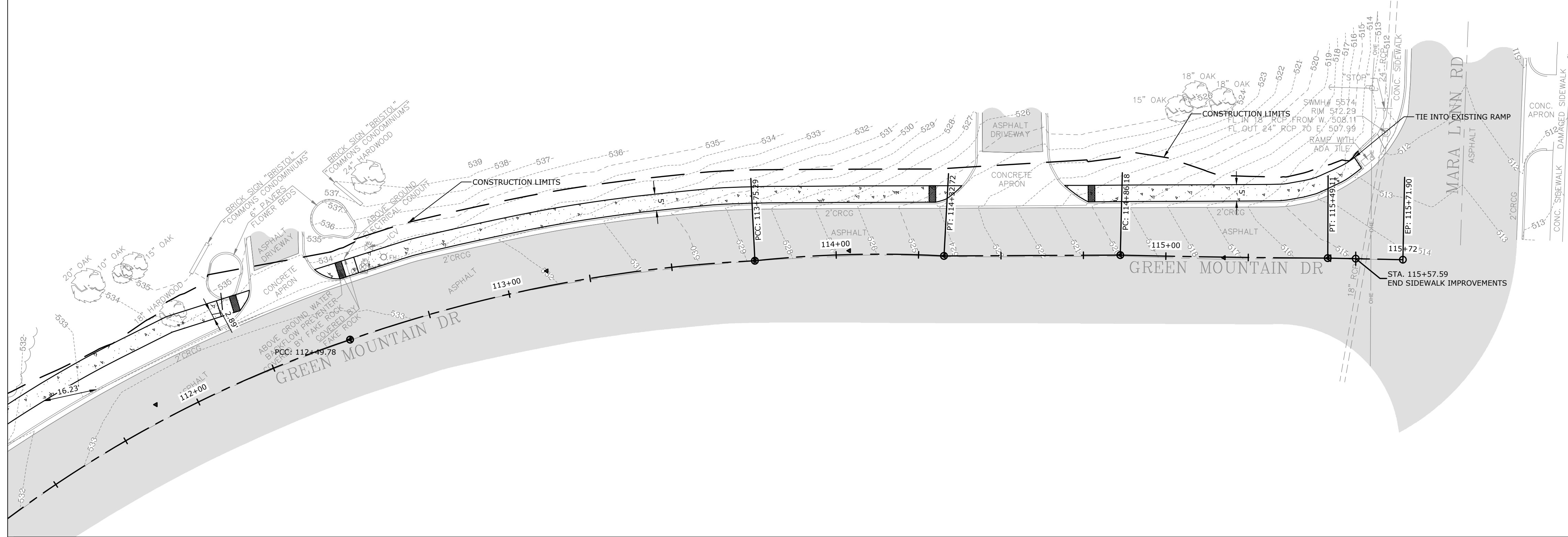
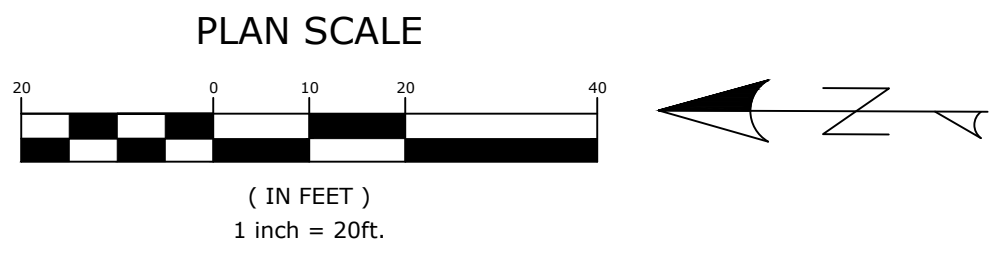

REVISIONS	DATE

CITY OF LITTLE ROCK, ARKANSAS
GREEN MOUNTAIN DRIVE SIDEWALK
ETHAN ALLEN DR. TO MARA LYNN RD.

PLAN AND PROFILE III

DEPARTMENT OF PUBLIC WORKS
CIVIL ENGINEERING
701 W. MARKHAM
LITTLE ROCK, ARKANSAS 72201

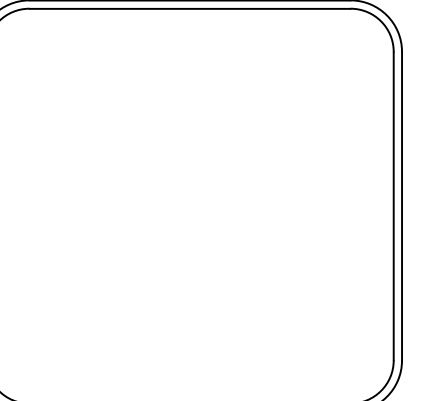

DRAWN BY
??

DESIGNED
??

CHECKED
??

DATE
??

SCALE
1" = 20'

PROJECT NO.
MCE 24-5756

SHEET NO.
C6

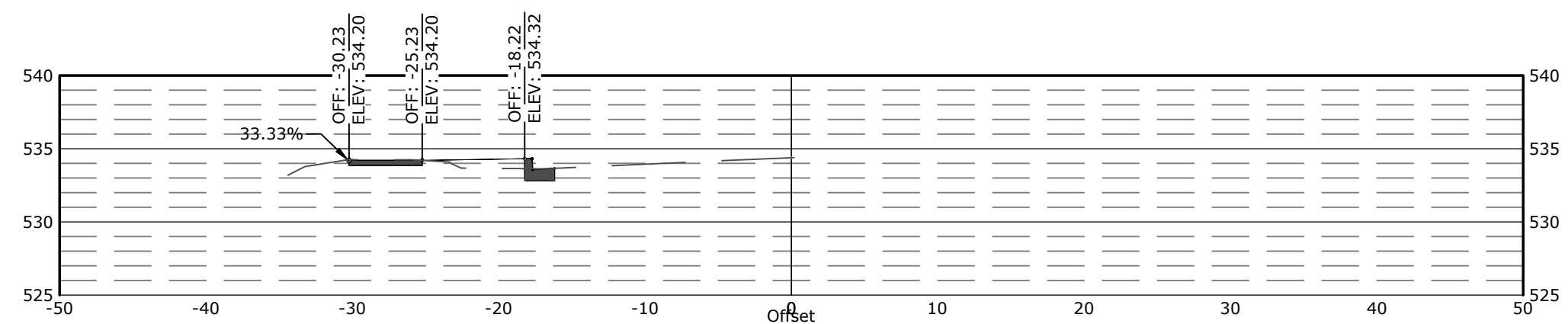

STA. 104+00.00
HORIZONTAL SCALE: 1"=20
VERTICAL SCALE: 1"=20

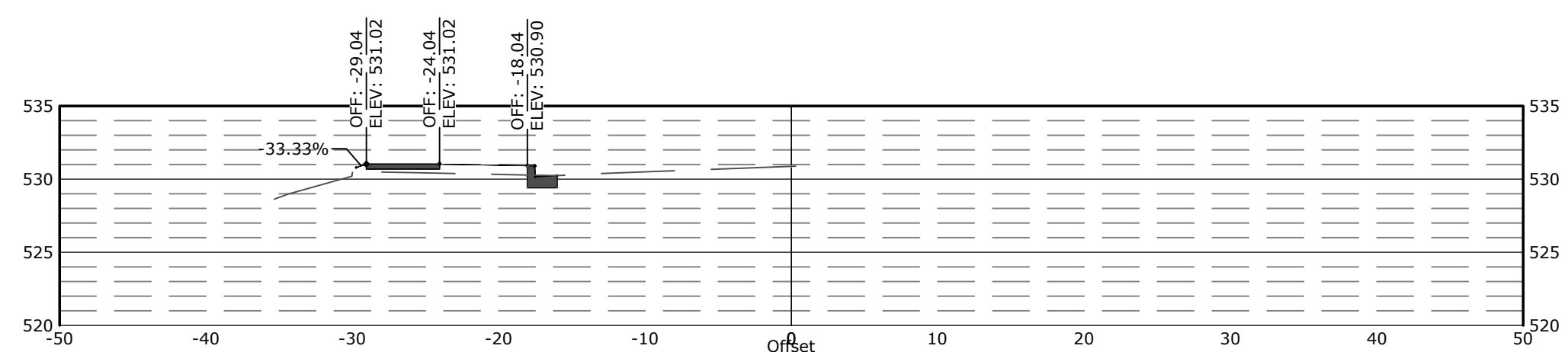

STA. 103+50.00
HORIZONTAL SCALE: 1"=20
VERTICAL SCALE: 1"=20

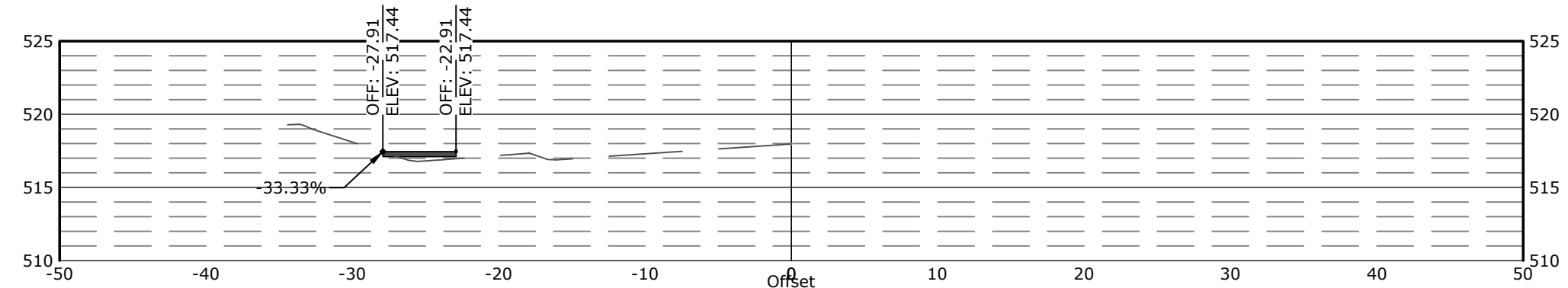

STA. 102+00.00
HORIZONTAL SCALE: 1"=20
VERTICAL SCALE: 1"=20

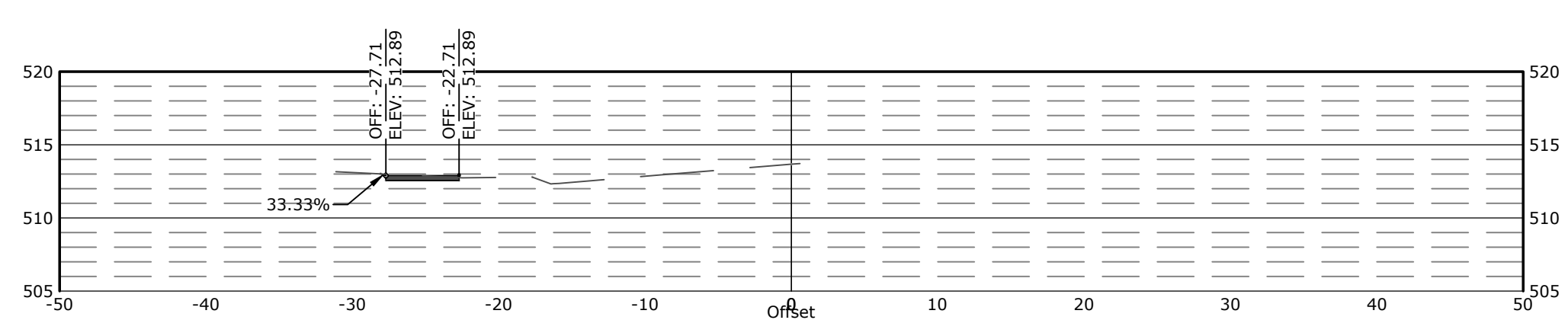

STA. 101+50.00
HORIZONTAL SCALE: 1"=20
VERTICAL SCALE: 1"=20

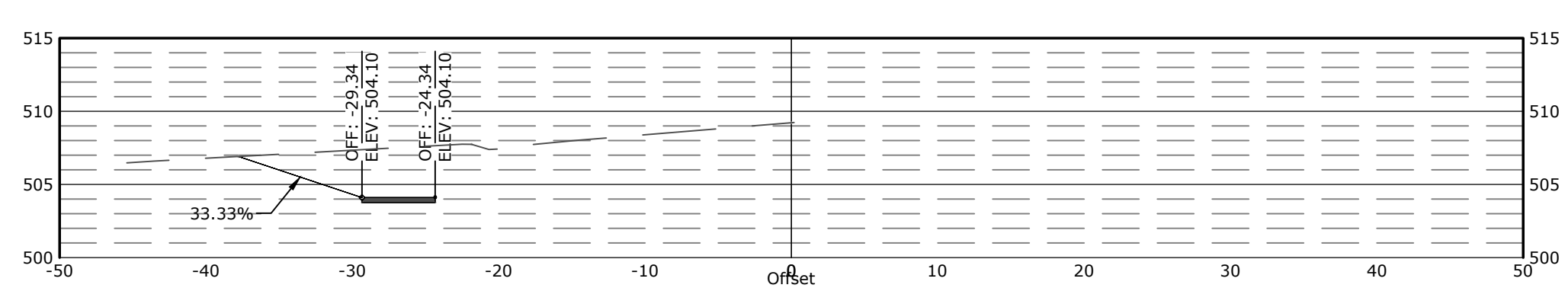

STA. 101+00.00
HORIZONTAL SCALE: 1"=20
VERTICAL SCALE: 1"=20

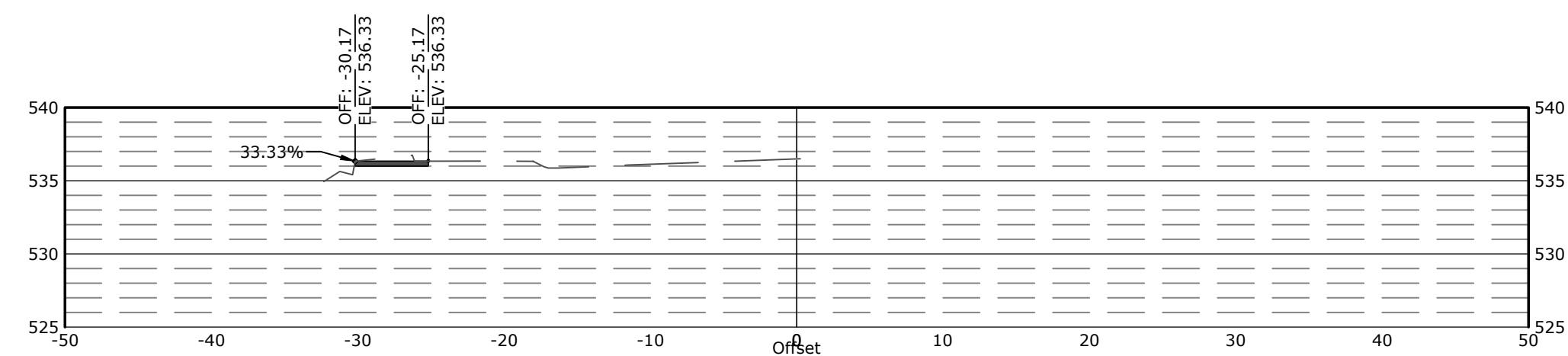

STA. 106+50.00
HORIZONTAL SCALE: 1"=20
VERTICAL SCALE: 1"=20

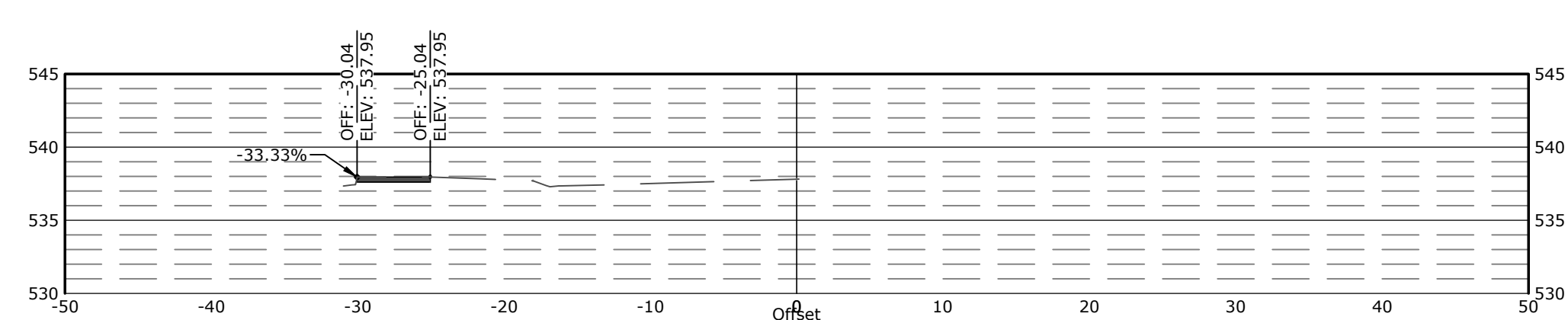

STA. 106+00.00
HORIZONTAL SCALE: 1"=20
VERTICAL SCALE: 1"=20

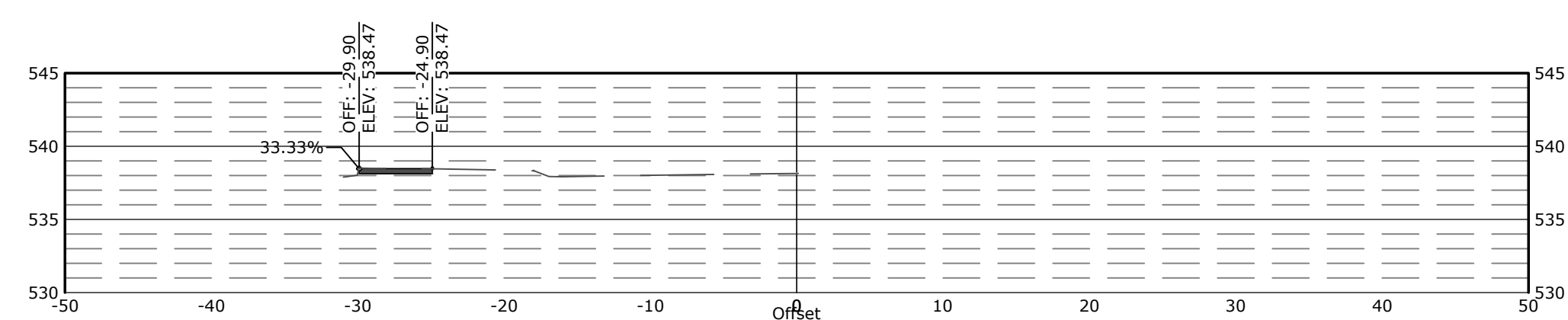

STA. 105+50.00
HORIZONTAL SCALE: 1"=20
VERTICAL SCALE: 1"=20

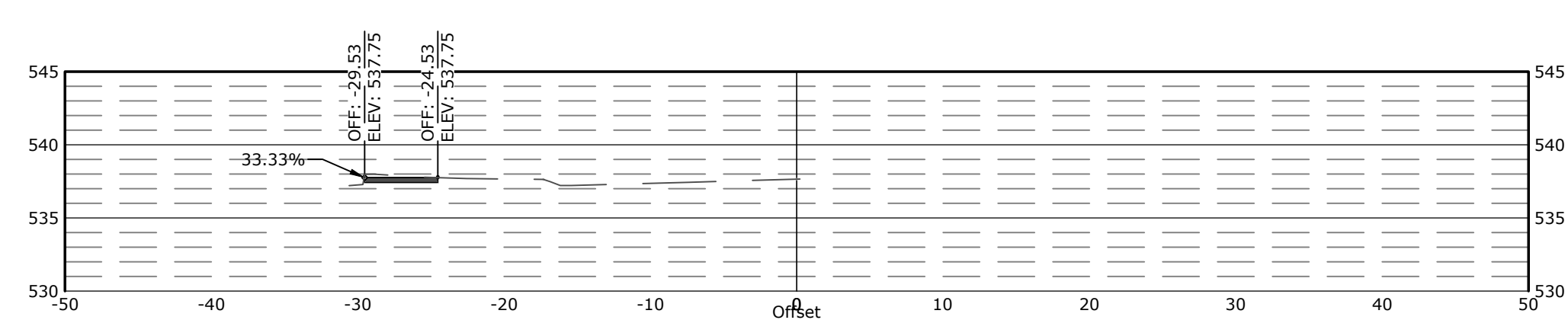

STA. 105+00.00
HORIZONTAL SCALE: 1"=20
VERTICAL SCALE: 1"=20

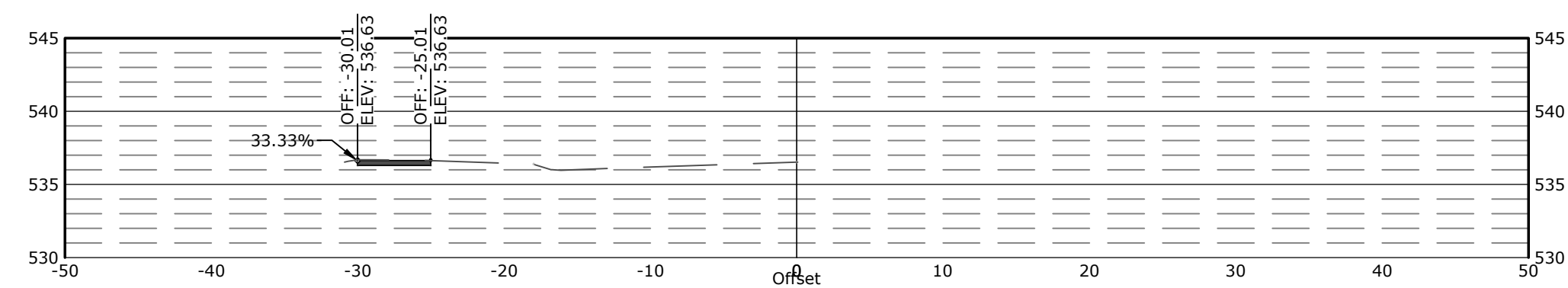

STA. 104+50.00
HORIZONTAL SCALE: 1"=20
VERTICAL SCALE: 1"=20

REVISIONS	DATE

CITY OF LITTLE ROCK, ARKANSAS
GREEN MOUNTAIN DRIVE SIDEWALK
ETHAN ALLEN DR. TO MARA LYNN RD.

CROSS SECTIONS I

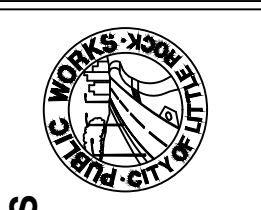

DEPARTMENT OF PUBLIC WORKS
CIVIL ENGINEERING
701 W. MARKHAM
LITTLE ROCK, ARKANSAS 72201

DRAWN BY ??
DESIGNED ??
CHECKED ??
DATE ??
SCALE 1" = 10'
PROJECT NO. MCE 24-5756
SHEET NO. C7

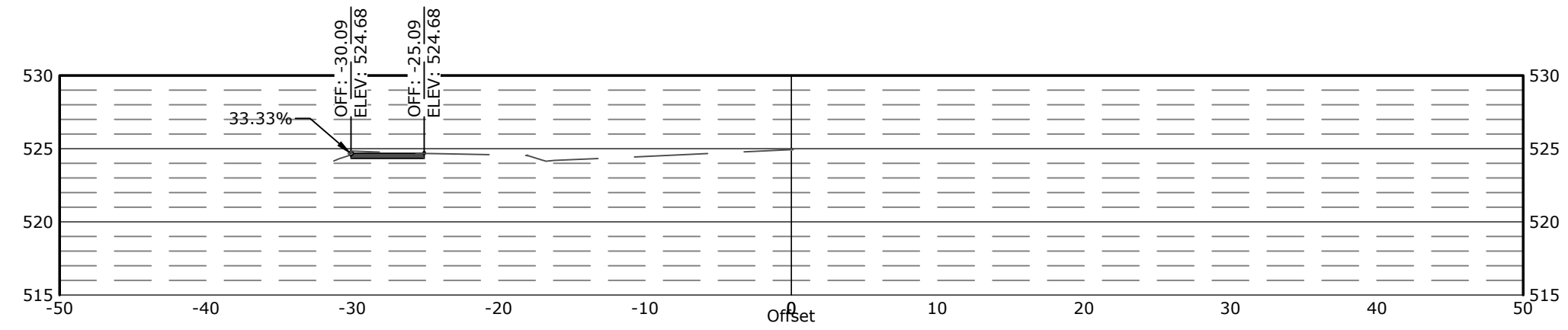

STA. 109+00.00
HORIZONTAL SCALE: 1"=20
VERTICAL SCALE: 1"=20

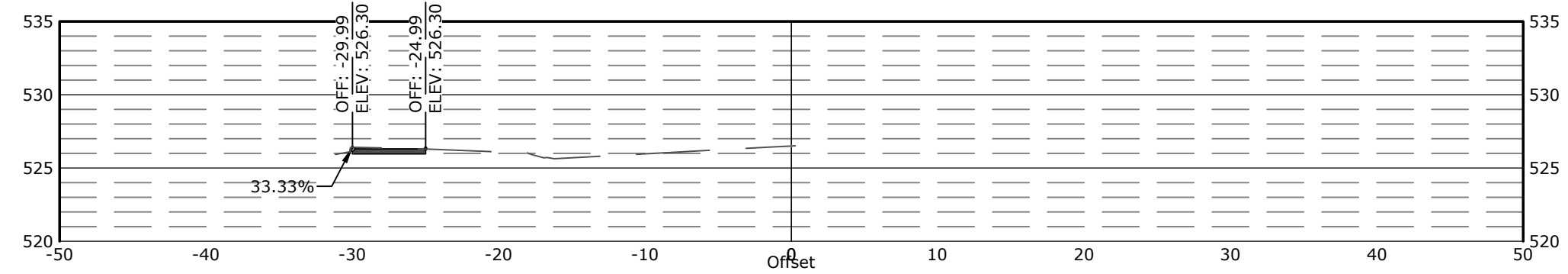

STA. 108+50.00
HORIZONTAL SCALE: 1"=20
VERTICAL SCALE: 1"=20

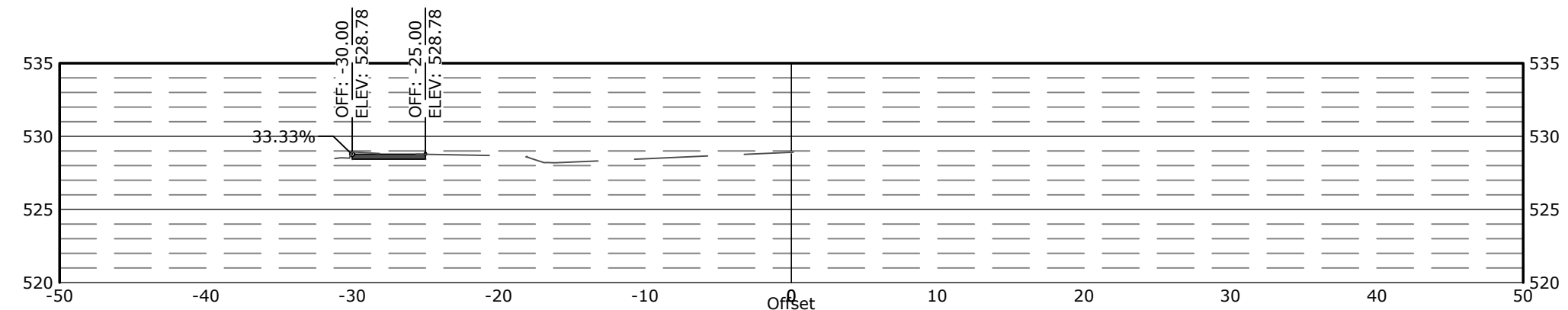

STA. 108+00.00
HORIZONTAL SCALE: 1"=20
VERTICAL SCALE: 1"=20

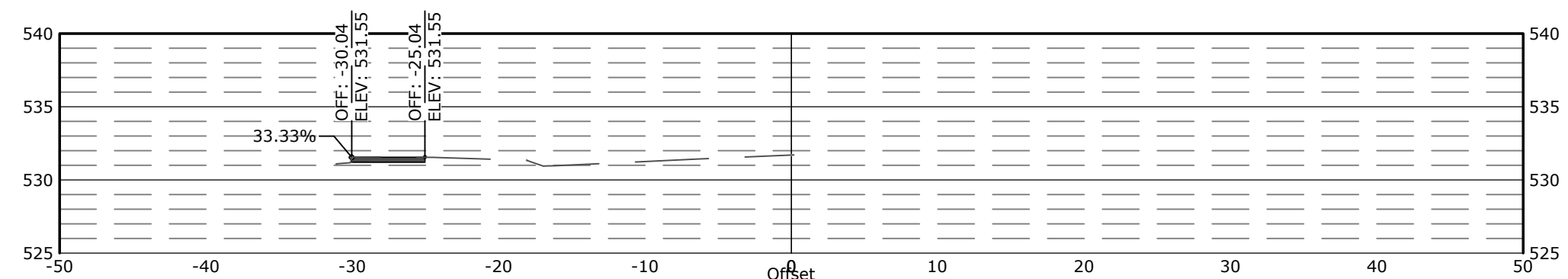

STA. 107+50.00
HORIZONTAL SCALE: 1"=20
VERTICAL SCALE: 1"=20

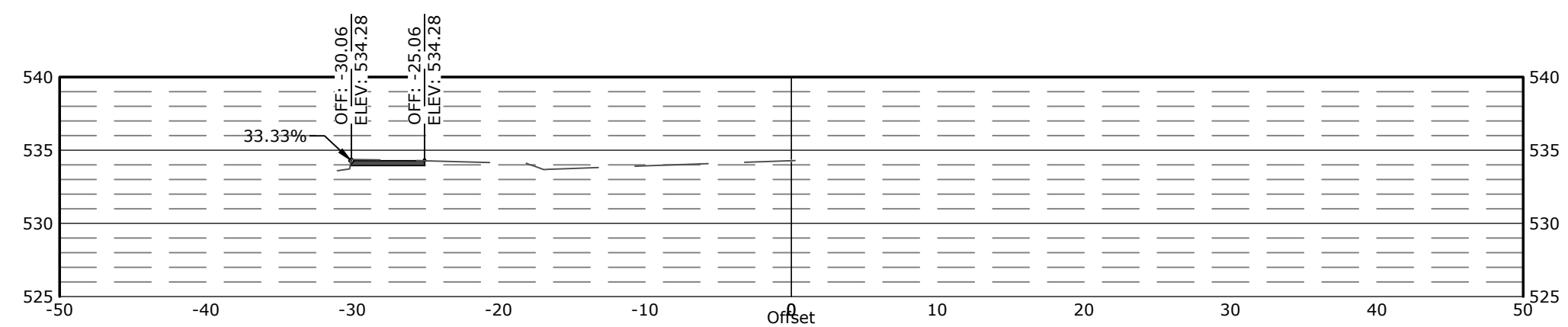

STA. 107+00.00
HORIZONTAL SCALE: 1"=20
VERTICAL SCALE: 1"=20

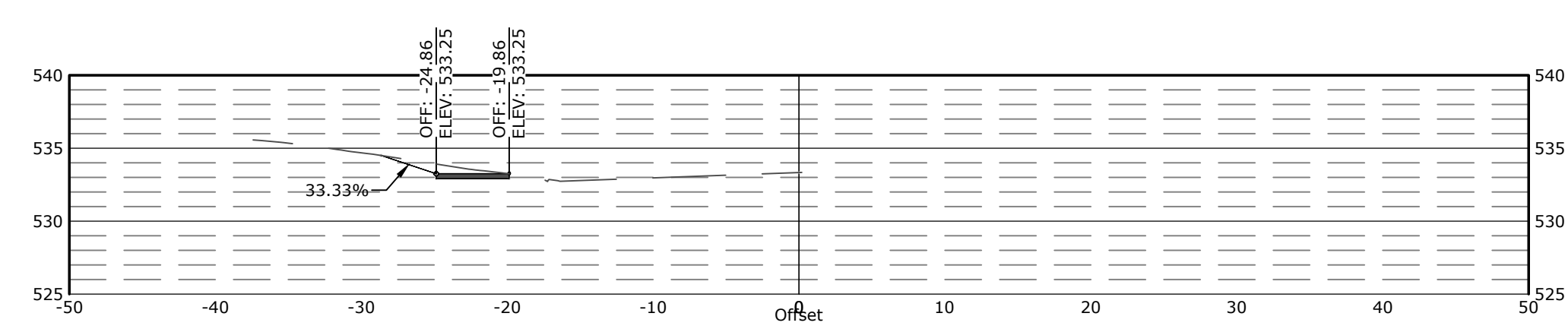

STA. 112+50.00
HORIZONTAL SCALE: 1"=20
VERTICAL SCALE: 1"=20

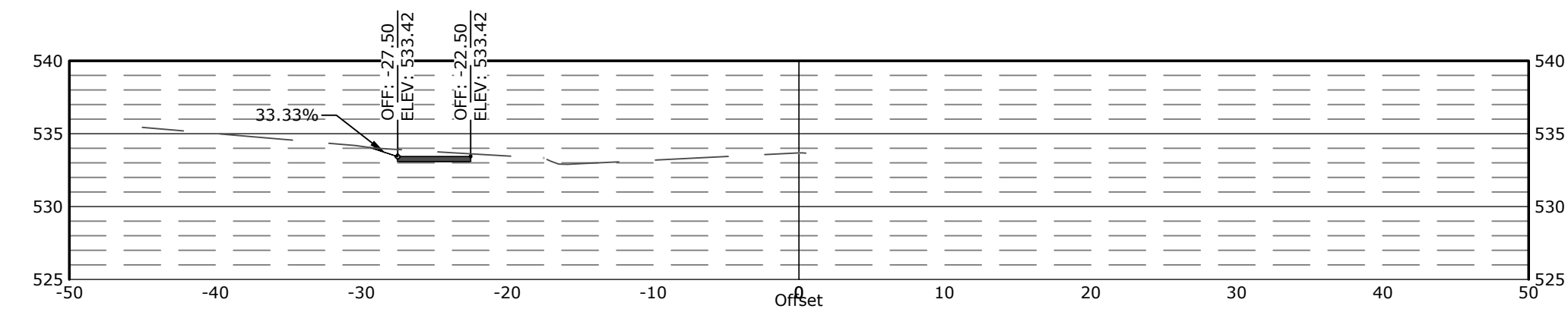

STA. 112+00.00
HORIZONTAL SCALE: 1"=20
VERTICAL SCALE: 1"=20

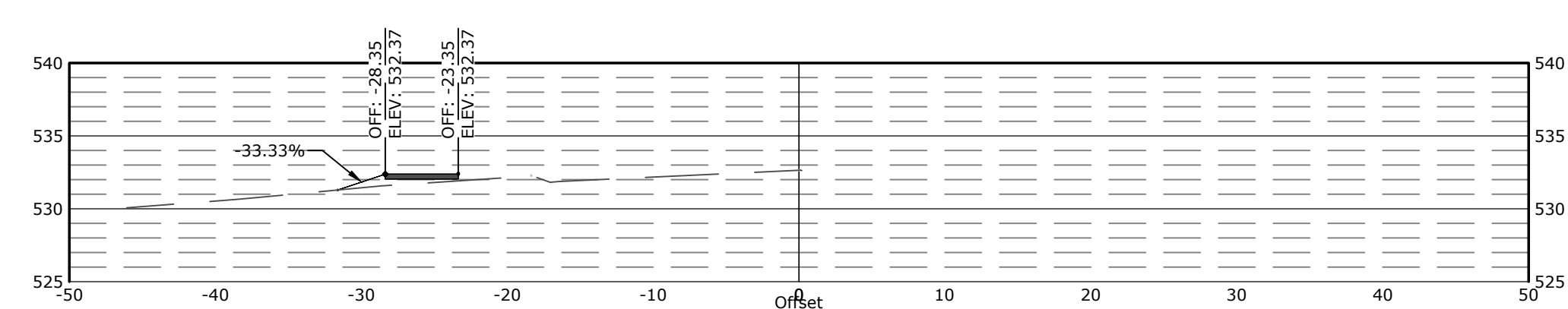

STA. 111+50.00
HORIZONTAL SCALE: 1"=20
VERTICAL SCALE: 1"=20

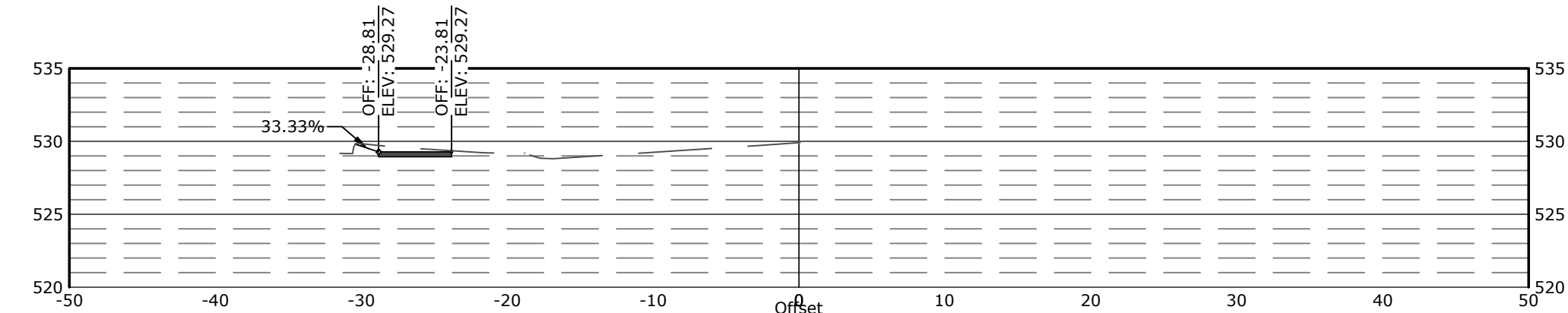

STA. 111+00.00
HORIZONTAL SCALE: 1"=20
VERTICAL SCALE: 1"=20

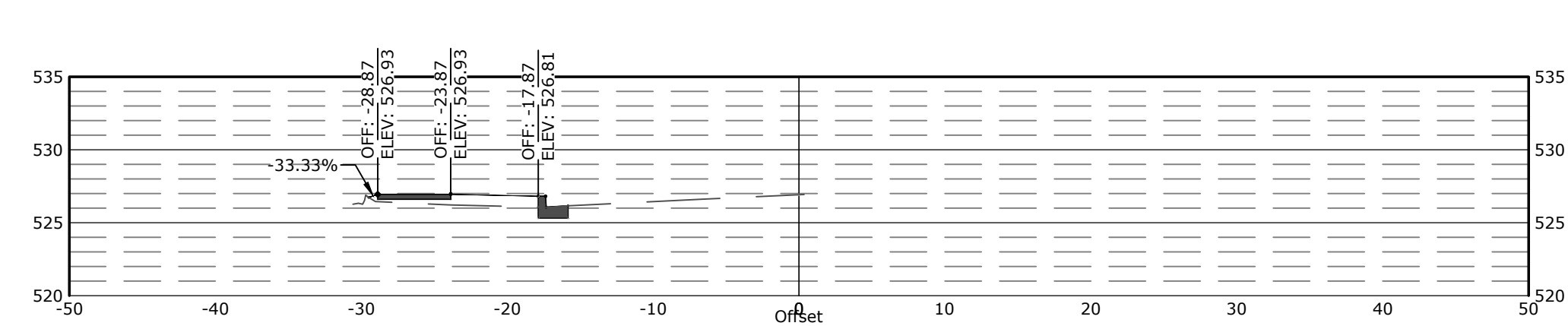

STA. 110+50.00
HORIZONTAL SCALE: 1"=20
VERTICAL SCALE: 1"=20

REVISIONS	DATE

CITY OF LITTLE ROCK, ARKANSAS
GREEN MOUNTAIN DRIVE SIDEWALK
ETHAN ALLEN DR. TO MARA LYNN RD.

CROSS SECTIONS II

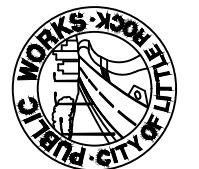

DEPARTMENT OF PUBLIC WORKS
CIVIL ENGINEERING
701 W. MARKHAM
LITTLE ROCK, ARKANSAS 72201

DRAWN BY ??
DESIGNED ??
CHECKED ??
DATE ??
SCALE 1" = 10'
PROJECT NO. MCE 24-5756
SHEET NO. C8

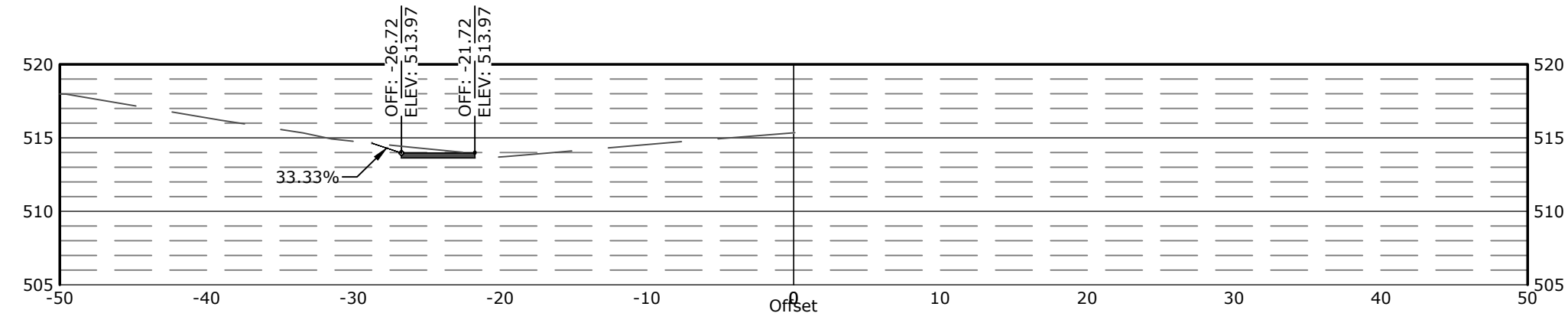

STA. 115+50.00
 HORIZONTAL SCALE: 1"=20
 VERTICAL SCALE: 1"=20

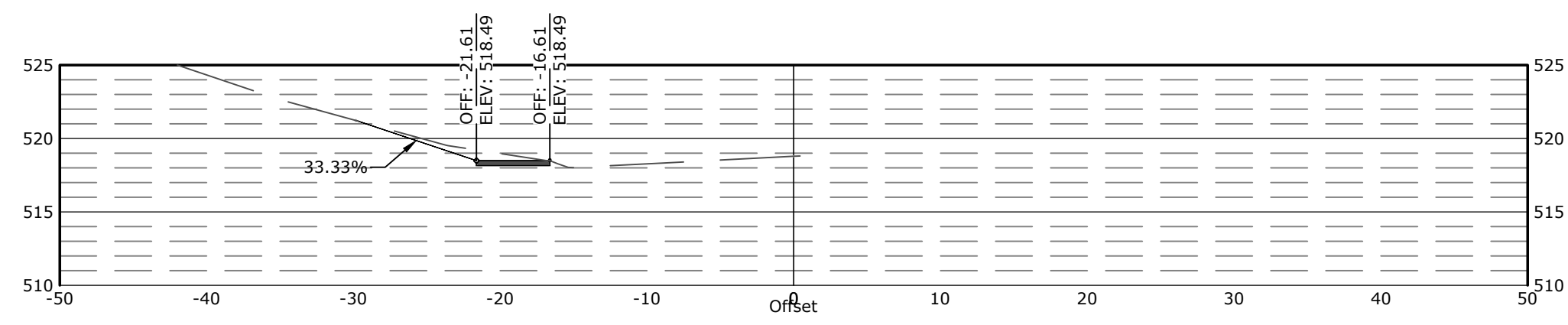

STA. 115+00.00
 HORIZONTAL SCALE: 1"=20
 VERTICAL SCALE: 1"=20

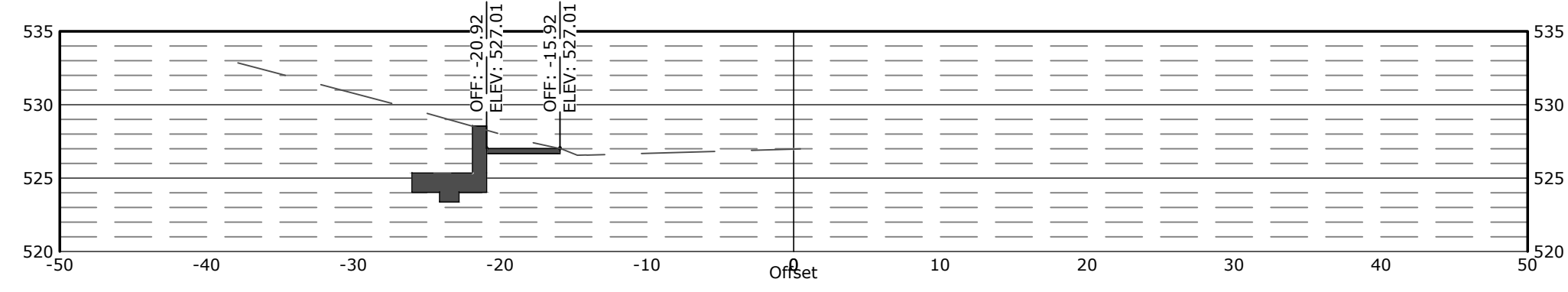

STA. 114+00.00
 HORIZONTAL SCALE: 1"=20
 VERTICAL SCALE: 1"=20

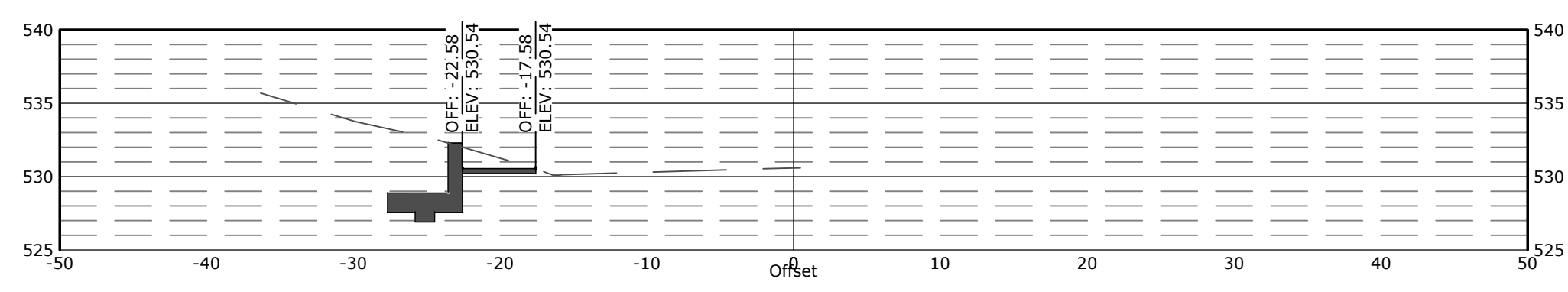

STA. 113+50.00
 HORIZONTAL SCALE: 1"=20
 VERTICAL SCALE: 1"=20

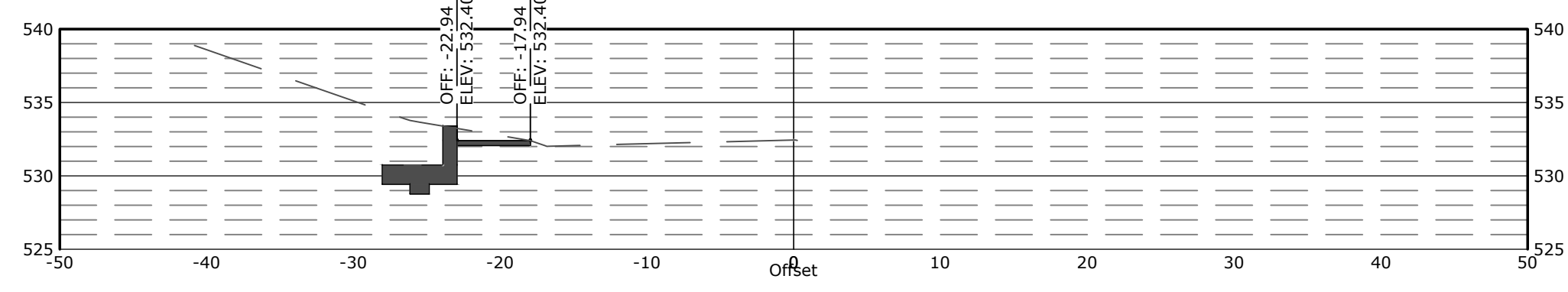

STA. 113+00.00
 HORIZONTAL SCALE: 1"=20
 VERTICAL SCALE: 1"=20

REVISIONS	DATE

CITY OF LITTLE ROCK, ARKANSAS
 GREEN MOUNTAIN DRIVE SIDEWALK
 ETHAN ALLEN DR. TO MARA LYNN RD.
 CROSS SECTIONS III

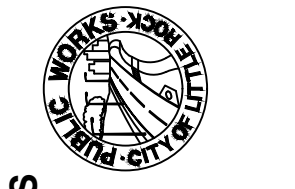

DEPARTMENT OF PUBLIC WORKS
 CIVIL ENGINEERING
 701 W. MARKHAM
 LITTLE ROCK, ARKANSAS 72201

DRAWN BY ??
DESIGNED ??
CHECKED ??
DATE ??
SCALE 1" = 10'
PROJECT NO. MCE 24-5756
SHEET NO. C9