

# MONTROSE AND LONGLEA DRAINAGE

04 - 22 - DR - 19

SHEET NO.	TITLE
1	COVER SHEET
2	GENERAL NOTES, LEGEND, AND QUANTITIES
3	PLAN AND PROFILE - WEST CURB
4	PLAN AND PROFILE - EAST CURB

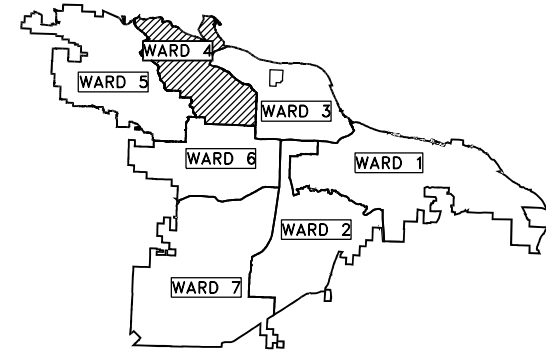

PROJECT LOCATION - WARD 4

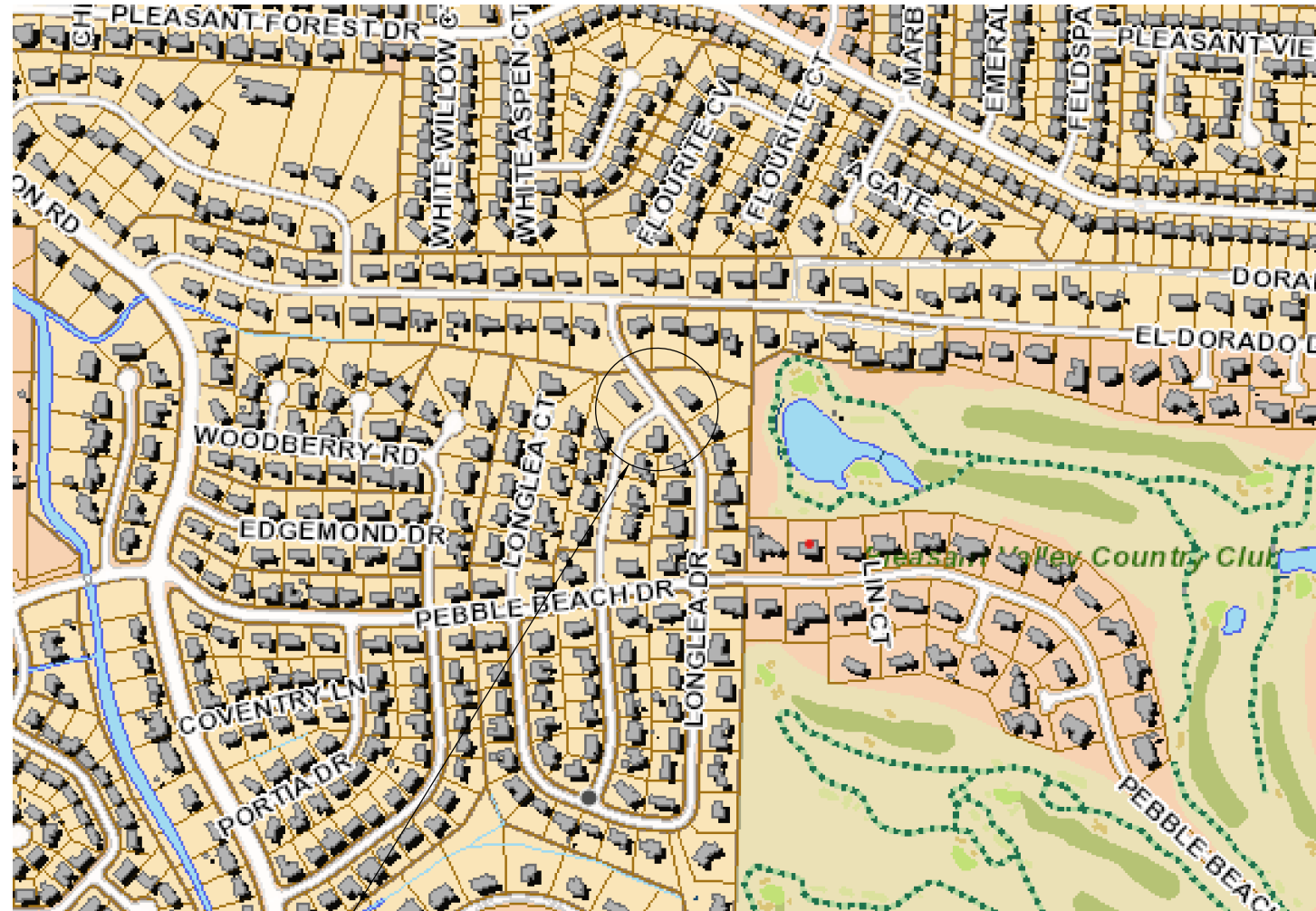

NTS

PROJECT LOCATION  
 LAT: 34°47'10.36" N  
 LONG: 92°25'14.65" W



DEPARTMENT OF PUBLIC WORKS  
 CIVIL ENGINEERING  
 701 WEST MARKHAM STREET  
 LITTLE ROCK, ARKANSAS 72201

**PRELIMINARY**  
 SUBJECT TO REVISION

PREPARED BY:



2100 RIVERDALE DR.  
 LITTLE ROCK, AR 72202  
 PHONE: (501) 817-7510

REVISIONS	DATE

CITY OF LITTLE ROCK, ARKANSAS  
 MONTROSE AND LONGLEA DRAINAGE

COVER SHEET

DEPARTMENT OF PUBLIC WORKS  
 CIVIL ENGINEERING  
 701 W. MARKHAM  
 LITTLE ROCK, ARKANSAS 72201



DRAWN BY  
 ITT  
 DESIGNED  
 ITT  
 CHECKED

DATE  
 07/02/2024  
 SCALE  
 1" = 50'

PROJECT NO.  
 04 - 22 - DR - 19  
 SHEET NO.

1

REVISIONS	DATE

**CLR PROJECT 04-22-DR-19**  
**MONTROSE AND LONGLEA DRAINAGE**  
3-Jul-24

ITEM NO	ITEM DESCRIPTION	UNIT	QUANTITY
2.01	SITE PREPARATION*	L.S.	1
4.01	COMPACTED SUBGRADE	C.Y.	10
5.01	TACK COAT	GAL.	61
6.01	ASPHALT SURFACE COURSE	TON	39
6.02	ASPHALT LEVELING COURSE	TON	15
7.04	CONCRETE DRIVE (PRI.), 6"	S.Y.	133
8.01	CONCRETE CURB & GUTTER, CLASS 3	L.F.	254
16.01	MAINTENANCE OF TRAFFIC	L.S.	1
19.01	FINAL CLEAN UP	L.S.	1



**CITY OF LITTLE ROCK, ARKANSAS**  
**MONTROSE AND LONGLEA DRAINAGE**  
**GENERAL NOTES, LEGEND, AND QUANTITIES**

DEPARTMENT OF PUBLIC WORKS  
CIVIL ENGINEERING  
701 W. MARKHAM  
LITTLE ROCK, ARKANSAS 72201

<b>DRAWN BY</b>	ITT
<b>DESIGNED</b>	ITT
<b>CHECKED</b>	ITT
<b>DATE</b>	07/02/2024
<b>SCALE</b>	N/A
<b>PROJECT NO.</b>	04-22-DR-19
<b>SHEET NO.</b>	2

DATE REVISED	DATE REVISED	WARD	CITY	JOB NO.	SHEET NO.	TOTAL SHEETS
		4	L.R.	04-22-DR-19	3	4
PLAN AND PROFILE - WEST CURB						

**PRELIMINARY**  
SUBJECT TO REVISION

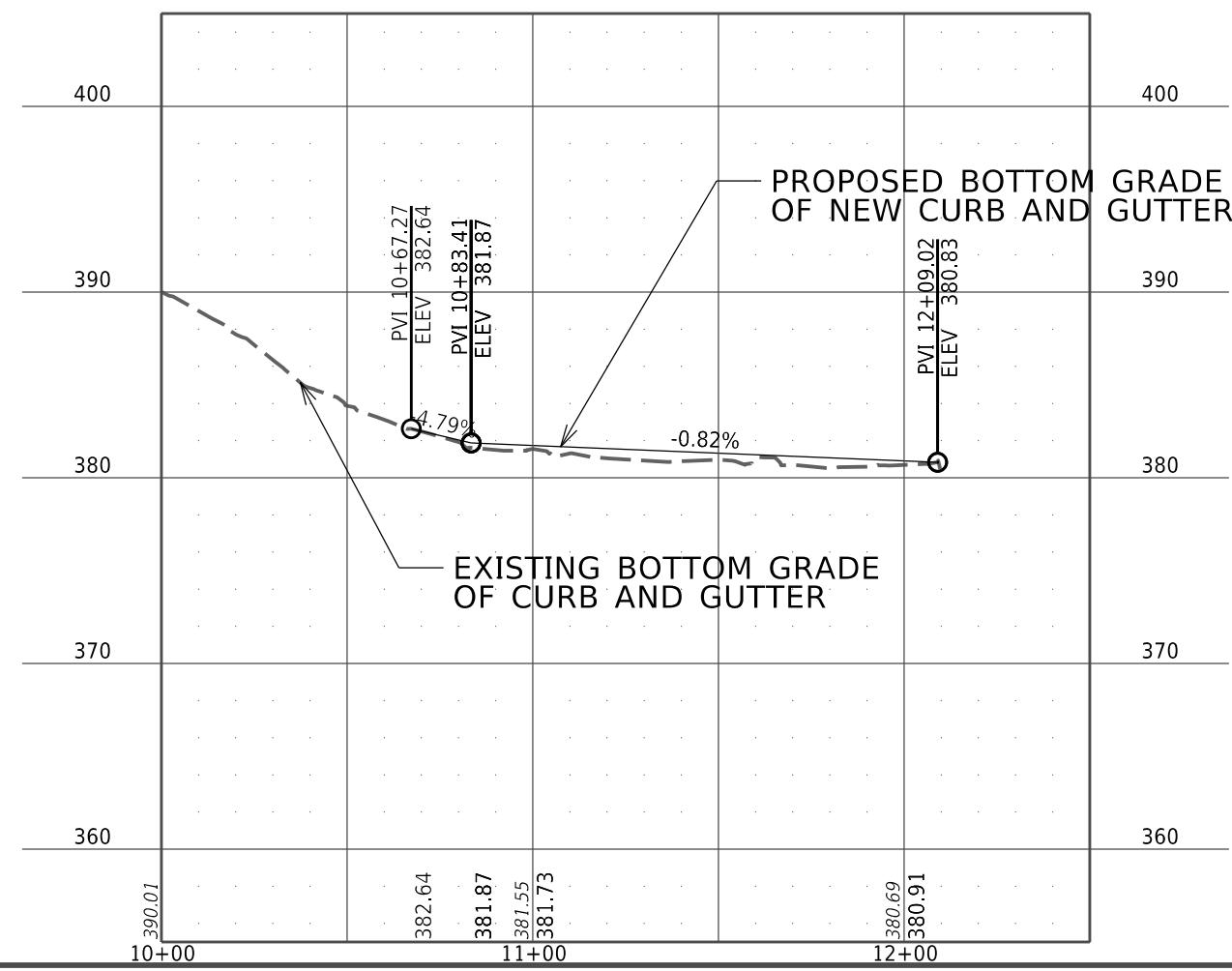
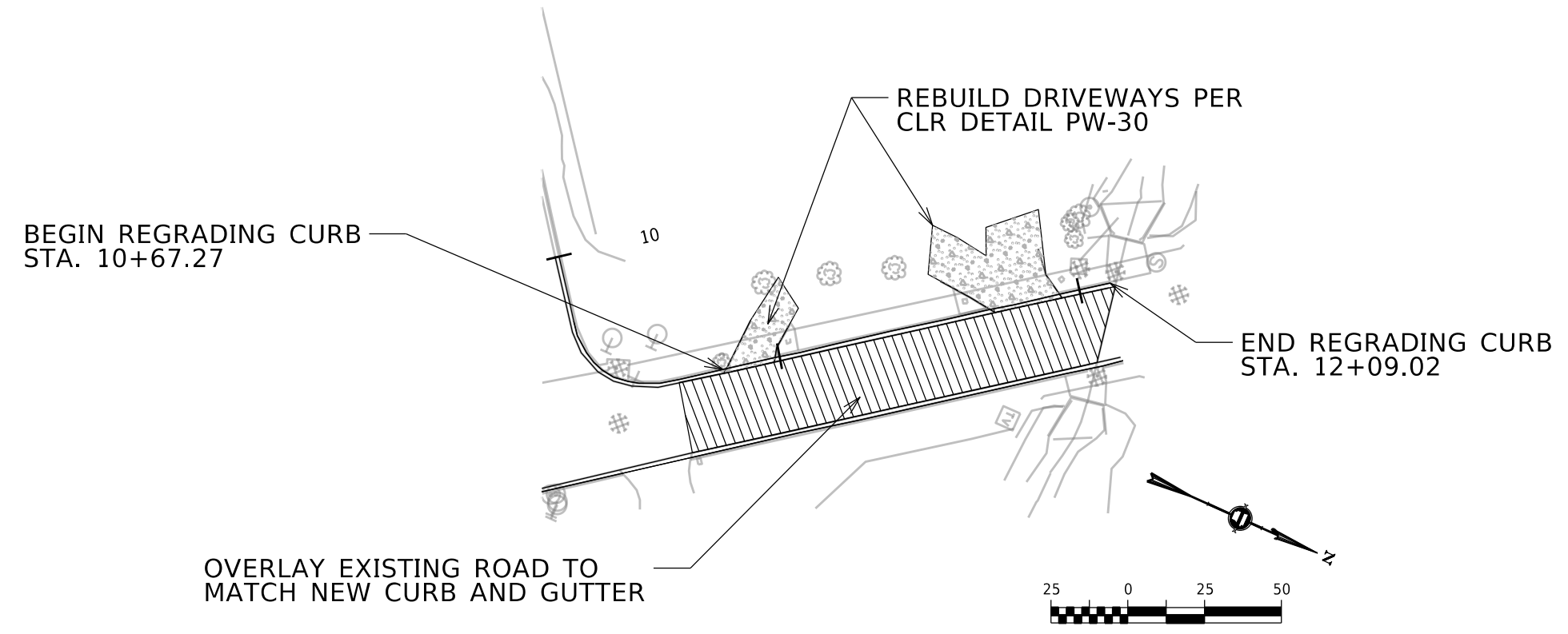

DATE REVISED	DATE REVISED	WARD	CITY	JOB NO.	SHEET NO.	TOTAL SHEETS
		4	L.R.	04-22-DR-19	4	4
PLAN AND PROFILE - EAST CURB						

**PRELIMINARY**  
SUBJECT TO REVISION

