

# CLR PROJECT 3-22-DR-10

## L STREET AT TYLER STREET

### DRAINAGE IMPROVEMENTS

#### LITTLE ROCK, ARKANSAS

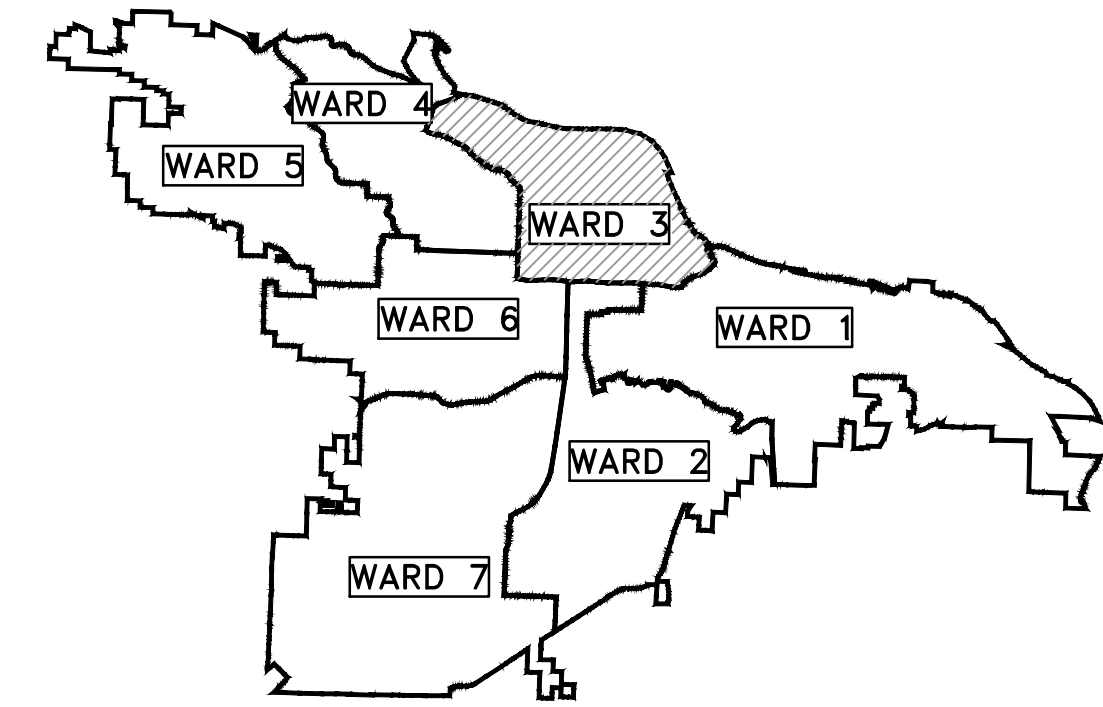

PROJECT LOCATION - WARD 1

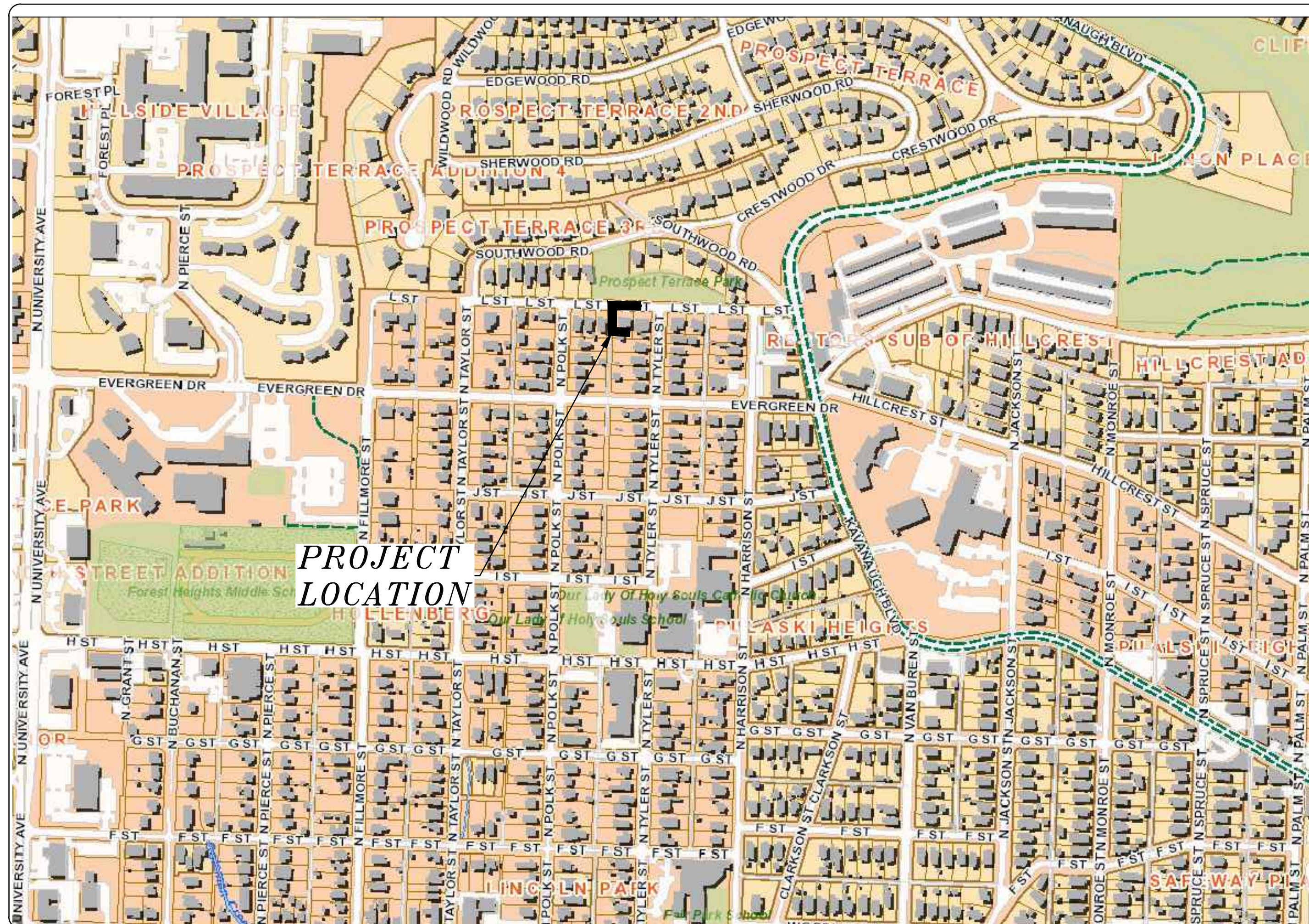

SHEET NO.	TITLE
C1	COVER SHEET
C2	LEGEND
C3	TYPICAL SECTIONS & DETAILS
C4	PLAN & PROFILE- STA. 0+00 TO STA. 2+33
C5	CROSS-SECTIONS- STA. 0+00 TO STA 2+33
C6	DRAINAGE PLAN
C7	EROSION CONTROL PLAN



**2023-2025**  
**BOND PROGRAM**

DEPARTMENT OF PUBLIC WORKS  
CIVIL ENGINEERING  
701 WEST MARKHAM STREET  
LITTLE ROCK, ARKANSAS 72201



13000 CANTRELL ROAD  
LITTLE ROCK, AR 72223  
PHONE 501-975-8100  
WWW.ECCI.COM

**PRELIMINARY 90% SUBMITTAL**

REVISIONS    DATE

CITY OF LITTLE ROCK, ARKANSAS  
L STREET DRAINAGE IMPROVEMENTS

COVER SHEET

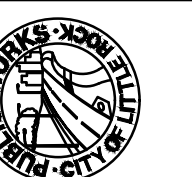

DEPARTMENT OF PUBLIC WORKS  
CIVIL ENGINEERING  
701 W. MARKHAM  
LITTLE ROCK, ARKANSAS 72201



DRAWN BY

JJ

DESIGNED

KP

CHECKED

KP

DATE

04.17.24

SCALE

NTS

PROJECT NO.

3-22-DR-10

SHEET NO.

C1

REVISIONS	DATE

**SUMMARY OF QUANTITIES**

ITEM #	ITEM DESCRIPTION	UNIT	QUANTITY
2.01	SITE PREPARATION (INCLUDES TREE REMOVAL)	L.S.	1
2.02	CLEARING AND GRUBBING	L.S.	1
3.40	TOPSOIL (6")	C.Y.	17
4.01	AGGREGATE BASE COURSE	TON	24
7.04	CONCRETE DRIVEWAY APRON (4" THICK) STANDARD FINISH	S.F.	306
8.03	CONCRETE CURB AND GUTTER (CLASS 3)	L.F.	81
10.01	JUNCTION BOX (4')	EA.	2
10.04	CURB INLET - 4' BOX	EA.	1
10.10	WING 6' EXTENSION	EA.	2
10.80	REBUILD INLET TOP, 4' BOX w/ 6' WING EXTENSION	EA.	1
13.24S	SIDE DRAIN, 24" RCP	L.F.	58
13.30S	SIDE DRAIN, 30" RCP	L.F.	154
13.63	CONCRETE PLUG ON EXISTING STORM DRAIN	E.A.	1
13.64	TIE INTO EXISTING BOX CULVERT	EA.	1
14.01	SOLID SODDING, BERMUDA	S.Y.	67
16.01	MAINTENANCE OF TRAFFIC	L.S.	1
17.01	PAVEMENT REPAIRS (UTILITY CUT PW-25)	S.Y.	56
18.45	RIPRAP	C.Y.	13
18.55	WATER FOR DUST CONTROL	GAL	100
19.01	FINAL CLEANUP	L.S.	1
24.09	SEDIMENT BARRIER, BLOCK (SD4)	EA.	1
24.11	SILT FENCE - TYPE A (SFA)	L.F.	70
24.16	DISTURBED AREA STABILIZATION - TEMPORARY STABILIZATION (TS1)	AC.	1
24.18	DISTURBED AREA STABILIZATION - PERMANENT GRASSING (TS3)	AC.	1
26.10	TRENCH AND EXCAVATION SAFETY	L.S.	1
501.01	PORTLAND CEMENT CONCRETE PAVING	S.Y.	39
606.30C	FLARED END SECTION, 30" RCP	EA.	1
SP	PERVIOUS CONCRETE/BRICK PAVER (WALKWAY)	S.F.	25
SP	REMOVE/REPLACE LIGHT POLE	EA.	1
SP	TREE REMOVAL, LARGE	EA.	2
SP	SELECT GRANULAR BACKFILL	C.Y.	109

EXISTING	PROPOSED
IRON ROD	○ IR
PK NAIL	○ PK
R.R. SPIKE	○ RR(Sp)
CONC. MONUMENT	□ CM
WATER VALVE	⊗ WV
WATER METER	⊞ WM
FIRE HYDRANT	⊞ FH
GAS METER	⊞ GM
GAS VALVE	⊗ GV
CLEAN-OUT	○ CO
GUARD POST (BOLLARD)	● GP
SIGN POST	—
BENCHMARK	⊕
STORM SEWER MANHOLE	⊙
SANITARY SEWER MANHOLE	⊙ S
TELEPHONE MANHOLE	⊙ T
ELECTRIC MANHOLE	⊙ E
TELEPHONE BOX	⊞
ELECTRIC BOX	⊞
CABLE BOX	⊞
UTILITY POLE	⊞
GUY WIRE	—
LIGHT POLE	⊙
POST OR POLE (TYPE AS NOTED)	⊙
MAILBOX	⊞
DECIDUOUS TREE	⊙
EVERGREEN/CONIFEROUS TREE	⊙
BUSH	⊙
PROPERTY LINE	—
SETBACK LINE	—
EASEMENT LINE	—
CURB	—
FENCE	— X — X —
OVERHEAD UTILITY	— OHP — OHP —
UNDERGROUND TELEPHONE	— UGT — UGT — UGT —
UNDERGROUND ELECTRIC	— UGE — UGE — UGE —
WATER LINE	— 8"W — 8"W — 8"W —
SEWER LINE	— SAN —
GAS LINE	— GAS — GAS — GAS —
STORM SEWER/CULVERT	— 24" CMP/RCP/DIP —
CONTOUR LINE	— 650 —
CONTOUR	○
SPOT ELEVATION	25.00
SPOT CURB ELEVATION	25.50 25.00
STORM SEWER — PIPE	—
STORM SEWER — MITERED END SECTION	—
STORM SEWER — GRATE INLET	—
STORM SEWER — JUNCTION BOX	—
STORM SEWER — FLARED END SECTION	—
STORM SEWER — HEADWALL	—
STORM SEWER — INLET WITH SINGLE EXTENSION	—
STORM SEWER — INLET WITH DOUBLE EXTENSION	—
STORM SEWER — AREA INLET	—
GRADE BREAK LINE	—
HIGH POINT	HP
LOW POINT	LP
CUT LINE	— C —
FILL LINE	— F —
SANITARY SEWER PIPE	—
SANITARY SEWER MANHOLE	⊙
CURB	—
CONCRETE	⊙
CONSTRUCTION — ENTRANCE/EXIT	⊙ CO
CHECK DAM	⊙ CD
DIVERSION BERM	⊙ DI
DOWNDRAIN STRUCTURE — TEMPORARY	⊙ DN
ROCK DAM	⊙ RD
SEDIMENT BARRIER — SILT FENCE	⊙ SD1
SEDIMENT BARRIER — GRAVEL RING	⊙ SD2
SEDIMENT BARRIER — BLOCK & GRAVEL	⊙ SD3
SEDIMENT BARRIER — BLOCK	⊙ SD4
TEMPORARY SEDIMENT BASIN	⊙ SBI
SILT FENCE — TYPE A	⊙ SFA
SILT FENCE — TYPE B	⊙ SFB
SILT FENCE — TYPE C	⊙ SFC
STORM DRAIN OUTLET PROTECTION	⊙ ST
SURFACE ROUGHENING	⊙ SU
DISTURBED AREA STABILIZATION — TEMPORARY STABILIZATION	⊙ TS1
DISTURBED AREA STABILIZATION — TEMPORARY GRASSING	⊙ TS2
DISTURBED AREA STABILIZATION — PERMANENT GRASSING	⊙ TS3
MATting/BLANKETS	⊙ Mb

**CITY OF LITTLE ROCK, ARKANSAS**  
**L STREET DRAINAGE IMPROVEMENTS**  
**LEGEND**

**DEPARTMENT OF PUBLIC WORKS**  
**CIVIL ENGINEERING**  
**701 W. MARKHAM**  
**LITTLE ROCK, ARKANSAS 72201**

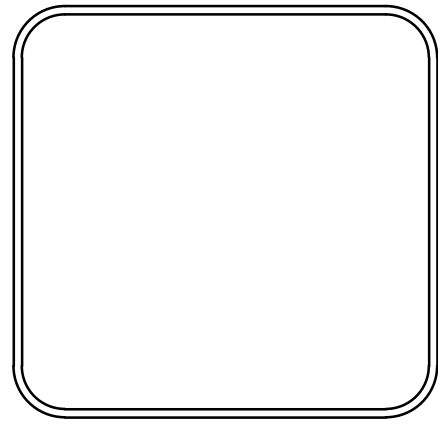

<b>DRAWN BY</b> JJ
<b>DESIGNED</b> KP
<b>CHECKED</b> KP
<b>DATE</b> 04.17.24
<b>SCALE</b> NTS
<b>PROJECT NO.</b> 3-22-DR-10
<b>SHEET NO.</b> C2

**PRELIMINARY- 90% SUBMITTAL**

REVISIONS	DATE

**CITY OF LITTLE ROCK, ARKANSAS**  
**L STREET DRAINAGE IMPROVEMENT**  
**TYPICAL SECTIONS & DETAILS**

**DEPARTMENT OF PUBLIC WORKS**  
**CIVIL ENGINEERING**  
**701 W. MARKHAM**  
**LITTLE ROCK, ARKANSAS 72201**

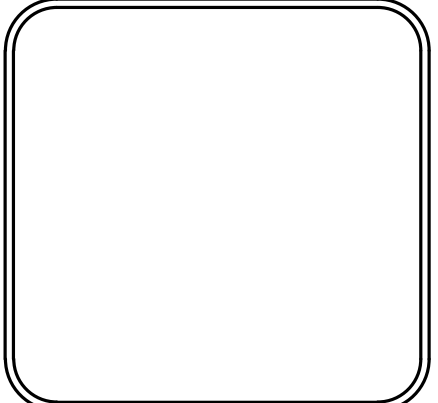

<b>DRAWN BY</b> JJ
<b>DESIGNED</b> KP
<b>CHECKED</b> KP
<b>DATE</b> 04.17.24
<b>SCALE</b> NTS
<b>PROJECT NO.</b> CLR #03-22-DR-10
<b>SHEET NO.</b> C3

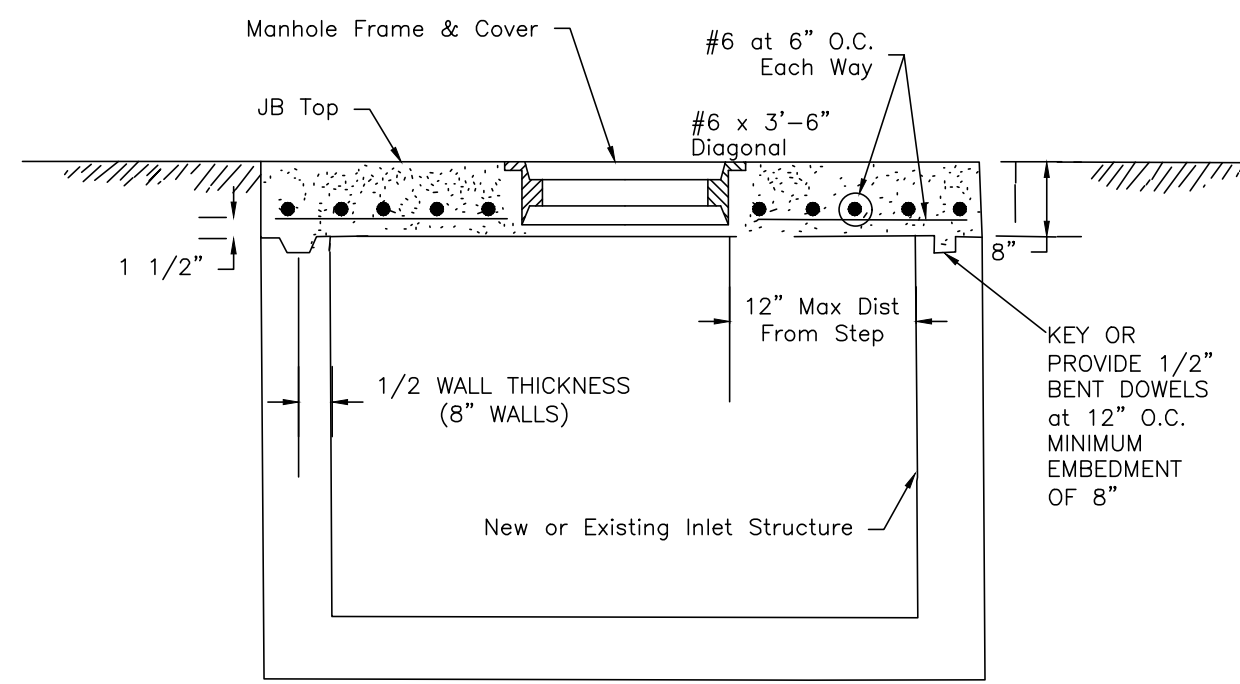

NOTE: Junction box top may be held below ACHM Surface and manhole cover extended up flush with paving surface.

**PW-11**

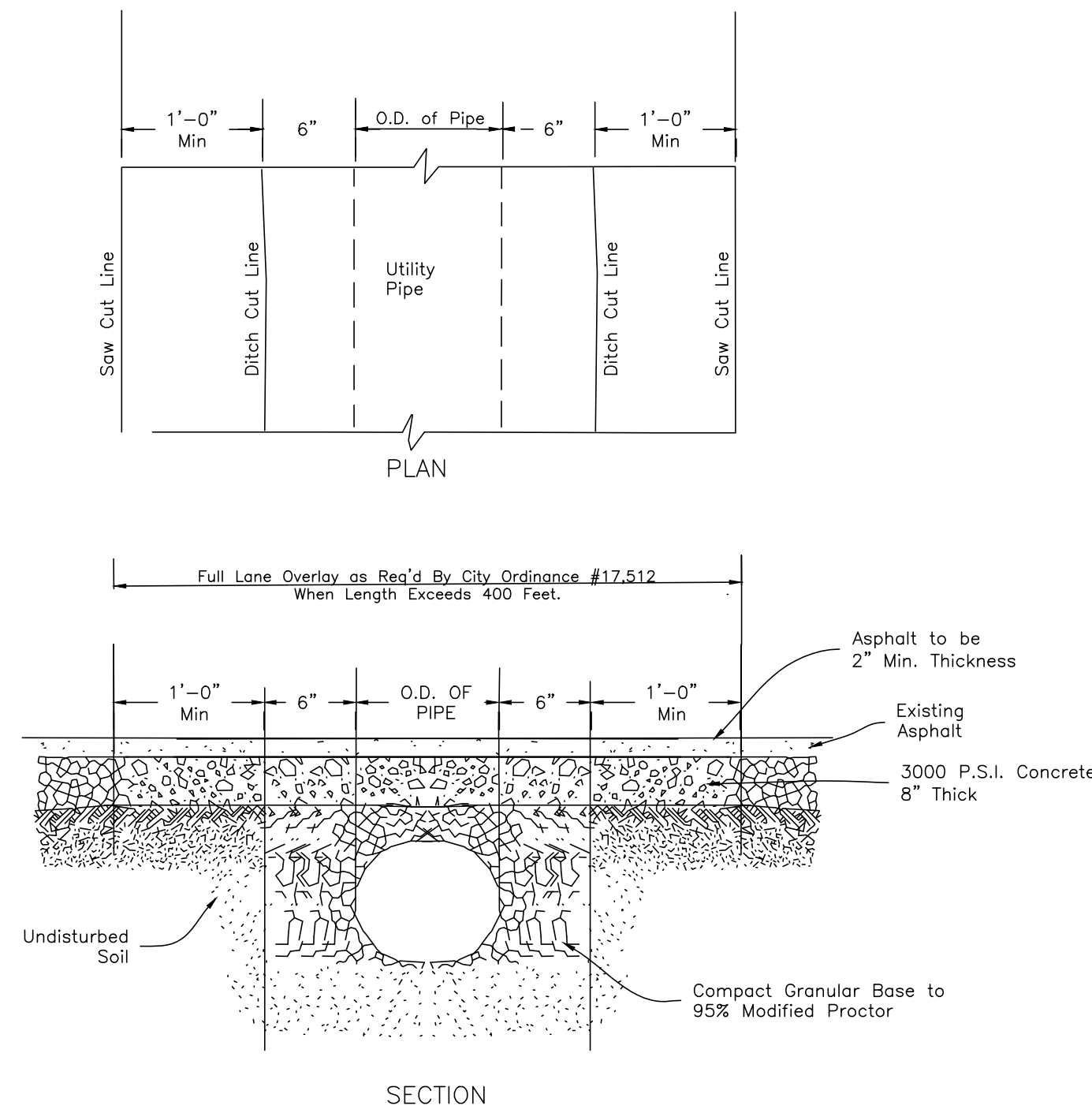

**PW-25**

Spacing Per City Ordinance 31-210

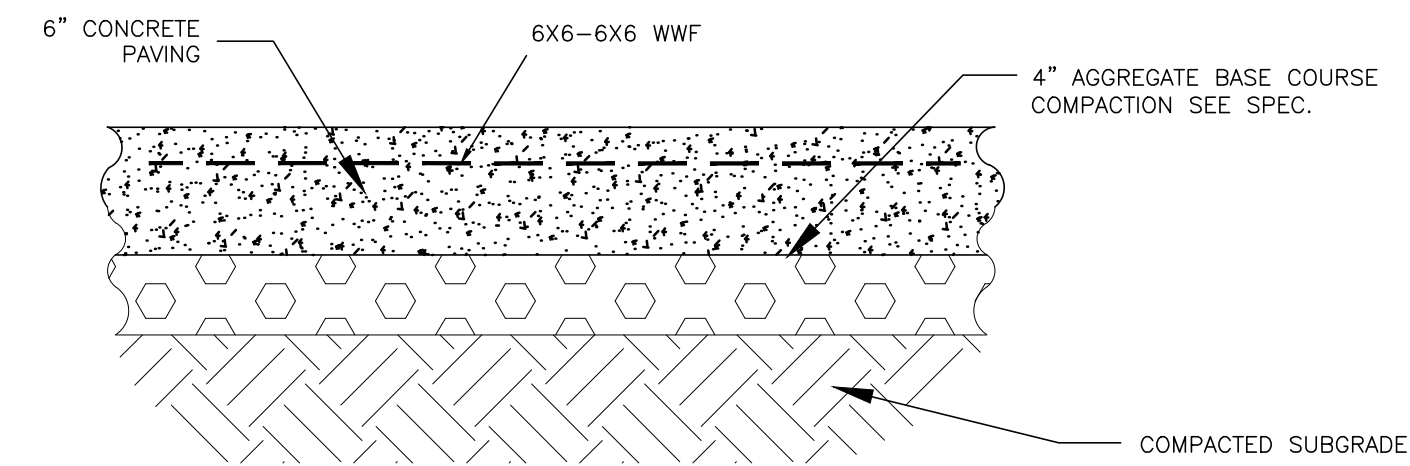

**CONCRETE PAVING**

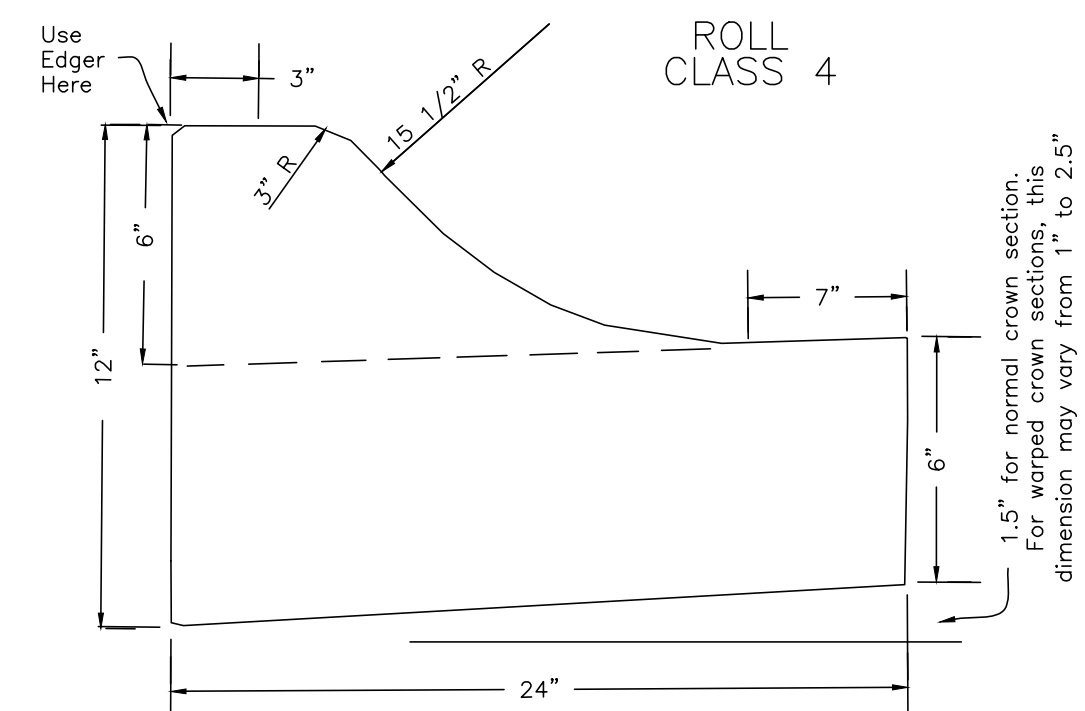
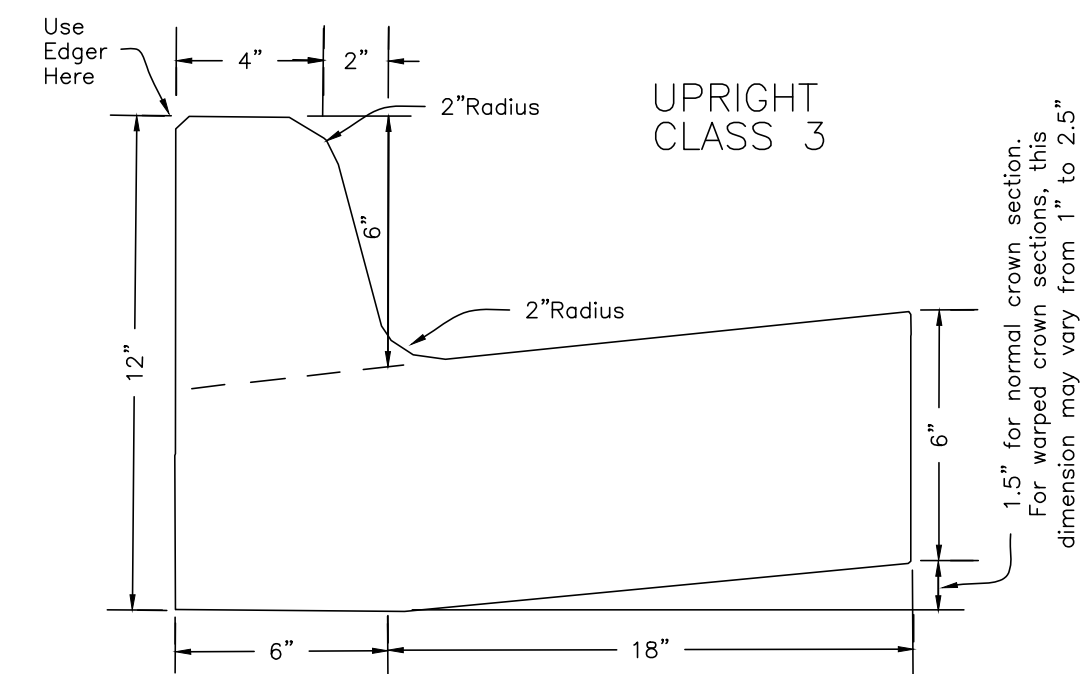

**PW-29**

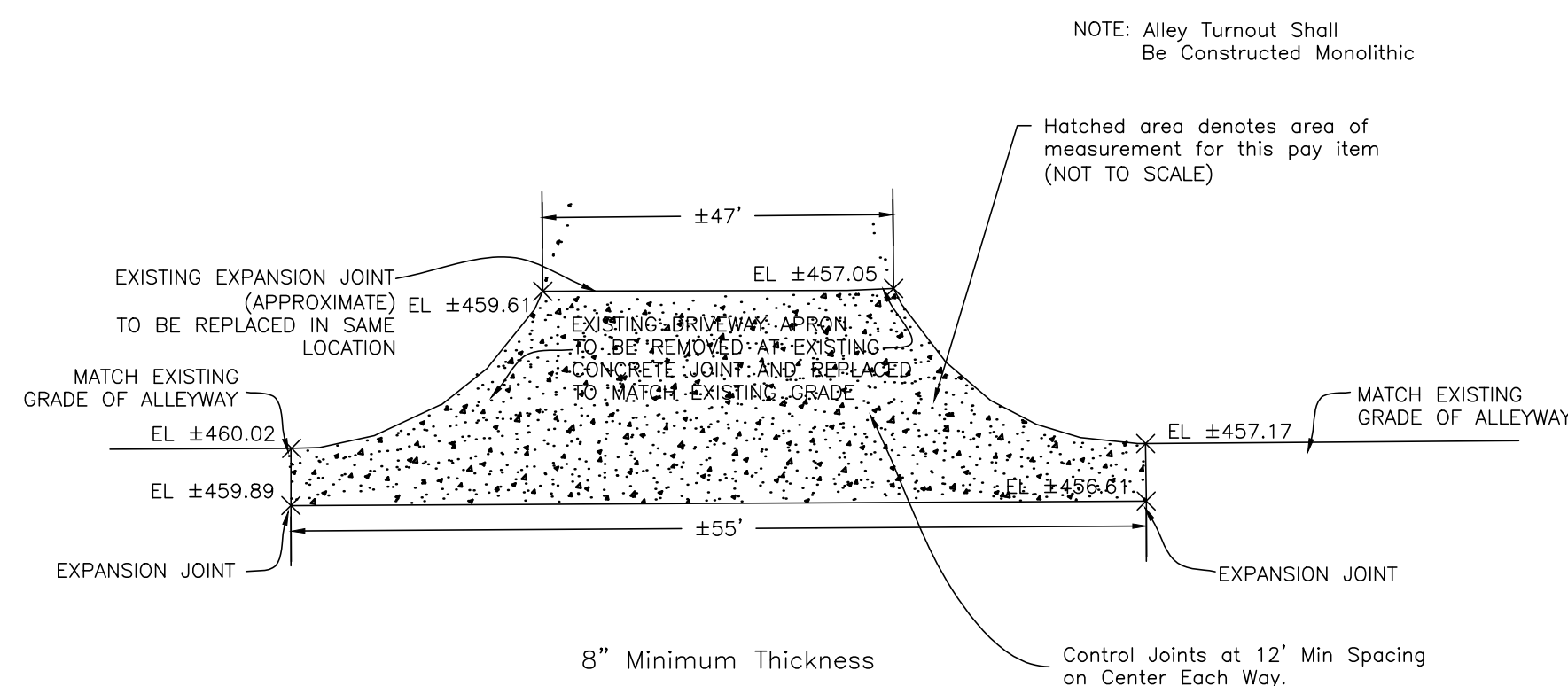

DRIVEWAY GRADES SHALL REMAIN AS THEY CURRENTLY ARE FOR THE EXISTING DRIVE.

**PW-35 (MODIFIED)**

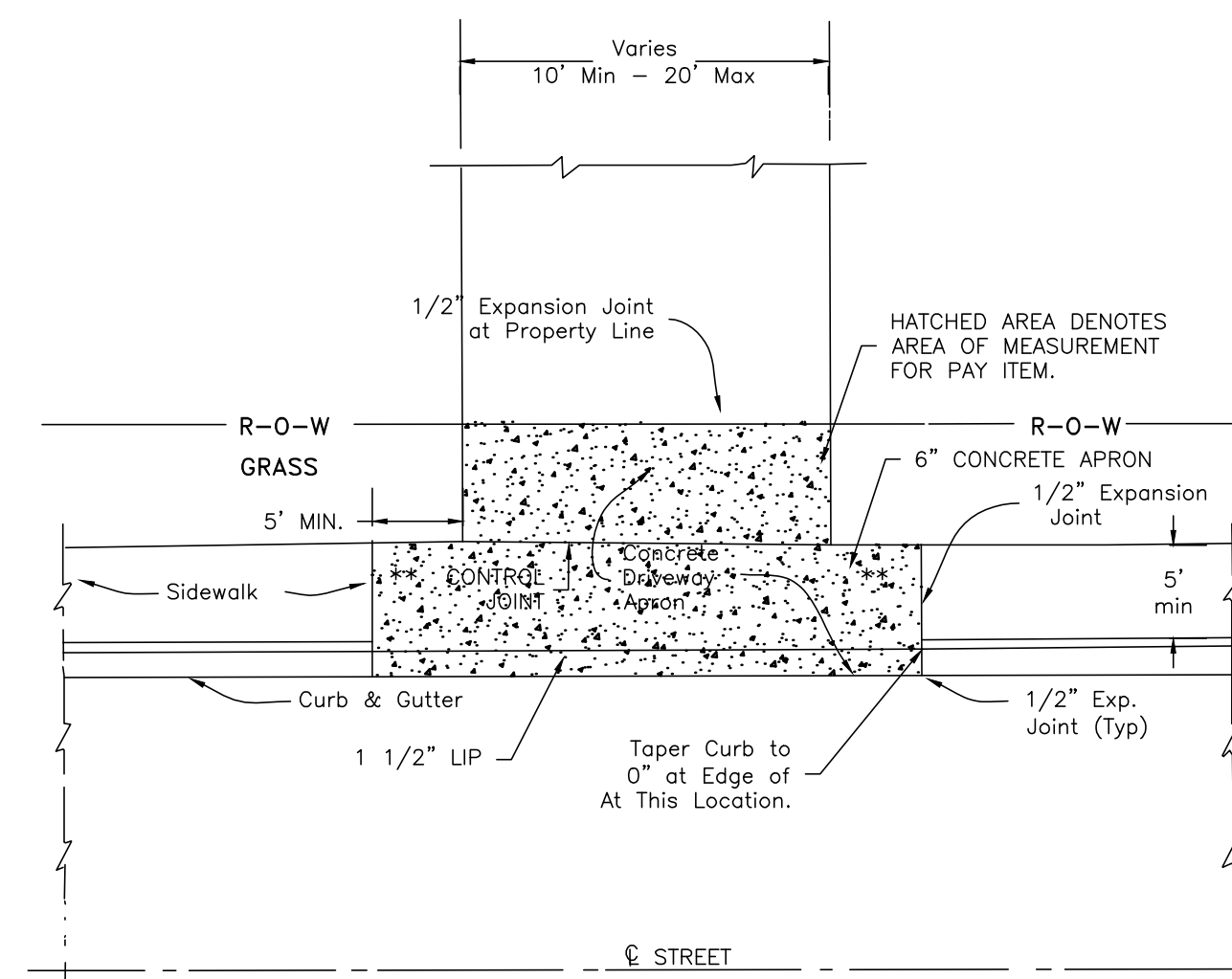

\* Sidewalks at back of curb by permission of Department of Public Works (only when conditions dictate).

\*\* Sidewalk area at driveway shall have cross slope of 1:50. See City Ordinance Section 31-210 for permissible driveway slopes.

Thickness and reinforcements are required for conditions & expected wheel loading - 6" minimum thickness.

DRIVEWAY GRADES SHALL BE DESIGNED BY ENGINEER TO KEEP STORMWATER IN STREET, 2% MINIMUM SLOPE AT SIDEWALK CROSSING, MAXIMUM % OF GRADE CHANGE IS 16.

**PW-32**

**PRELIMINARY- 90% SUBMITTAL**

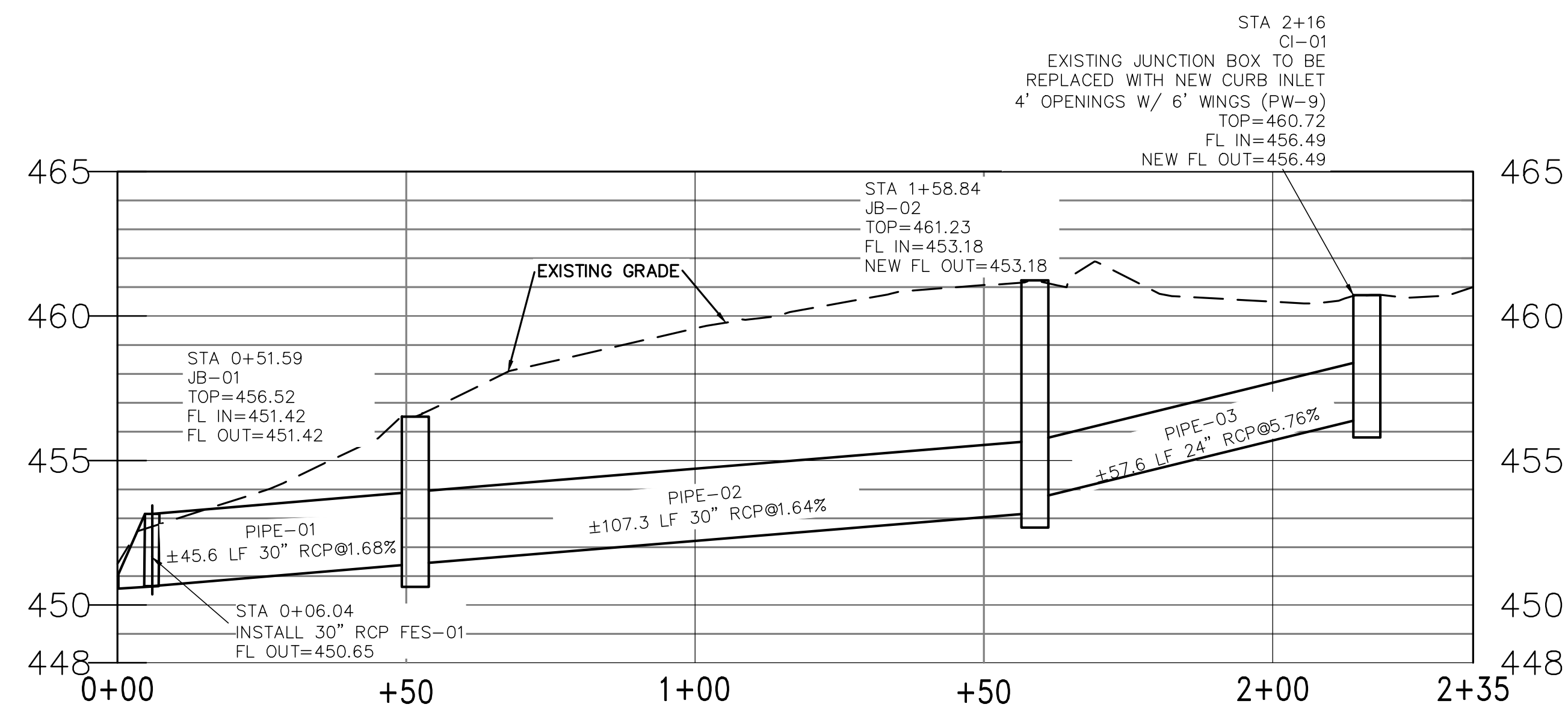
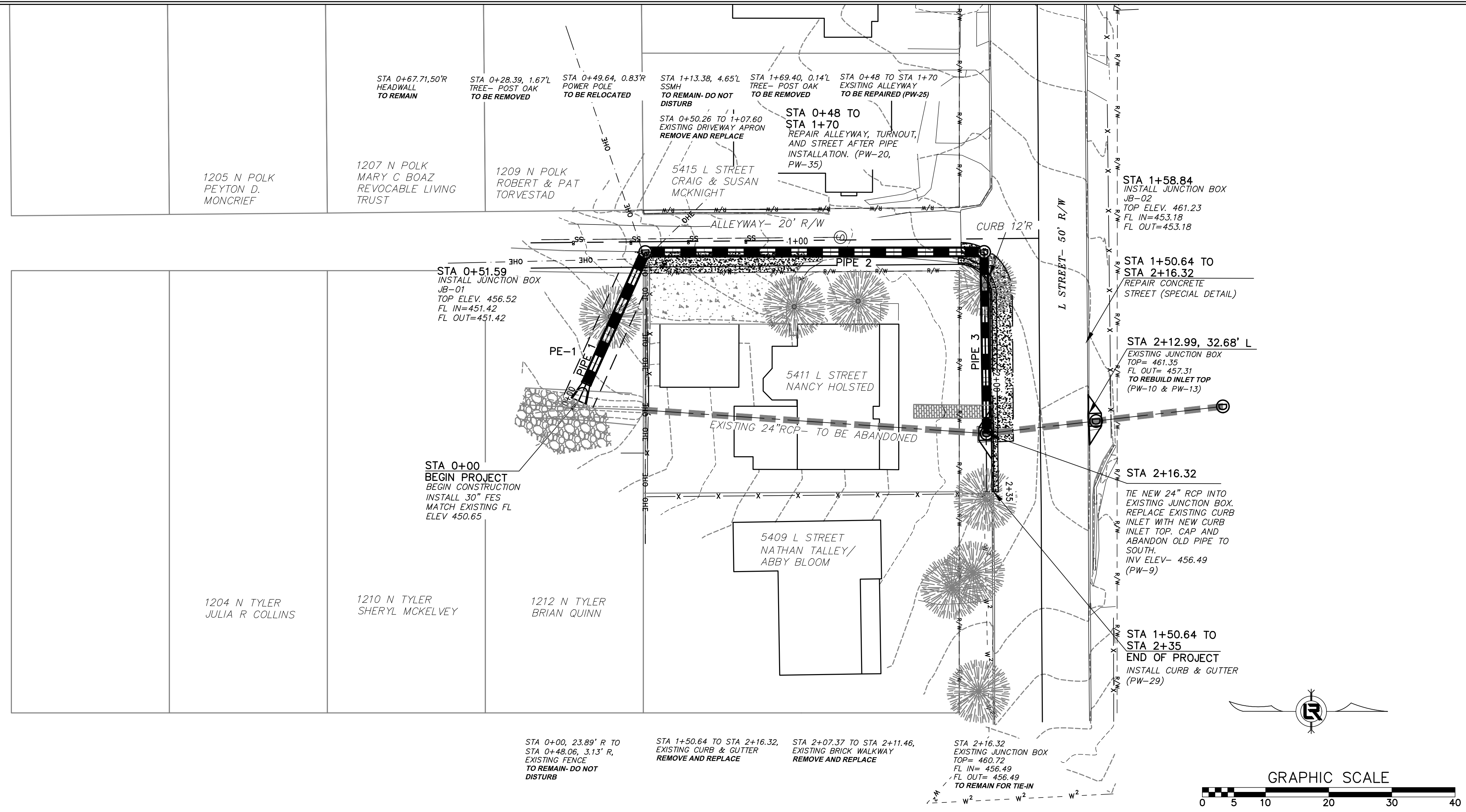

**PRELIMINARY- 90% SUBMITTAL**

REVISIONS	DATE

**CITY OF LITTLE ROCK, ARKANSAS**  
**L STREET DRAINAGE IMPROVEMENT**  
**PLAN & PROFILE**

DEPARTMENT OF PUBLIC WORKS  
CIVIL ENGINEERING  
701 W. MARKHAM  
LITTLE ROCK, ARKANSAS 72201

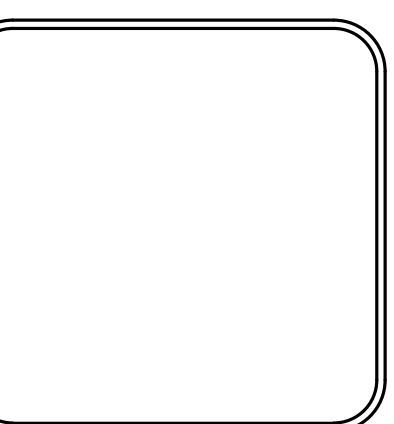

<b>DRAWN BY</b> JP
<b>DESIGNED</b> KP
<b>CHECKED</b> KP
<b>DATE</b> 04.17.24
<b>SCALE</b> 1"=20' H, 1"=5' V
<b>PROJECT NO.</b> CLR 3-22-DR-10
<b>SHEET NO.</b> C4

REVISIONS	DATE

**CITY OF LITTLE ROCK, ARKANSAS**  
**L STREET DRAINAGE IMPROVEMENT**  
**CROSS SECTIONS**

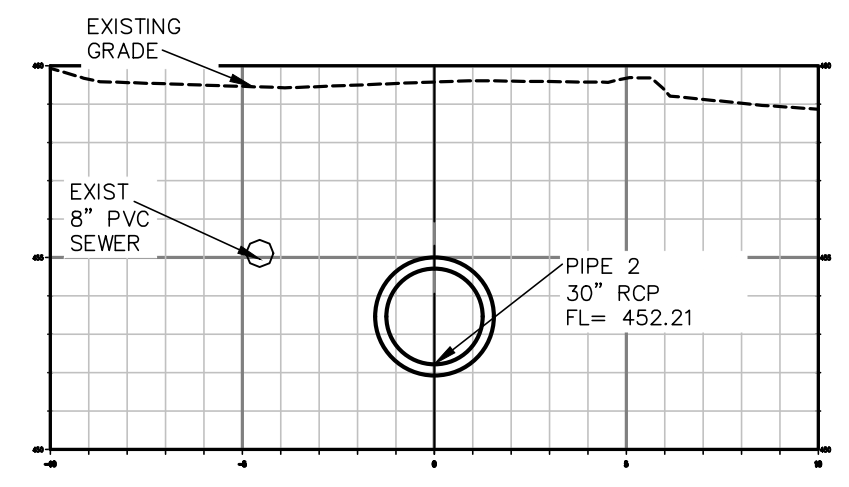

1+00

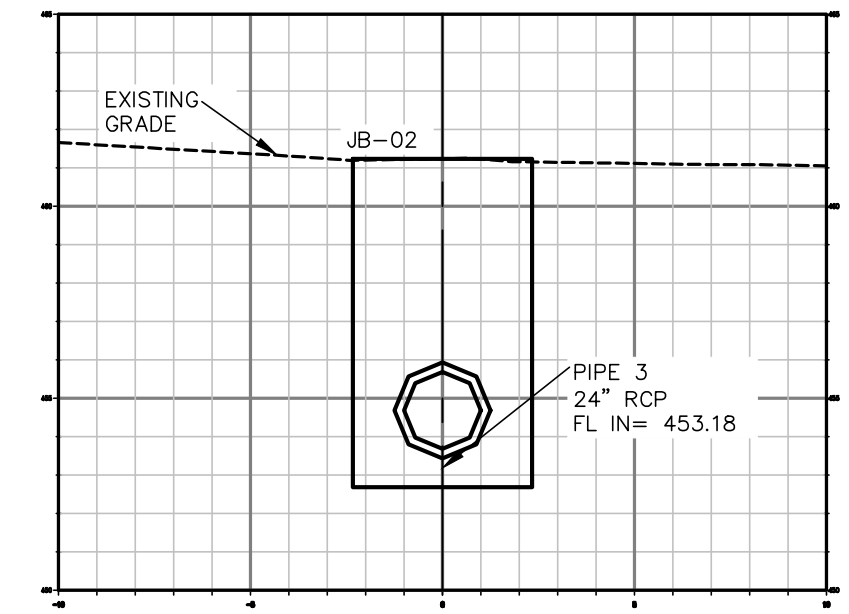

1+58.84

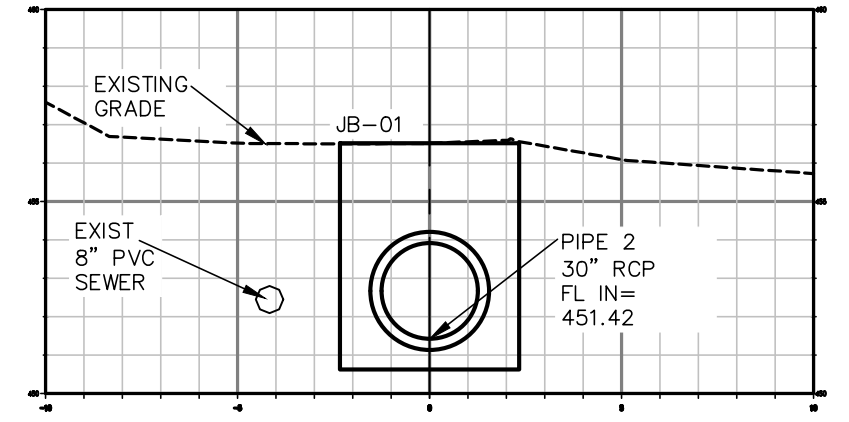

0+51.59

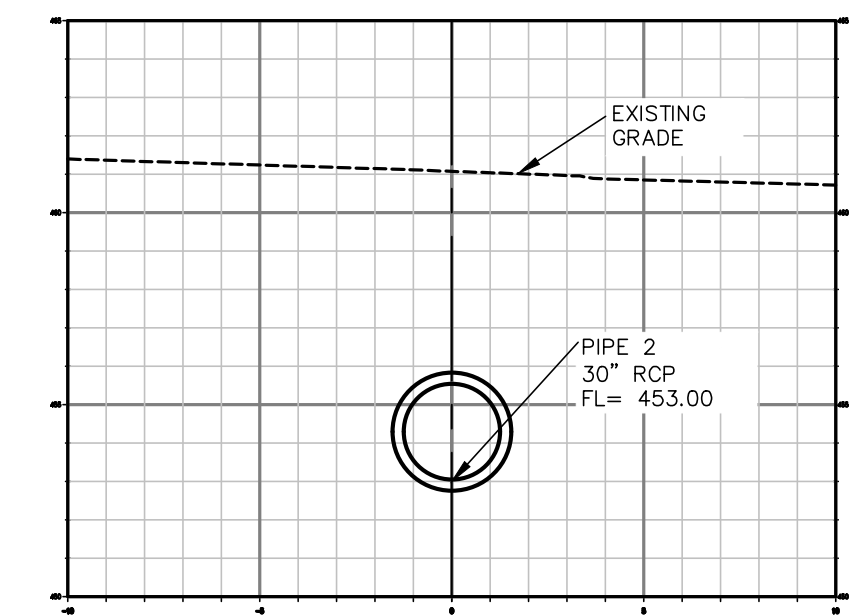

1+50

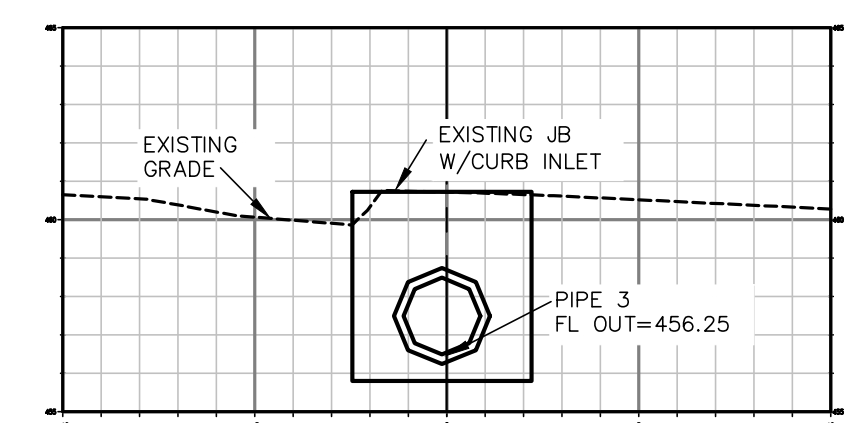

2+16.32

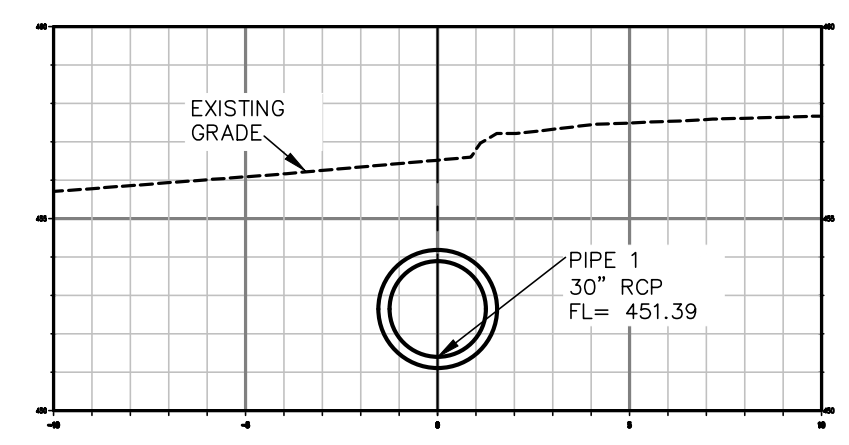

0+50

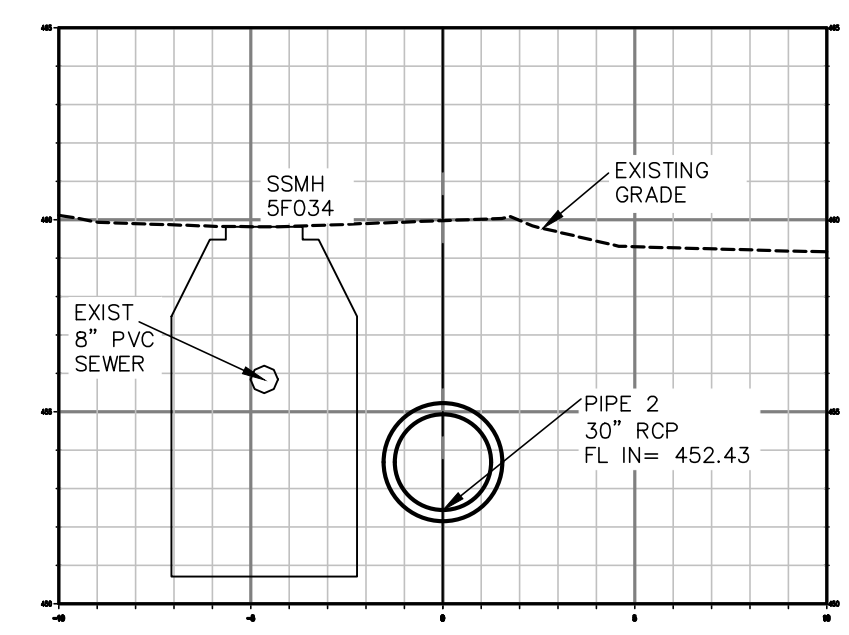

1+13.3

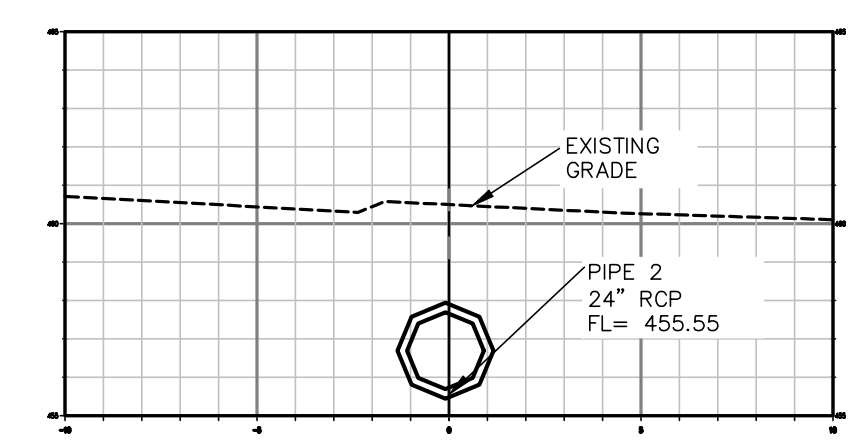

2+00

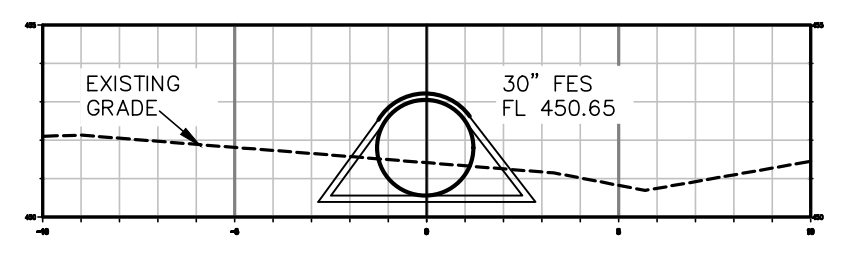

0+00

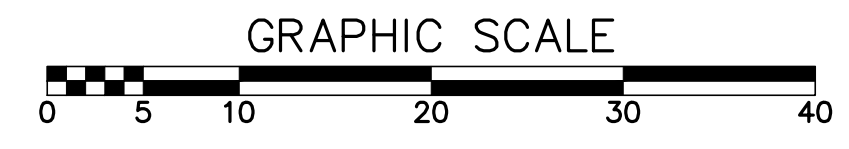
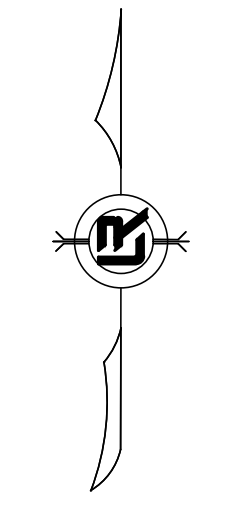

**PRELIMINARY- 90% SUBMITTAL**

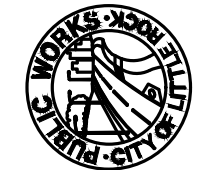
  
 DEPARTMENT OF PUBLIC WORKS  
 CIVIL ENGINEERING  
 701 W. MARKHAM  
 LITTLE ROCK, ARKANSAS 72201

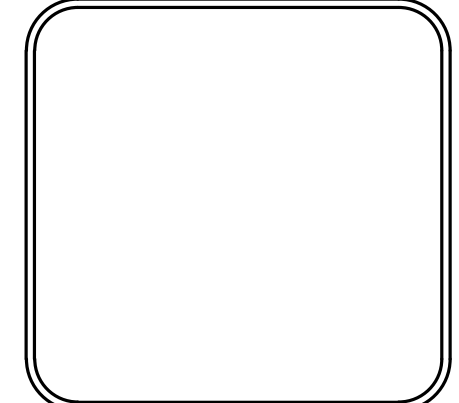

<b>DRAWN BY</b> JJ
<b>DESIGNED</b> KP
<b>CHECKED</b> KP
<b>DATE</b> 04-17-24
<b>SCALE</b> 1"=5'
<b>PROJECT NO.</b> CLR #03-22-DR-10
<b>SHEET NO.</b> C5

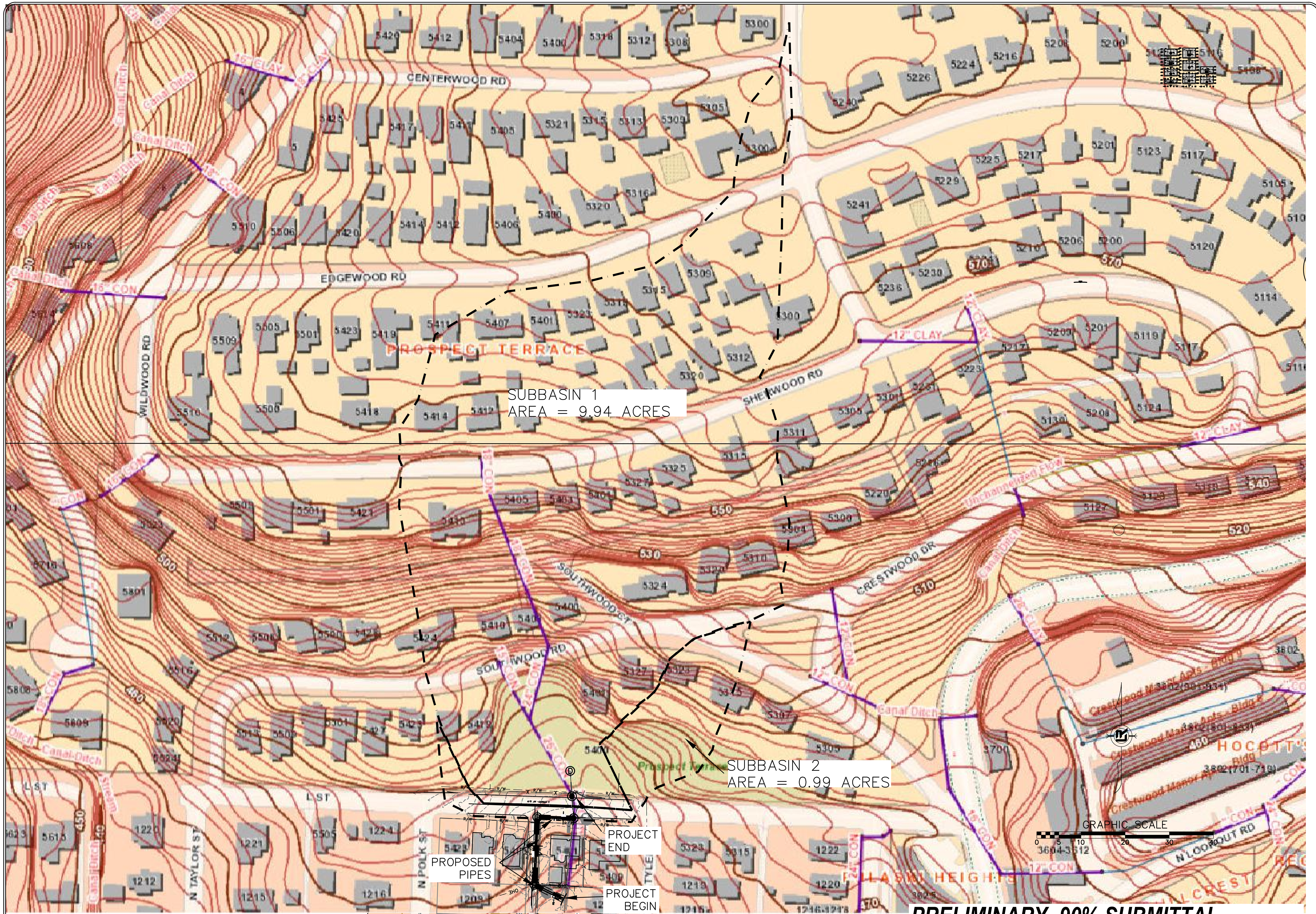

SUBBASIN 1  
AREA = 9.94 ACRES

SUBBASIN 2  
AREA = 0.99 ACRES

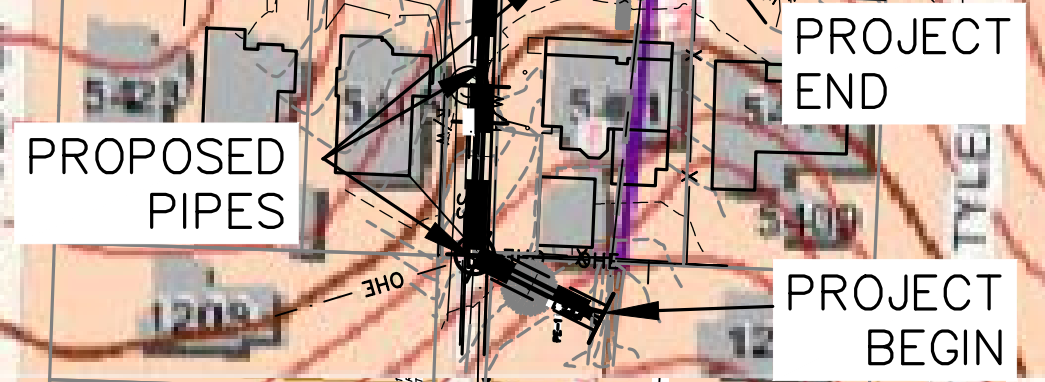

**PRELIMINARY- 90% SUBMITTAL**

REVISIONS	DATE

CITY OF LITTLE ROCK, ARKANSAS  
L STREET DRAINAGE IMPROVEMENT  
DRAINAGE MAP

DEPARTMENT OF PUBLIC WORKS  
CIVIL ENGINEERING  
701 W. MARKHAM  
LITTLE ROCK, ARKANSAS 72201

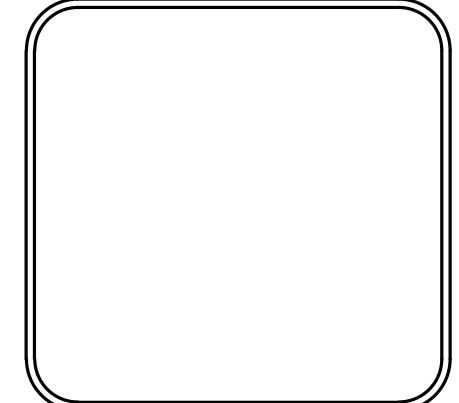

DRAWN BY	KP
DESIGNED	KP
CHECKED	DA
DATE	04-17-24
SCALE	1"=70'
PROJECT NO.	CLR #03-22-DR-10
SHEET NO.	C6

REVISIONS	DATE

**CITY OF LITTLE ROCK, ARKANSAS**  
**L STREET DRAINAGE IMPROVEMENT**  
**EROSION CONTROL PLAN**

DEPARTMENT OF PUBLIC WORKS  
 CIVIL ENGINEERING  
 701 W. MARKHAM  
 LITTLE ROCK, ARKANSAS 72201

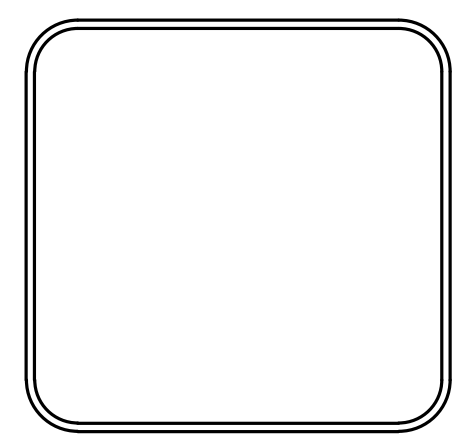

**DRAWN BY**  
 JJ  
**DESIGNED**  
 KP  
**CHECKED**  
 RB  
**DATE**  
 04.17.24  
**SCALE**  
 1"=20' H  
**PROJECT NO.**  
 CLR 3-22-DR-10  
**SHEET NO.**  
 C7

**NOTE:**

UPON IMPLEMENTATION AND INSTALLATION OF THE FOLLOWING AREA: TRAILERS, PARKING, LAY DOWN, PORT-POTTY, WHEEL WASH, CONCRETE WASHOUT, FUEL AND MATERIAL STORAGE CONTAINERS, SOLID WASTE CONTAINERS, ETC.; IMMEDIATELY DENOTE THEM ON THE SITE MAPS AND NOTE ANY CHANGES IN LOCATION AS THEY OCCUR THROUGHOUT THE CONSTRUCTION PROCESS. IN ADDITION, NOTE ANY OFF-SITE AREA WHERE FILL IS IMPORTED FROM OR SOIL IS EXPORTED TO ON THE SITE MAPS.

**PHASE 1**

1. INSTALL STABILIZED CONSTRUCTION ENTRANCE/EXIT(S) AND SWPPP INFORMATION SIGN.
2. INSTALL, SILT FENCE(S) ON THE SITE. CLEAR ONLY THOSE AREAS NECESSARY TO INSTALL SILT FENCE.
3. PREPARE TEMPORARY PARKING AND STORAGE AREA.
4. HALT ALL ACTIVITIES AND CONTACT THE CITY OF LITTLE ROCK TO PERFORM INSPECTION AND ACCEPTANCE OF BMP'S.
5. CONSTRUCT AND STABILIZE SEDIMENT BASIN(S) AND SEDIMENT TRAP(S) WITH APPROPRIATE OUTFALL STRUCTURES. CLEAR ONLY THOSE AREAS NECESSARY TO INSTALL BASINS AND TRAPS.
6. INSTALL AND STABILIZE HYDRAULIC CONTROL STRUCTURES (DIKES, SWALES, CHECK DAMS, ETC.). CLEAR ONLY THOSE AREAS NECESSARY TO INSTALL HYDRAULIC CONTROL DEVICES.

**PHASE 2**

1. BEGIN SITE DEMOLITION, CLEARING AND GRUBBING.
2. CONTINUE GRADING THE SITE.
3. INSTALL UTILITIES, UNDERDRAINS, STORM SEWERS, CURBS AND GUTTERS.
4. INSTALL APPROPRIATE INLET PROTECTION DEVICES FOR PAVED AREAS AS WORK PROGRESSES.

**PHASE 3**

1. CONTINUE GRADING THE SITE.
2. PREPARE SITE FOR PAVING.
3. PAVE THE SITE.
4. INSTALL APPROPRIATE INLET PROTECTION DEVICES FOR PAVED AREAS AS WORK PROGRESSES.
5. COMPLETE GRADING AND INSTALLATION OF PERMANENT STABILIZATION OVER ALL AREAS.

**BEST MANAGEMENT PRACTICES:**

UPON IMPLEMENTATION AND INSTALLATION OF THE FOLLOWING AREA: TRAILERS, PARKING, LAY DOWN, PORT-POTTY, WHEEL WASH, CONCRETE WASHOUT, FUEL AND MATERIAL STORAGE CONTAINERS, SOLID WASTE CONTAINERS, ETC.; IMMEDIATELY DENOTE THEM ON THE SITE MAPS AND NOTE ANY CHANGES IN LOCATION AS THEY OCCUR THROUGHOUT THE CONSTRUCTION PROCESS. IN ADDITION, NOTE ANY OFF-SITE AREA WHERE FILL IS IMPORTED FROM OR SOIL IS EXPORTED TO ON THE SITE MAPS.

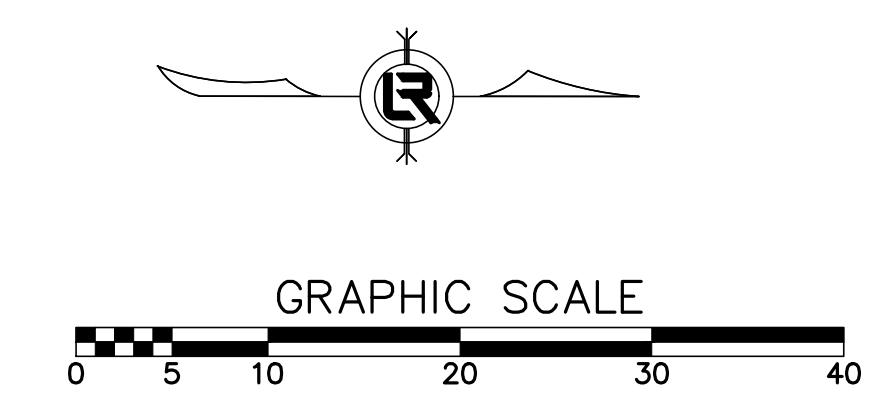
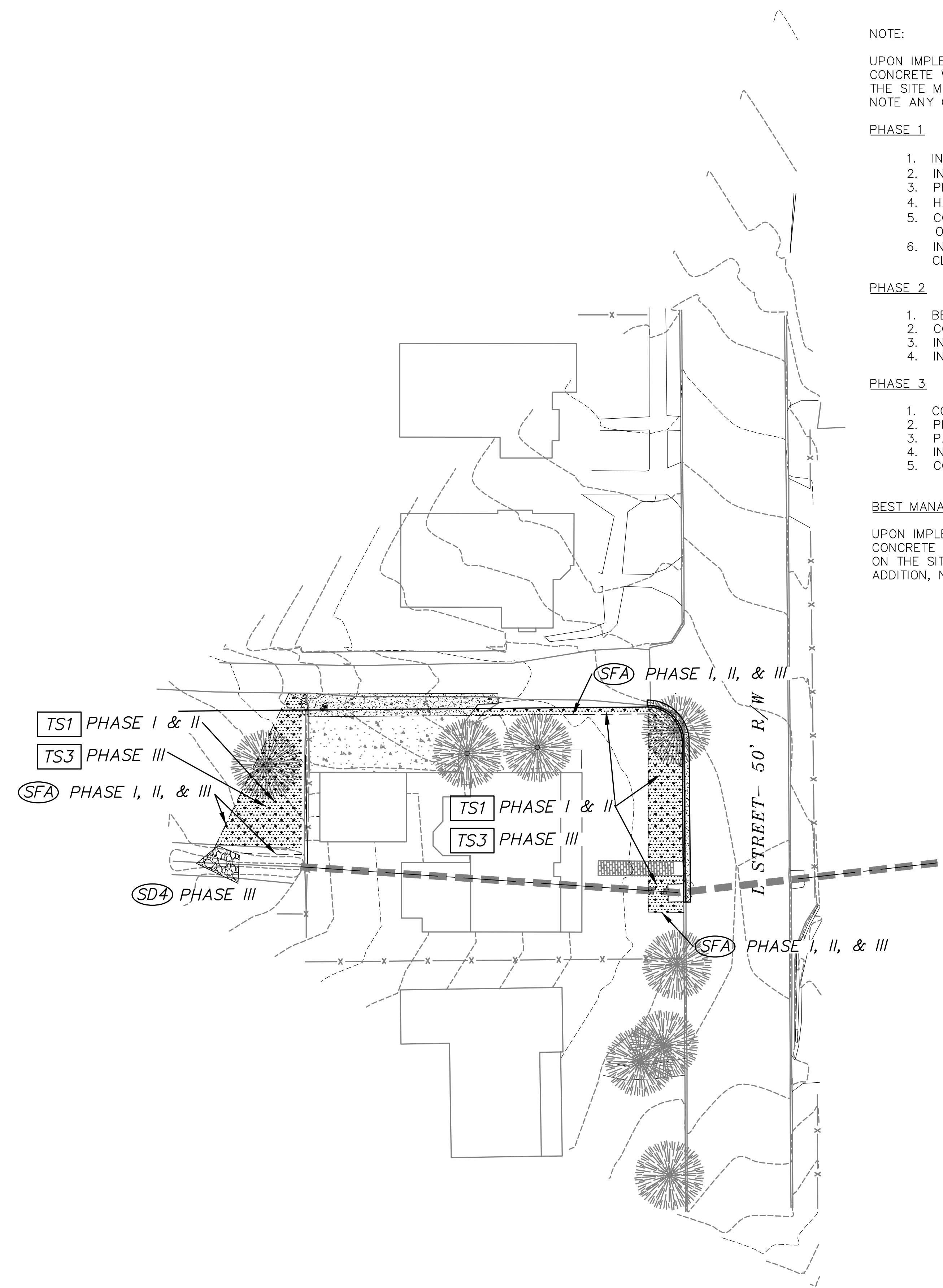

**KEY:**  
 = TS1 TEMPORARY STABILIZATION  
 = TS3 PERMANENT GRASSING

**PRELIMINARY- 90% SUBMITTAL**